



**TECHNICAL PROPOSAL FOR  
FIXED ACCESS  
AT  
UMT KUALA NERUS (2<sup>nd</sup> ROUTE)**

**TABLE OF CONTENTS:**

<b>1.0 TP CHECKLIST.....</b>	<b>3</b>
<b>2.0 GENERAL INFORMATION.....</b>	<b>4</b>
<b>3.0 PROPOSAL FOR FIXED NETWORK ACCESS.....</b>	<b>6</b>
<b>3.1 Introduction.....</b>	<b>6</b>
<b>3.2 External and Internal Trenching.....</b>	<b>6</b>
<b>3.3 Equipment Foot Space &amp; Weight.....</b>	<b>7</b>
<b>3.4 Location Map.....</b>	<b>8</b>
<b>4.0 APPENDIX.....</b>	<b>9</b>
<b>4.1 Product Portfolio.....</b>	<b>9</b>
<b>4.2 Drawing.....</b>	<b>10</b>
<b>4.2.1 Drawing – Site Plan.....</b>	<b>10</b>
<b>4.2.2 Drawing – Schematic.....</b>	<b>12</b>
<b>4.2.3 Drawing – Layout Plan.....</b>	<b>13</b>
<b>4.3 Site Photos.....</b>	<b>14</b>
<b>4.3.1 Outside Plant Photos.....</b>	<b>14</b>
<b>4.3.2 Inside Plant Photos.....</b>	<b>24</b>
<b>4.3.3 Tdc existing Manhole and Building existing Manhole.....</b>	<b>25</b>
<b>4.4 Survey Acknowledgement Form.....</b>	<b>26</b>

# 1.0 TP CHECKLIST



Building Name : UMT Kuala Nerus				
Date of LOI : -				
Date of Survey : 23/10/2024				
	DESCRIPTION	YES	NO	REMARKS
1	TDC existing manhole coordinate		✓	Existing mh TIME (5.348032, 103.082312)
2	Existing building manhole coordinate	✓		Building Mh 01-26
3	Any Gas pipe signage seen at site? If YES, attach Photo		✓	
4	Any TNB signage seen at site? If YES, attach Photo		✓	
5	Any crossing drainage? If YES, attach photo & width of the drainage		✓	
6	Any INDAH WATER manhole seen at site? If YES, attach Photo		✓	
7	Any crossing traffic light? If YES, attach photo & measurement of the traffic light box		✓	
8	Has identified Local Authority? Kindly indicate.	✓		JKR,MPK,SATU,T M
9	Drawing for outside plant (OSP) survey - Building Access & civil work up to last TIME manhole (dwg format - autocad & .pdf format) *	✓		
10	Drawing for inside plant (ISP) survey - MDF up to riser (.dwg format - AutoCAD & .pdf format) *	✓		
11	Prepare the complete 1 copy of Technical Proposal (.pdf format & Word Format) –of softcopy – 1 copy	✓		
12	Bill of Quantity for civil, fibre pulling, splicing & termination	✓		
13	The latitude & longitude of the building location, last TIME manhole and building manhole in 6 decimal points (xx.xxxxxx, x.xxxxxx) in TP Location Map	✓		
14	Open up the manhole at any spot of joint/ring cut & provide duct space record for this project (photo required). Please make sure that there is TIME cable in the manhole (photo required). <b>If unable to open up the manhole, photo of manhole surrounding is required.</b>		✓	
15	Survey Acknowledgment Form signed & attached	✓		
16	Others		✓	

**2.0 GENERAL INFORMATION****General Information**

Building Name : UMT Kuala Nerus

Full Address:

Type of Development: Customer

No of Unit: 1

No of Storey per Block: N/A

No of Blocks per Dev : N/A

**Contact Person****Management**

Name: En. Rahman H/P 0139232171

Designation: - Tel NA

Email Address:

**Maintenance / Security  
Department**

Name: Designation: Email NA H/P Tel NA

Address: NA NA

-

**Comments****For TimeDotComBhd Use Only**

Remarks

Prepared by : TWIN HI-TECHNOLOGIES SDN BHD

***Date of LOI :*** -

Date of Survey : 23/10/2024

Surveyed by : Ahmad Azriq

Drawing Prepared by : Ahmad Syarikin

Eng. Person In charge :

**Telecommunication Information**

**MDF/SDF Room Description**

Number of MDF/SDF Room : 1 SDF Room, 1 CR Room (Level G)  
 Location of Equipment Room : CR Room (Level G)  
 Number of E – Side : 1 x 48C  
 Number of Pairs Terminated : 12C  
 Number of Splitter Installed : NA  
 Location of Splitter : NA  
 Number of D-Side : 1 X 12C  
 Number of Active Pairs : NA  
 Fiber of Termination Box Type : FTB 12C Wall Mount  
 Power : Yes  
 Method of Access to Building : Existing  
 Method of Exit to Riser : Existing

Longitude : 4.7657  
 Latitude : 103.4186

<b>Construction Details:</b>			
No	Descriptions	Method	Distance(m)
1	Civil	1W HDD	11670
		1W NT	1730
	Others (Please specify)		
2	Fiber Pulling *( from FDF to Time last manhole)	48C	15075

**Comment :**

For Contractor Use Only :

For Client Use Only :

## **1. PROPOSAL FOR FIXED ACCESS**

### 2. Introduction

1.TIME dot Com offers a wide variety of fixed-line telecommunications services. As part of our commitment to provide our customers with the best possible solutions to serve all their communications needs; we aim to enhance telecommunication services in your building to offer your tenants with High Speed Internet, Data and Voice connectivity. Your premises will be enhanced today for tomorrow's communication and IT requirements. With that, we provide a choice of Service Providers to your tenants and your building gains a future-proof communication infrastructure.

2. A physical infrastructure link to the building is the main access to deliver services to the tenants. The typical link required is through fiber optic cable.

3. In order to support the services, TIME dot Com require an access to the propose MDF room and Server room in order to provide services to the end user

4. To be able to deliver these services to your building, we will pull our own fiber optic cables from our nearest hub and place our passive access equipment into building server room. (Optional in this proposal)

5. With this setup we will have TIME dot Com connection right up to each block of the building.

### 3. External and Internal Trenching

1. The propose route will start from the existing Time Mh to Building Mh using new ducting. The propose route then continue to MDF Room/SDF Room/Server Room using existing route.

2. TdC will utilize existing building access ducting and existing cable tray / trunking to common CR room.

3. The permission to trench inside local authority jurisdiction to be applied separately if necessary.

4. This proposal is based on assumption that there is fiber cable to be connected in the existing TIME manhole.

### 3. Equipment Foot Space & Weight

- Below is the TIME dot com' standard requirement that will be installed at common MDF Room/SDF Room/Server Room.

Description	Remarks
1 X FTB 12C (Rack Mount)	At SDF Room At Level G
1 X TDC IMC (Rack Mount)	At UMT Existing Cabinet At CR Room At Level G

- 1.3.2 However depending on the network requirement, Time dot Com may or may not add additional network equipment(s) in the MDF room or the vertical riser as it may apply.

### 3.4 Location Map



## UMT KUALA NERUS (2<sup>ND</sup> ROUTE), TERENGGANU

Lat: 5.406601°  
Long: 103.088035°

**1. APPENDIX**  
**2. Product Portfolio**

**TIME DOT COM CONNECTIONS FOR COMMERCIAL**

<p><b>Private Data Network</b></p>	<p>Our Virtual Private Network (VPN) is designed to deliver you an efficient, secured and reliable service. We provide point-to-point technology that directly connects you to your clients and employees. We ensure complete privacy and security, while at the same time, maximizing your speed and bandwidth;</p> <ul style="list-style-type: none"> <li>⇒ Channelized Leased Circuit</li> <li>⇒ Ethernet Leased Circuit</li> <li>⇒ International Private Leased</li> <li>⇒ Circuit (IPLC)</li> <li>⇒ Metro LAN</li> <li>⇒ International Ethernet Private Leased Circuit (IEPLC)</li> </ul>
<p><b>Internet</b></p>	<p>TIME Internet services allow you to connect to the world speedily with high scalability, reliability and security. Choose the best solution that suits your need and TIME will take care of the rest;</p> <ul style="list-style-type: none"> <li>⇒ Channelized Direct</li> <li>⇒ Ethernet Direct</li> <li>⇒ Business Broadband</li> <li>⇒ Satellite Broadband</li> <li>⇒ Home Broadband</li> </ul>
<p><b>Voice</b></p>	<p>We've got a wide range of services from basic phone line with crystal clear voice quality to our account based postpaid Virtual Call service. We also provide local and International toll free services, and even business or individual calling cards. With TIME, it's so easy to stay in touch;</p> <ul style="list-style-type: none"> <li>⇒ Business Voice Line</li> <li>⇒ ISDN PRI</li> <li>⇒ International Toll Free</li> <li>⇒ Toll Free 1300</li> <li>⇒ Toll Free 1800</li> <li>⇒ Audio Conferencing</li> <li>⇒ Home Fixed Line</li> </ul>
<p><b>Managed Services</b></p>	<p>TIME Managed Services deliver end-to-end networking solutions. Focus on your productivity while we provide you with support possible to take your business to the next level;</p> <ul style="list-style-type: none"> <li>⇒ IPVPN</li> <li>⇒ SAN Extension</li> </ul>
<p><b>Wholesale Service</b></p>	<p>We are able to offer you unmatched capacity and network resiliency. We aim to ensure seamless connectivity and high availability, thus maximizing your operational capabilities;</p> <ul style="list-style-type: none"> <li>⇒ Wholesale bandwidth</li> <li>⇒ Wholesale Voice (Transit Premium, Transit CLR)</li> <li>⇒ Cross Peninsular Cable System (CPCS)</li> </ul>



4.2.4 Drawing – Layout Plan Drawing

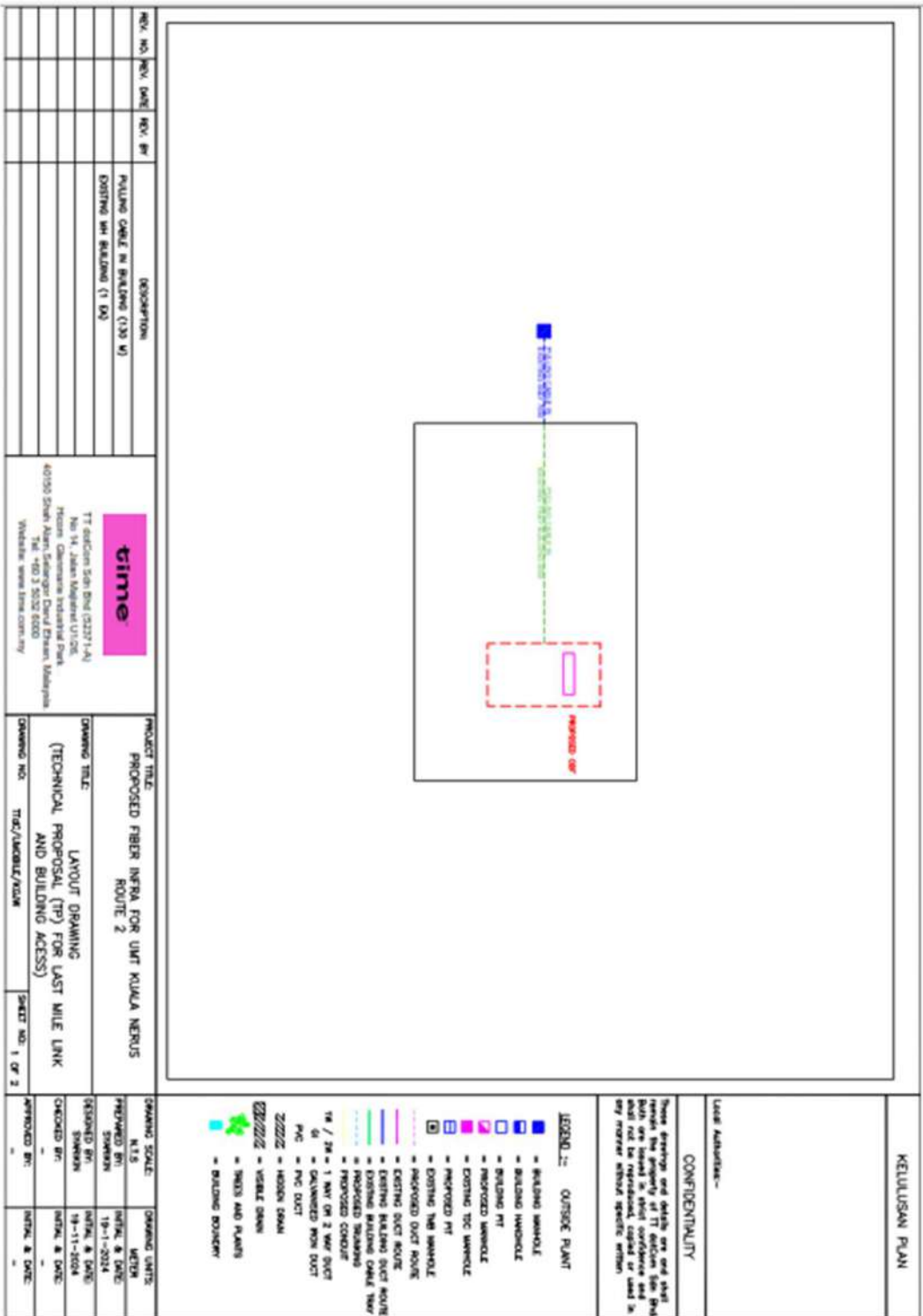

3. Site Photos

1. Outside Plant Photos



Propose route across Jalan Iman



Propose route across Jalan Iman - HDD method

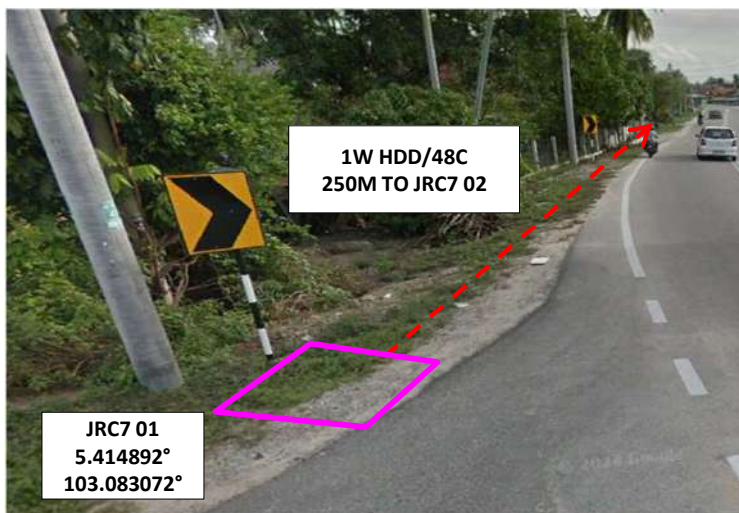

Propose route across Jalan T15 - HDD method



Propose route across Jalan T15 - HDD method

3. Site Photos

1. Outside Plant Photos



Propose route across Jalan T15 - HDD method



Propose route across Jalan T15 - HDD method



Propose route across Jalan Tengku Ampuan Intan Zaharah - HDD method

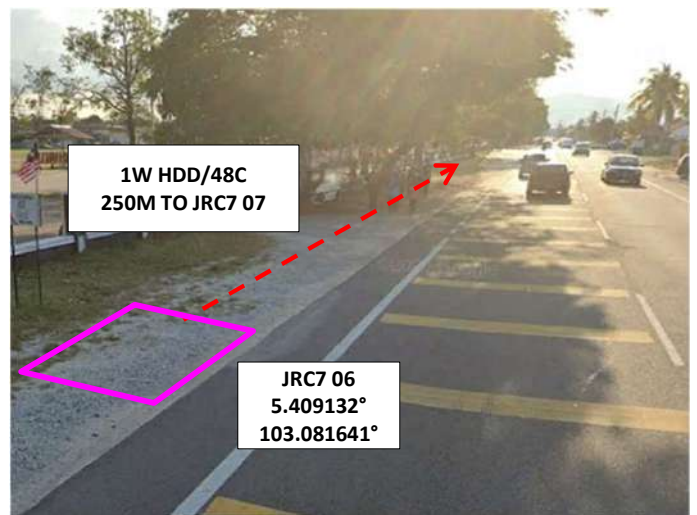

Propose route across Jalan Tengku Ampuan Intan Zaharah - HDD method

3. Site Photos

1. Outside Plant Photos

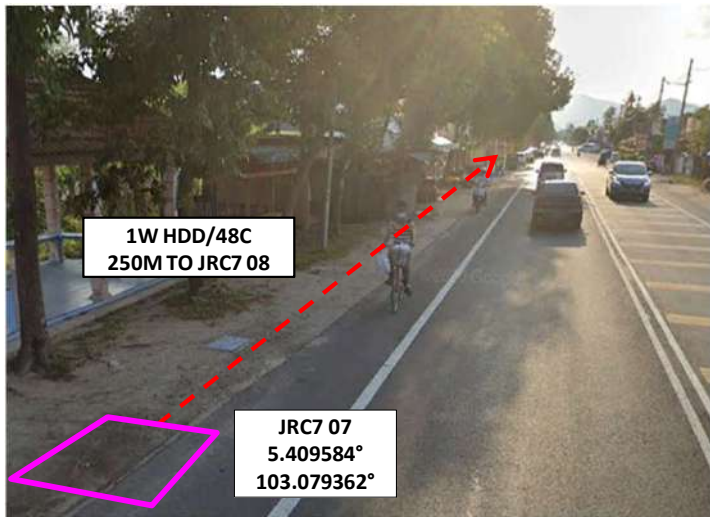

Propose route across Jalan Tengku Ampuan Intan Zaharah - HDD method



Propose route across Jalan Tengku Ampuan Intan Zaharah - HDD method

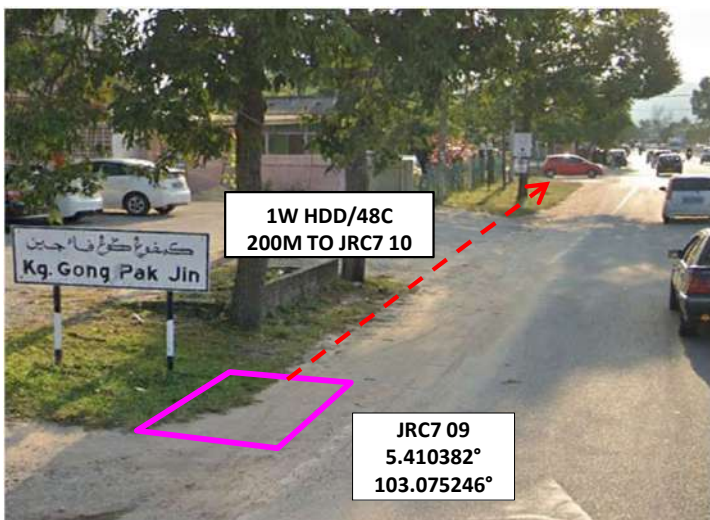

Propose route across Jalan Tengku Ampuan Intan Zaharah - HDD method

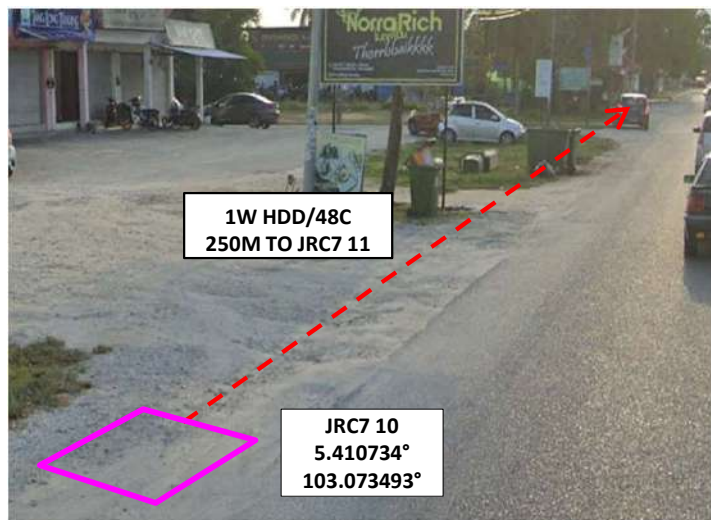

Propose route across Jalan Tengku Ampuan Intan Zaharah - HDD method



Propose route across Jalan Tengku Ampuan Intan Zaharah - HDD method

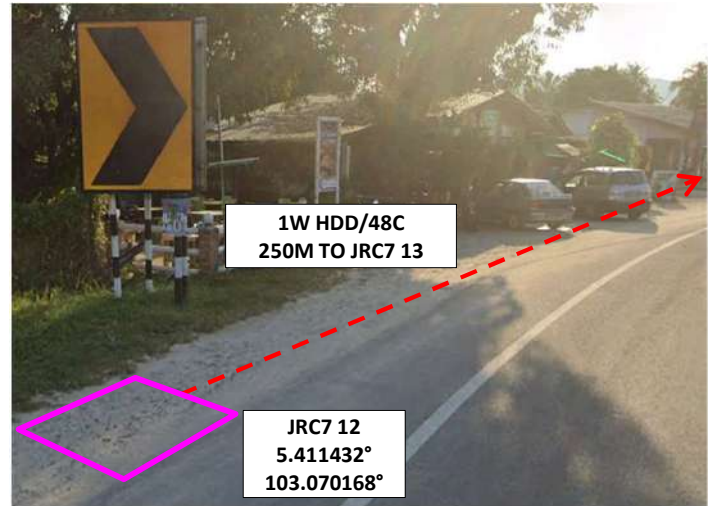

Propose route across Jalan Tengku Ampuan Intan Zaharah - HDD method



Propose route across Jalan Tengku Ampuan Intan Zaharah - HDD method



Propose route across Jalan Tengku Ampuan Intan Zaharah - HDD method

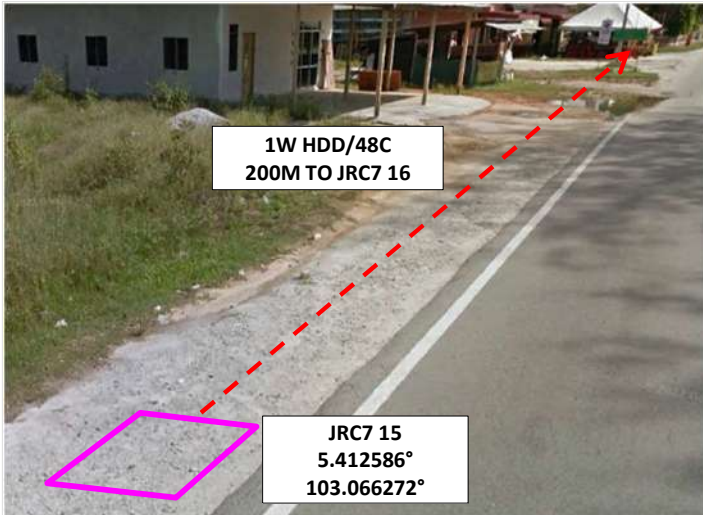

Propose route across Jalan Kubur Shariff - HDD method



Propose route across Jalan Kubur Shariff - HDD method



Propose route across Jalan Kubur Shariff - HDD method

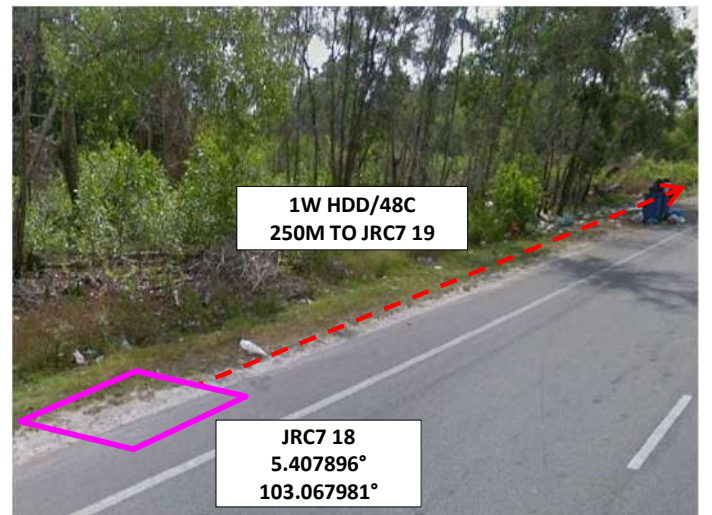

Propose route across Jalan Kubur Shariff - HDD method



Propose route across Jalan Kubur Shariff - HDD method

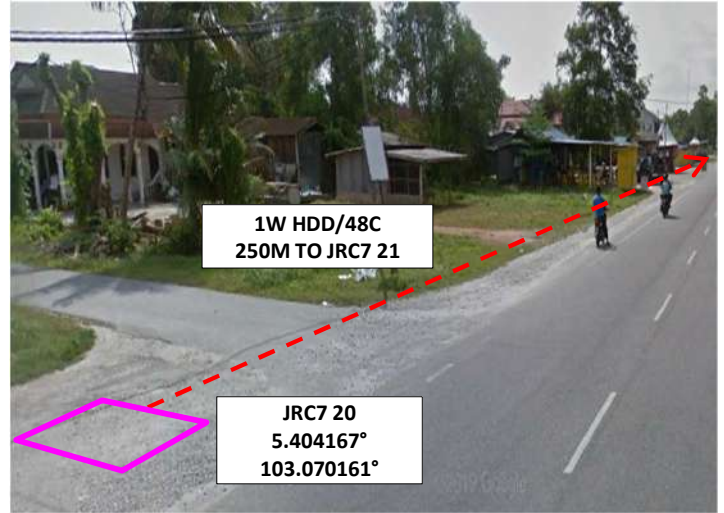

Propose route across Jalan Kubur Shariff - HDD method



Propose route across Jalan Kubur Shariff - HDD method



Propose route across Jalan Kubur Shariff - HDD method



Propose route across Jalan Kubur Shariff - HDD method

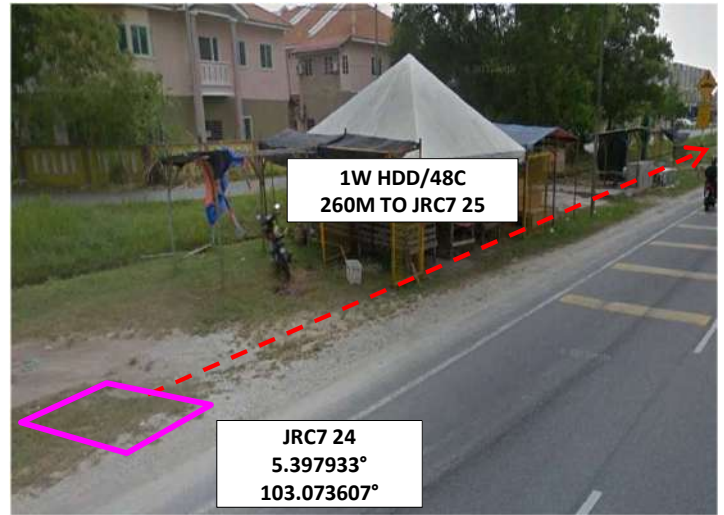

Propose route across Jalan Kubur Shariff - HDD method

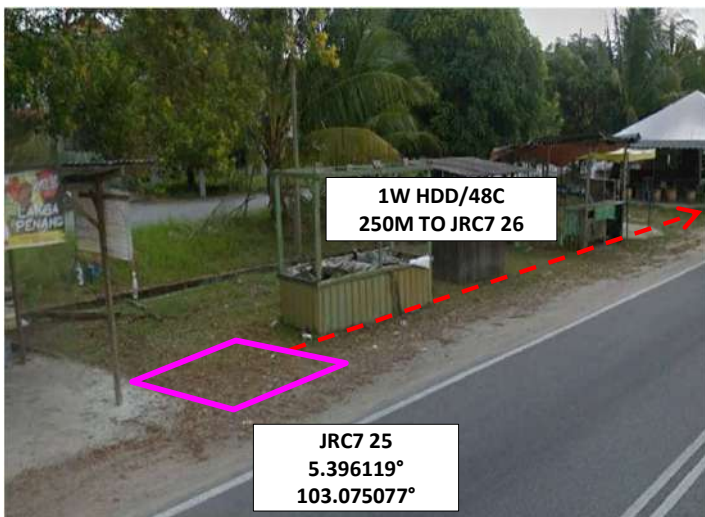

Propose route across Jalan Kubur Shariff - HDD method

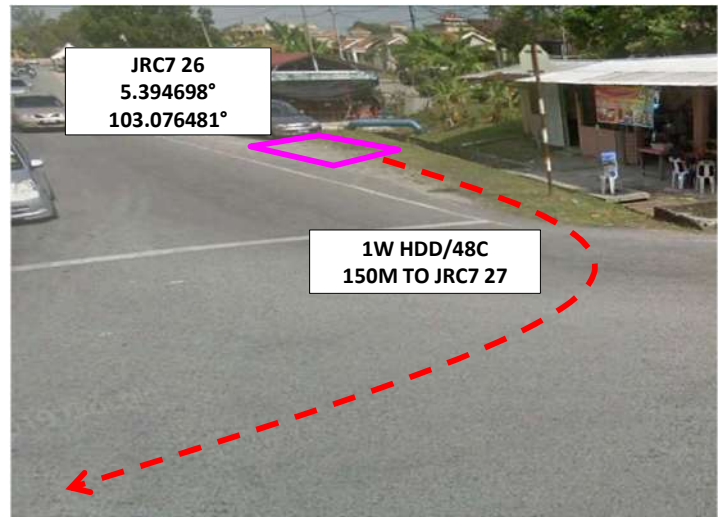

Propose route across Jalan Kubur Shariff - HDD method

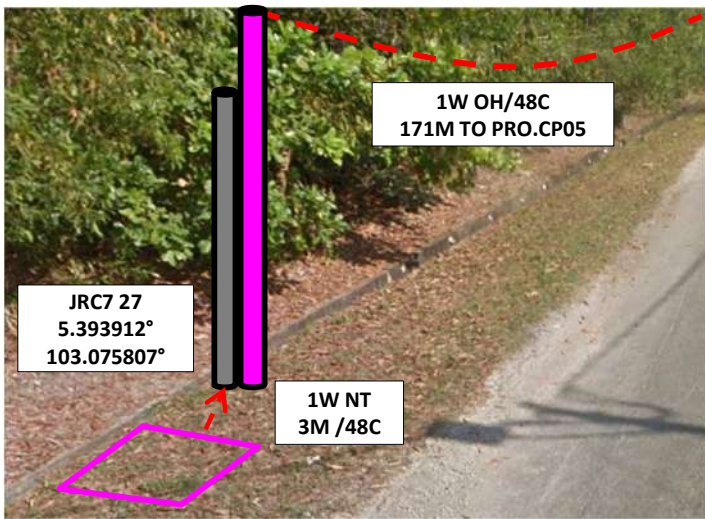

Propose route across Jalan Kuala Terengganu - OH method

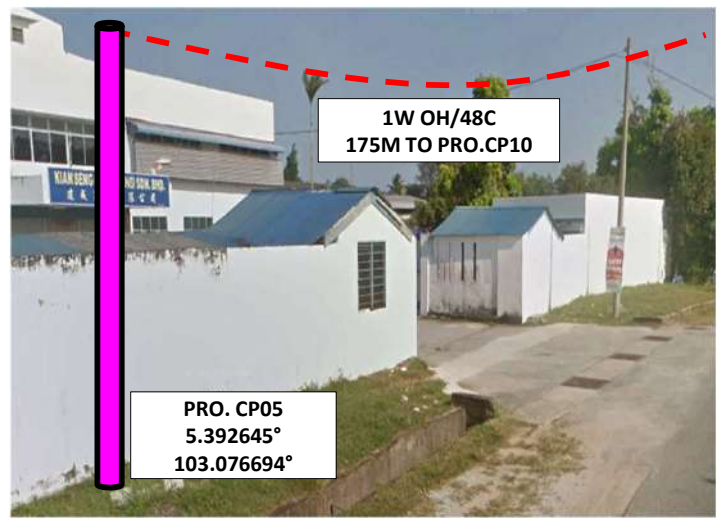

Propose route across Jalan Kuala Terengganu - OH method

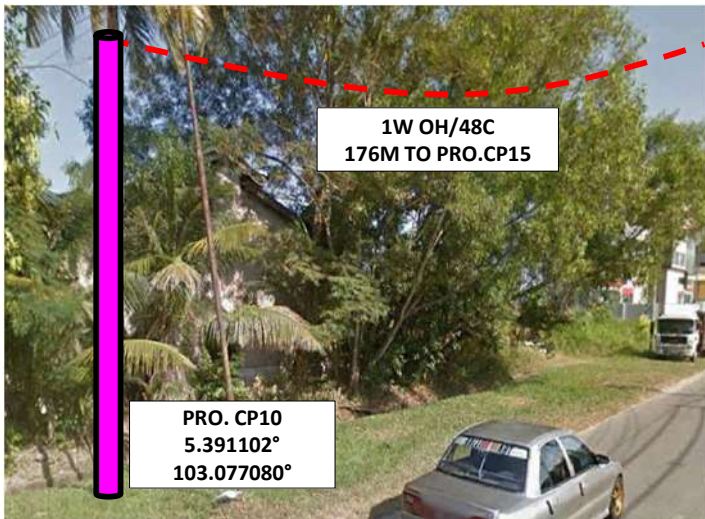

Propose route across Jalan Kuala Terengganu - OH method



Propose route across Jalan Kuala Terengganu - OH method

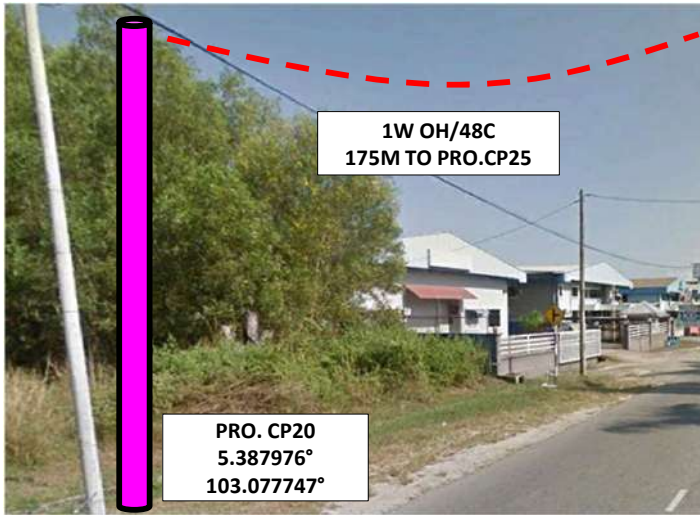

Propose route across Jalan Kuala Terengganu - OH method

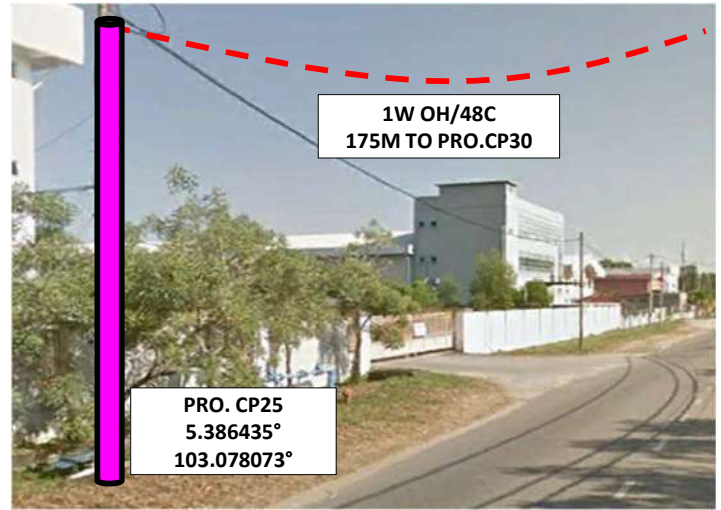

Propose route across Jalan Kuala Terengganu - OH method

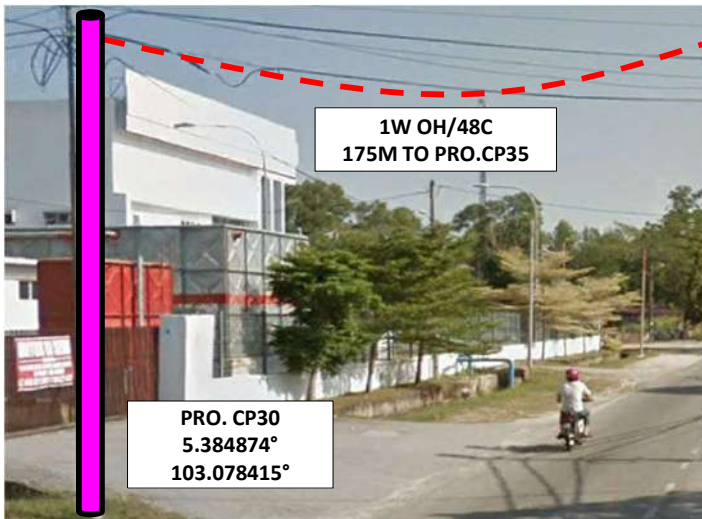

Propose route across Jalan Kuala Terengganu - OH method

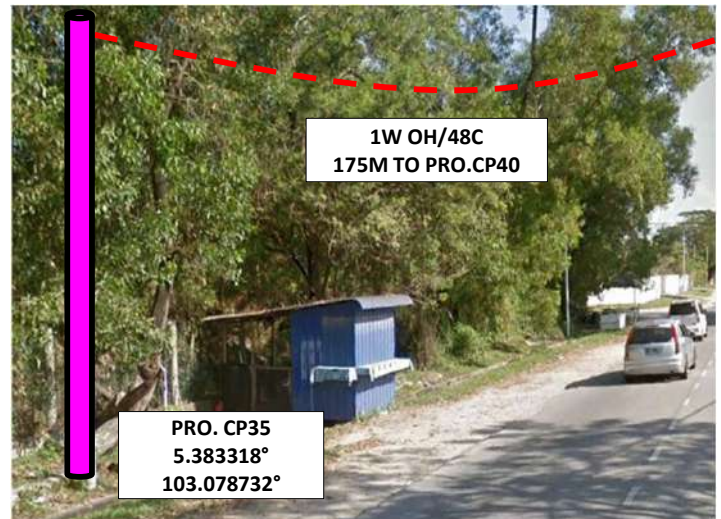

Propose route across Jalan Kuala Terengganu - OH method

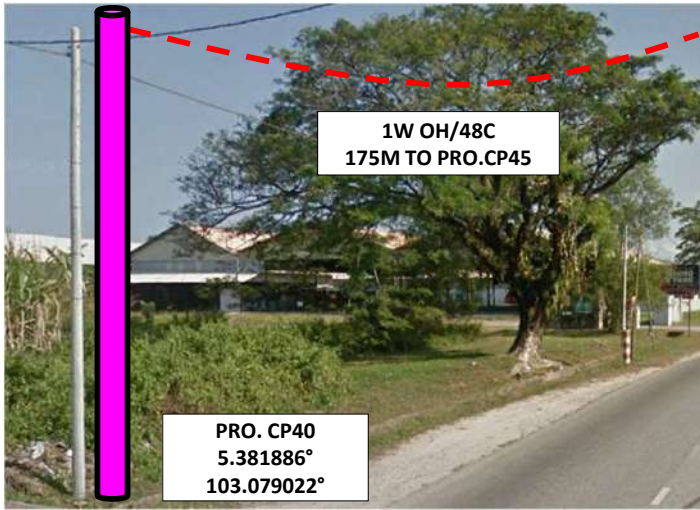

Propose route across Jalan Kuala Terengganu - OH method

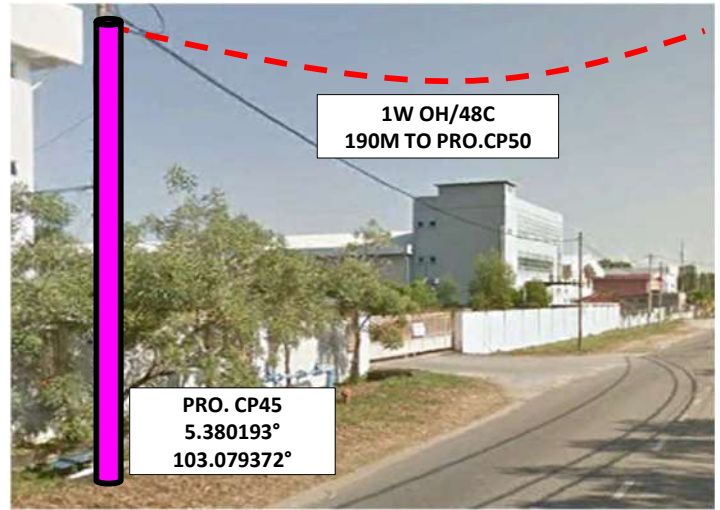

Propose route across Jalan Kuala Terengganu - OH method



Propose route across Jalan Kuala Terengganu - OH method

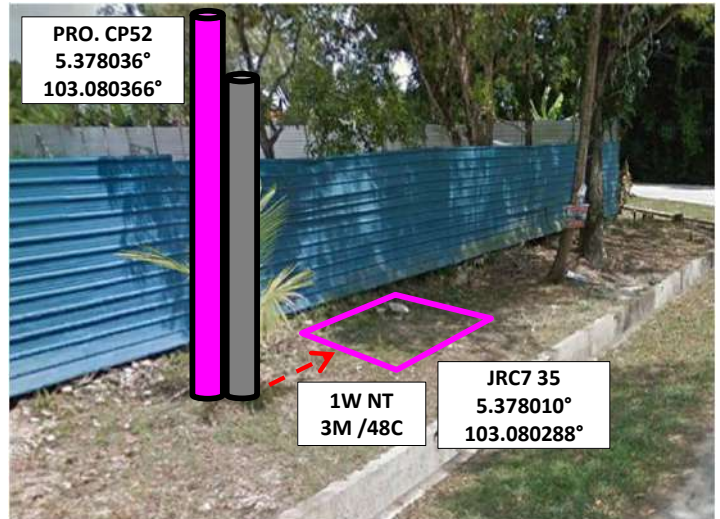

Propose route across Jalan Kuala Terengganu - OH method

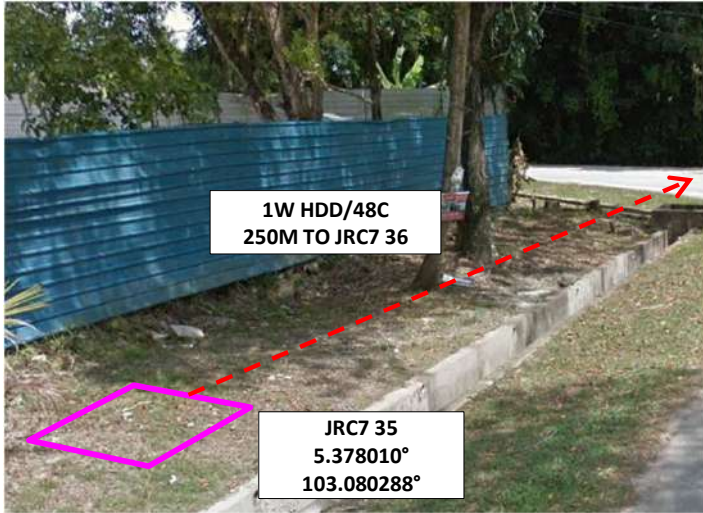

Propose route across Jalan Kuala Terengganu - HDD method



Propose route across Jalan Kuala Terengganu - HDD method

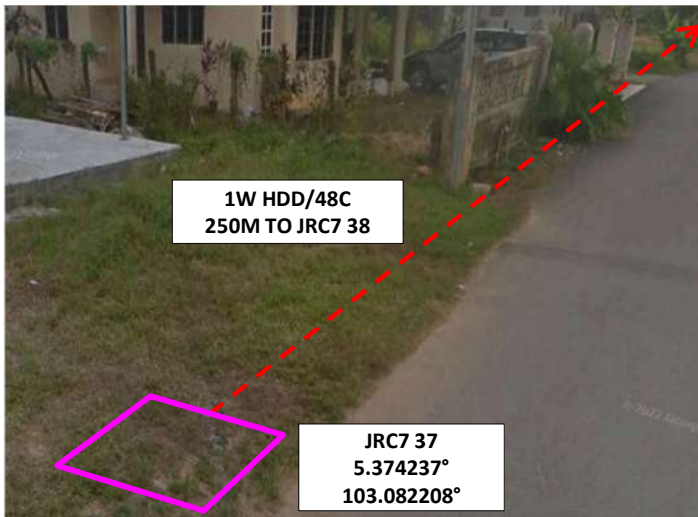

Propose route across Jalan Kuala Terengganu - HDD method

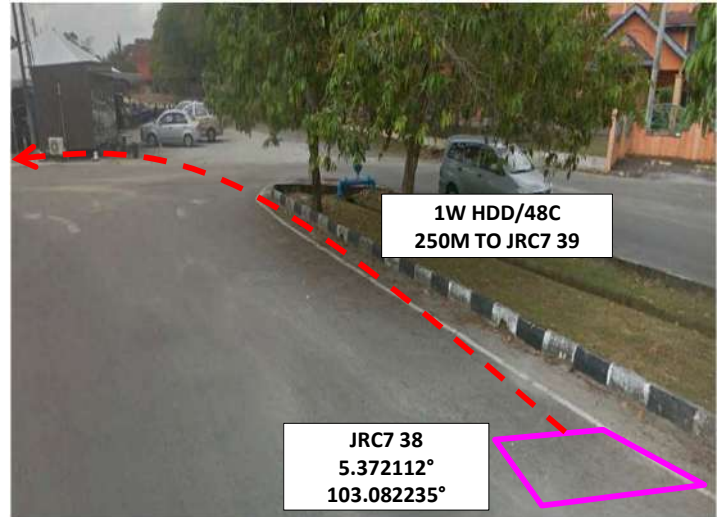

Propose route across Jalan Kuala Terengganu - HDD method

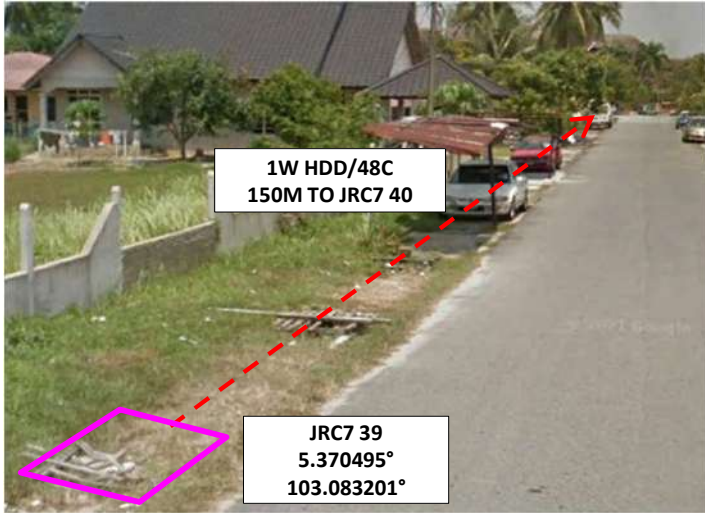

Propose route across Jalan Kuala Terengganu - HDD method



Propose route across Jalan Kuala Terengganu - HDD method

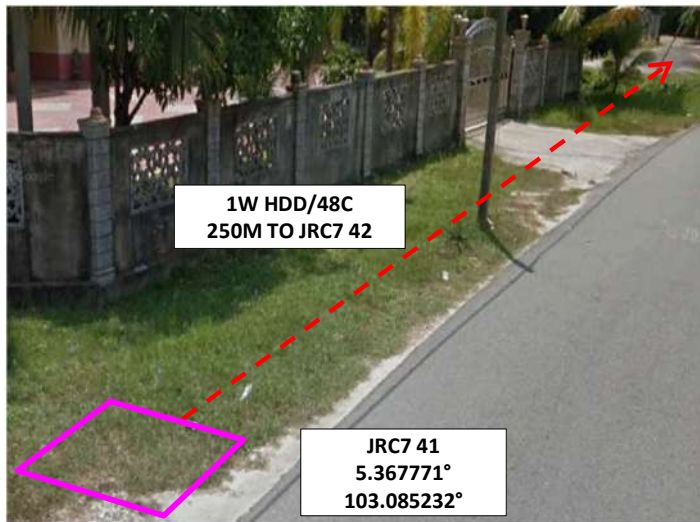

Propose route across Jalan Kuala Terengganu - HDD method

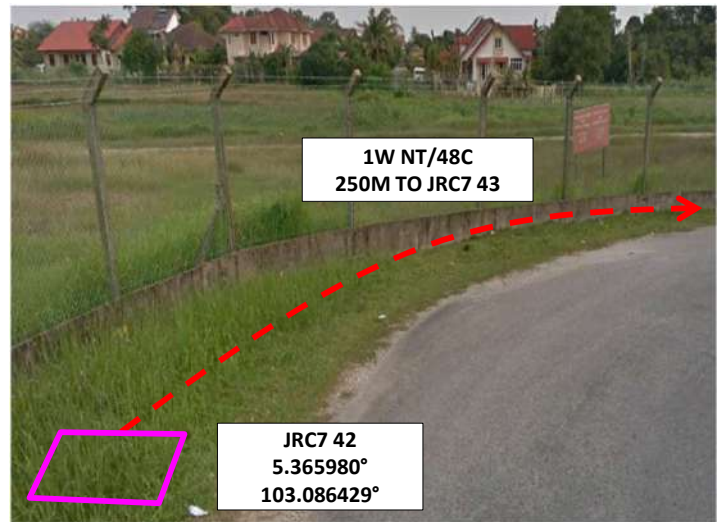

Propose route across Jalan Kuala Terengganu - NT method

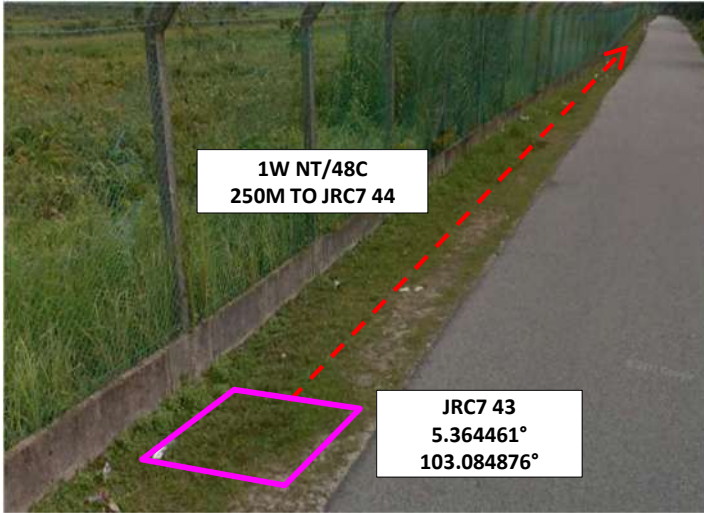

Propose route across Jalan Kuala Terengganu - NT method

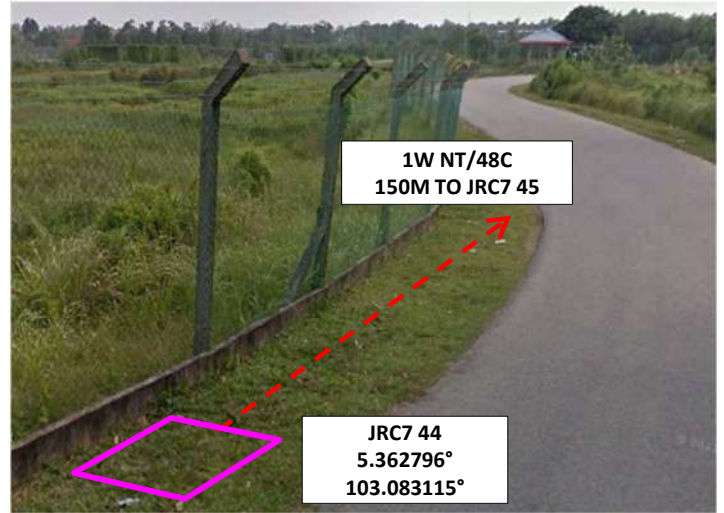

Propose route across Jalan Kuala Terengganu - NT method

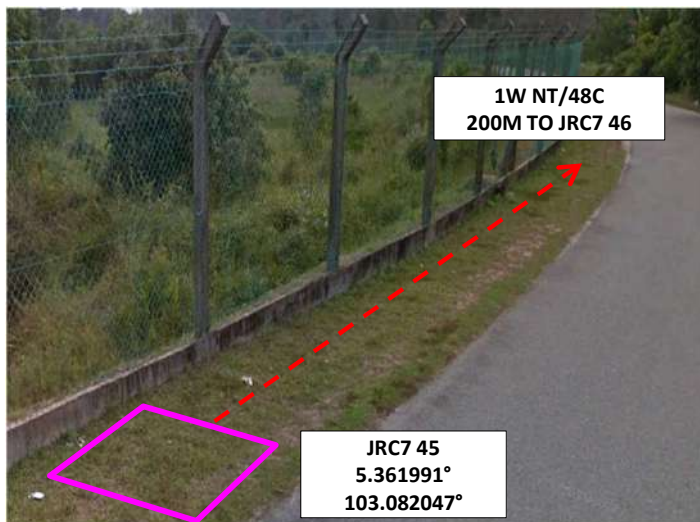

Propose route across Jalan Kuala Terengganu - NT method

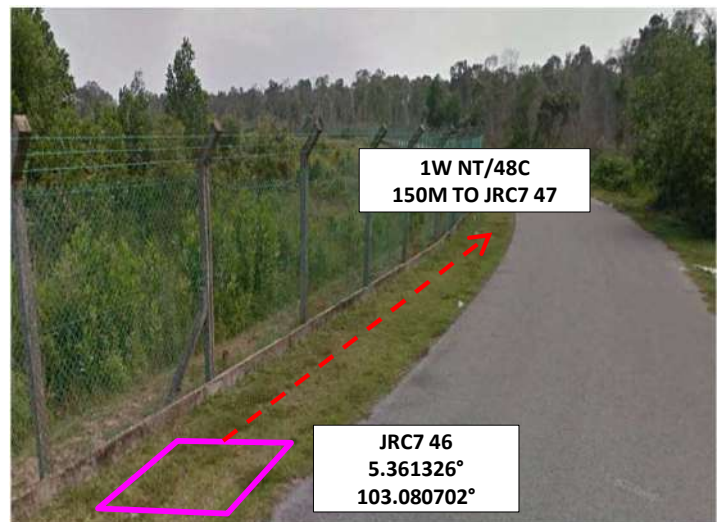

Propose route across Jalan Kuala Terengganu - NT method

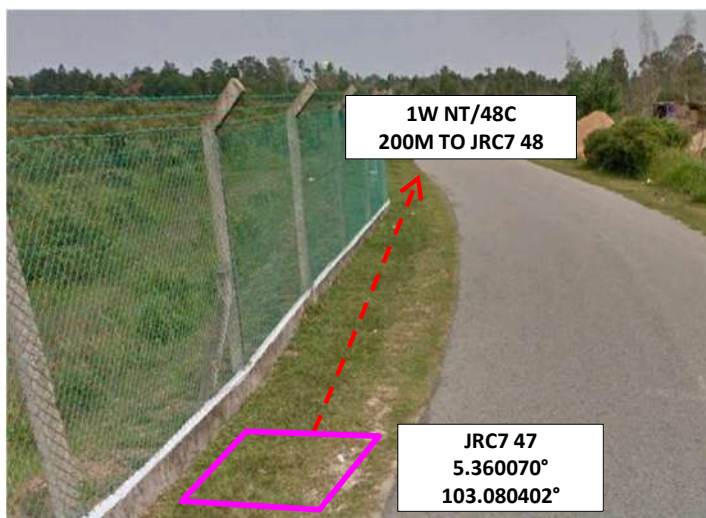

Propose route across Jalan Kuala Terengganu - NT method

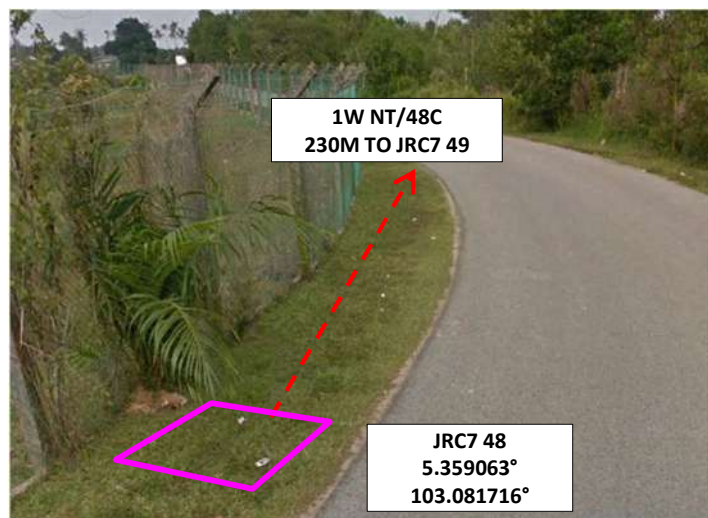

Propose route across Jalan Kuala Terengganu - NT method

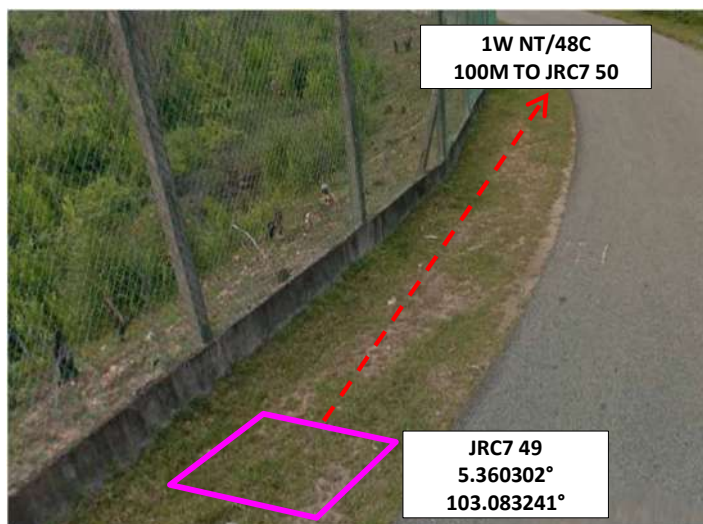

Propose route across Jalan Kuala Terengganu - NT method

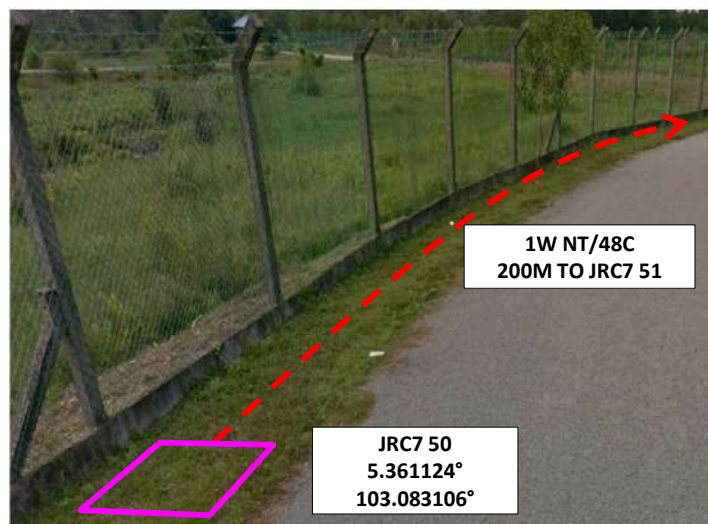

Propose route across Jalan Kuala Terengganu - NT method

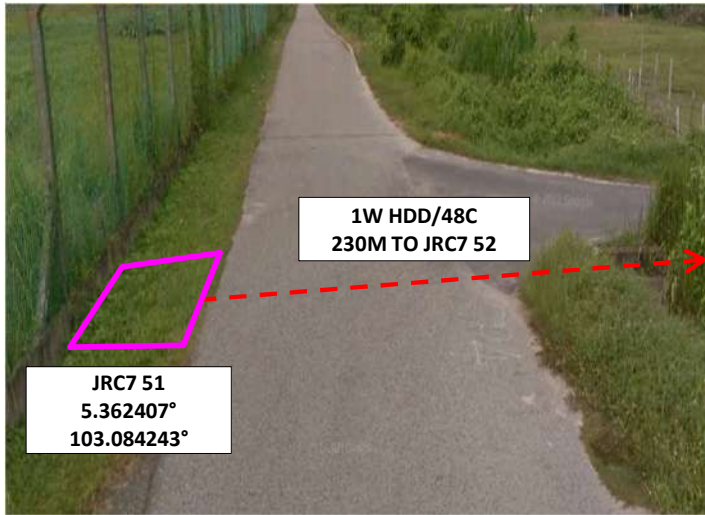

Propose route across Jalan Kuala Terengganu - HDD method

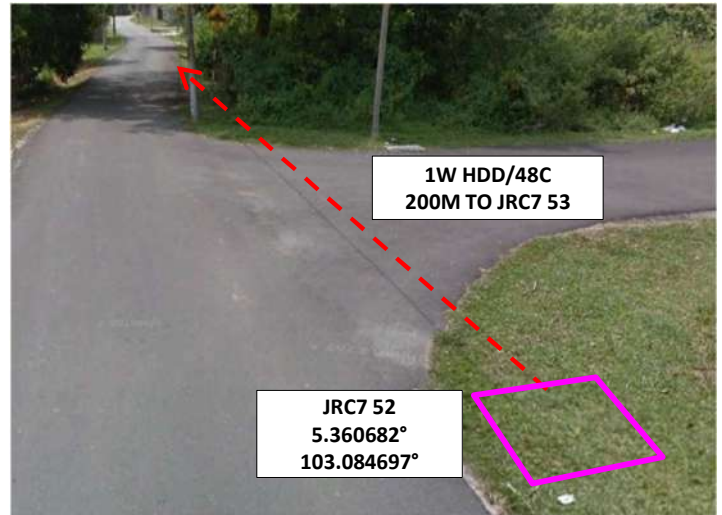

Propose route across Jalan Kuala Terengganu - HDD method

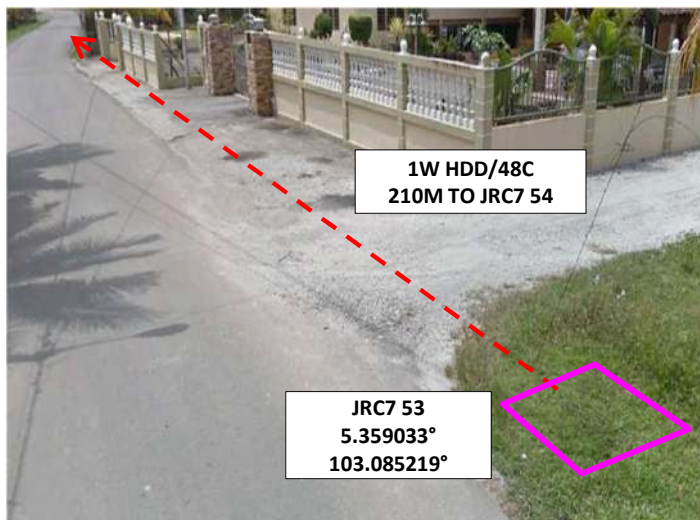

Propose route across Jalan Kuala Terengganu - HDD method

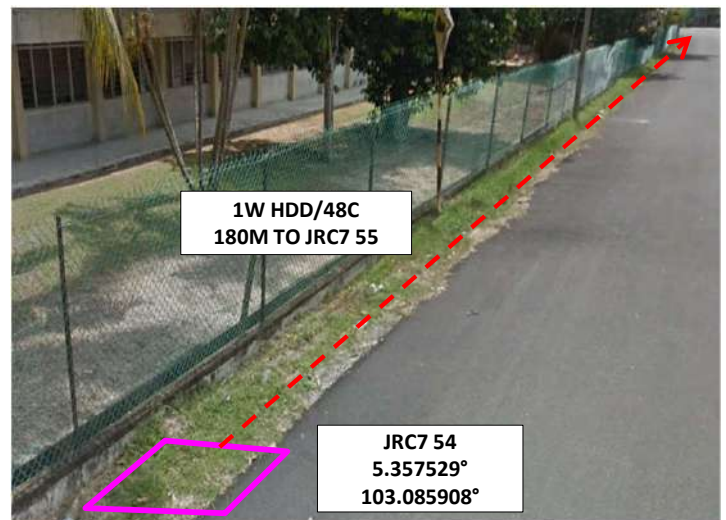

Propose route across Jalan Kuala Terengganu - HDD method

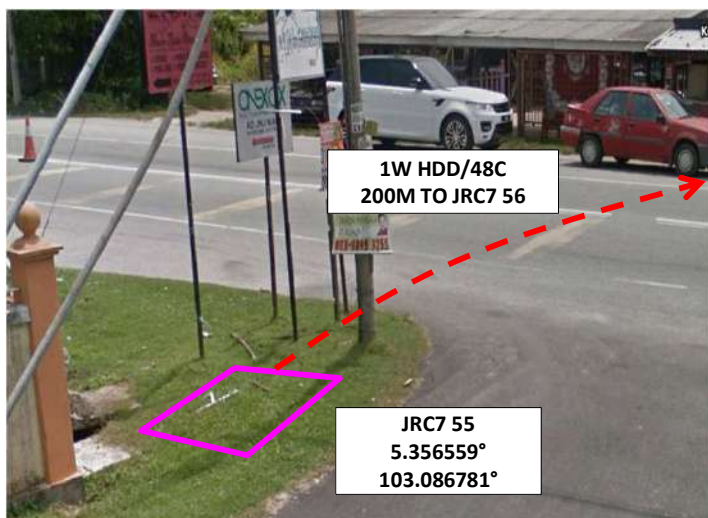

Propose route across Jalan Kuala Terengganu - HDD method

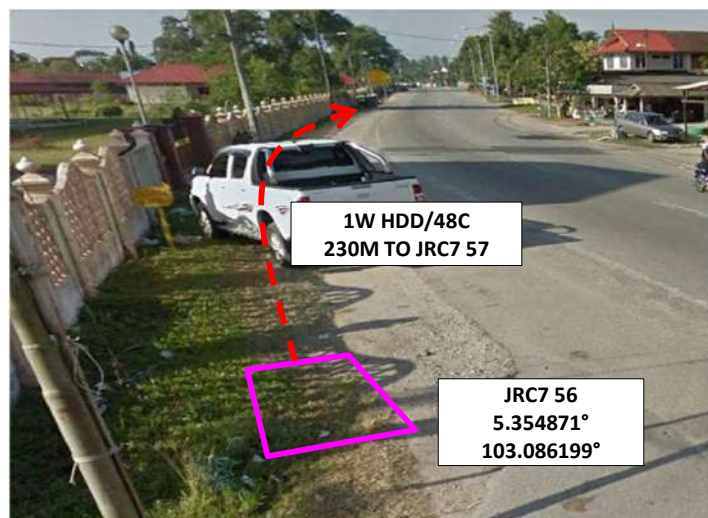

Propose route across Jalan Kg Baru - HDD method



Propose route across Jalan Kg Baru - HDD method



Propose route across Jalan Kg Baru - HDD method



Propose route across Jalan Kg Baru - HDD method



Propose route across Jalan Kg Baru - HDD method



Propose route across Jalan Kg Baru - HDD method



Propose route across Jalan Kg Baru - HDD method

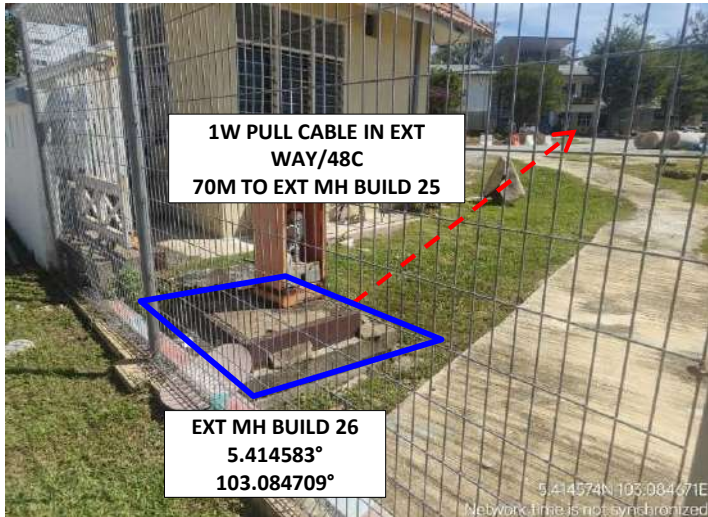

Propose route in UMT's Compound – Pull Cable method



Propose route in UMT's Compound – Pull Cable method

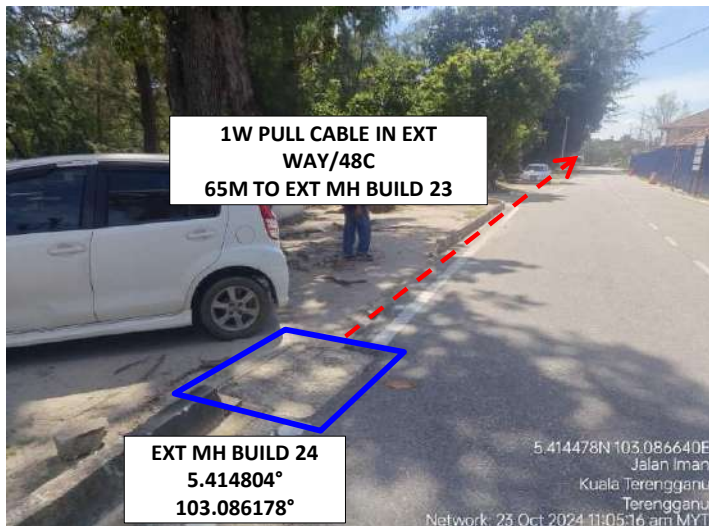

Propose route in UMT's Compound – Pull Cable method

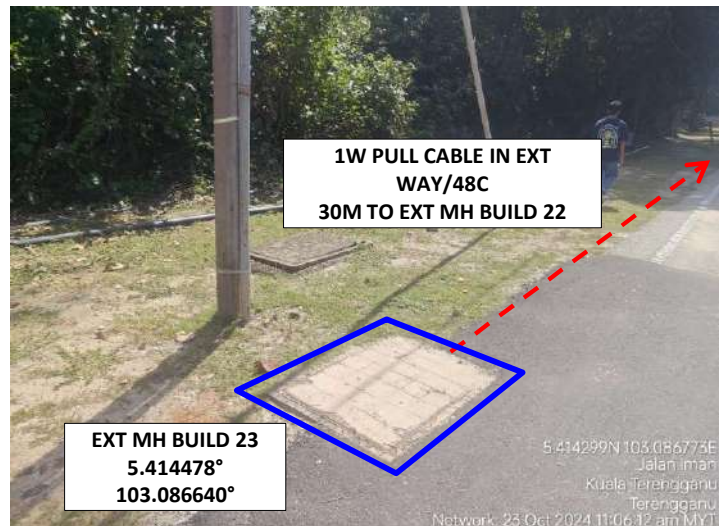

Propose route in UMT's Compound – Pull Cable method

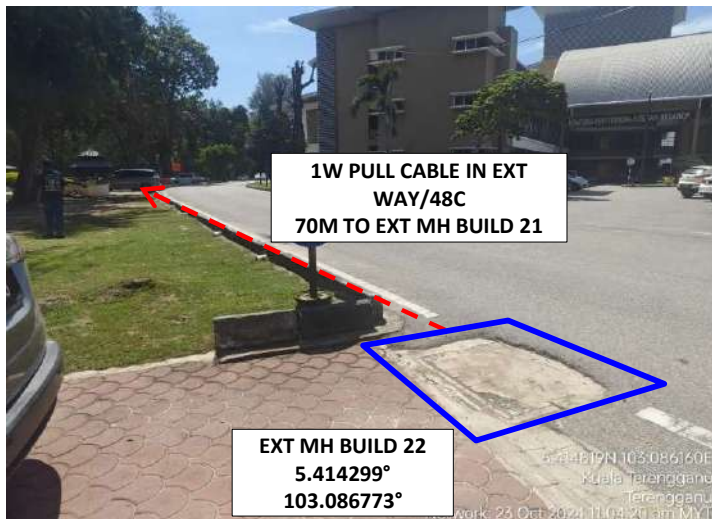

Propose route in UMT's Compound – Pull Cable method

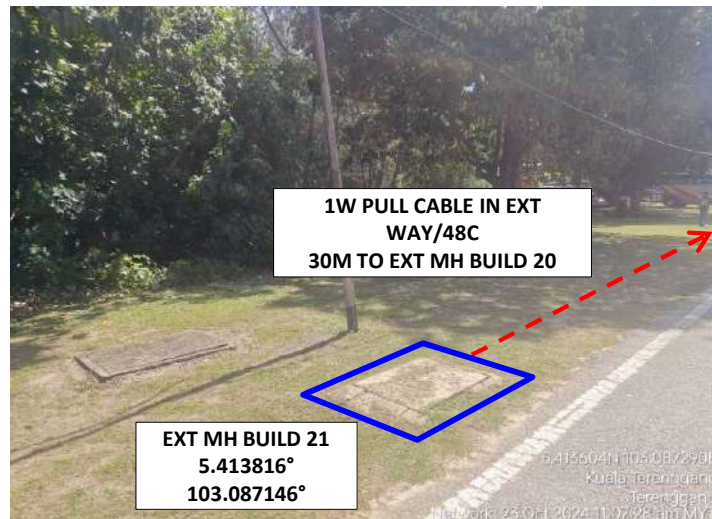

Propose route in UMT's Compound – Pull Cable method



Propose route in UMT's Compound – Pull Cable method

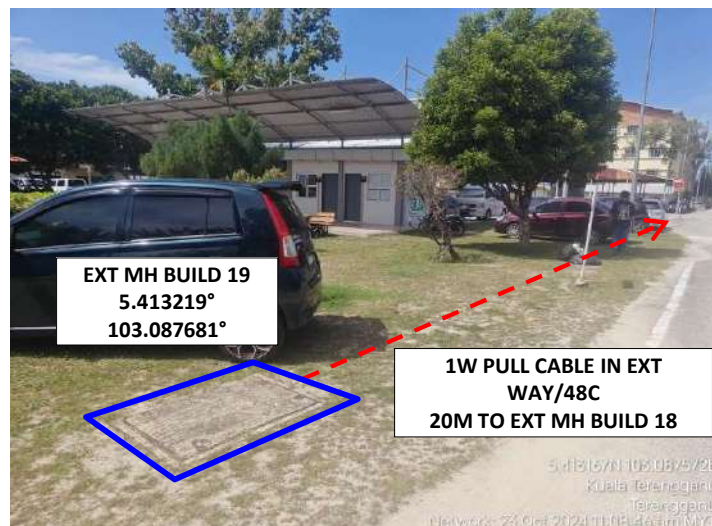

Propose route in UMT's Compound – Pull Cable method



Propose route in UMT's Compound – Pull Cable method

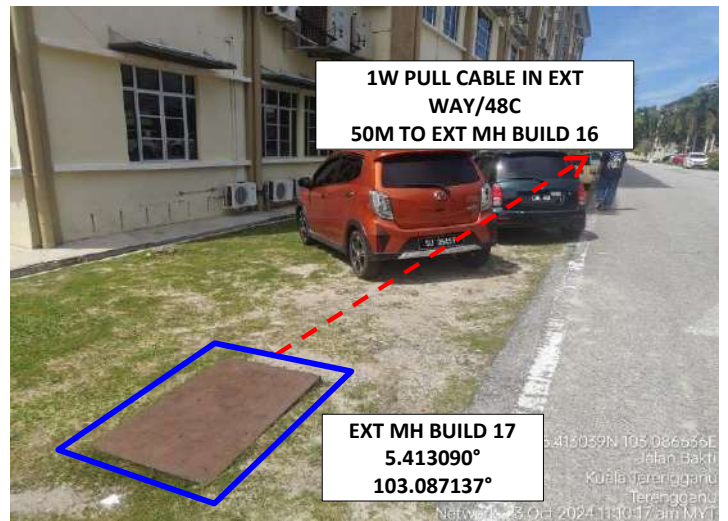

Propose route in UMT's Compound – Pull Cable method

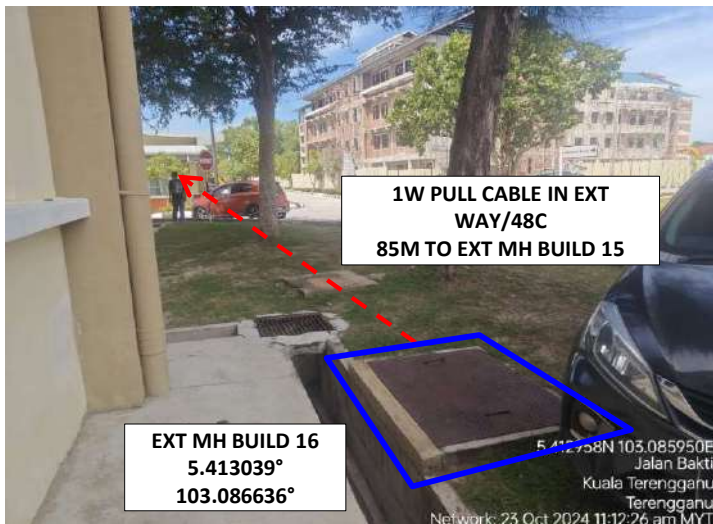

Propose route in UMT's Compound – Pull Cable method

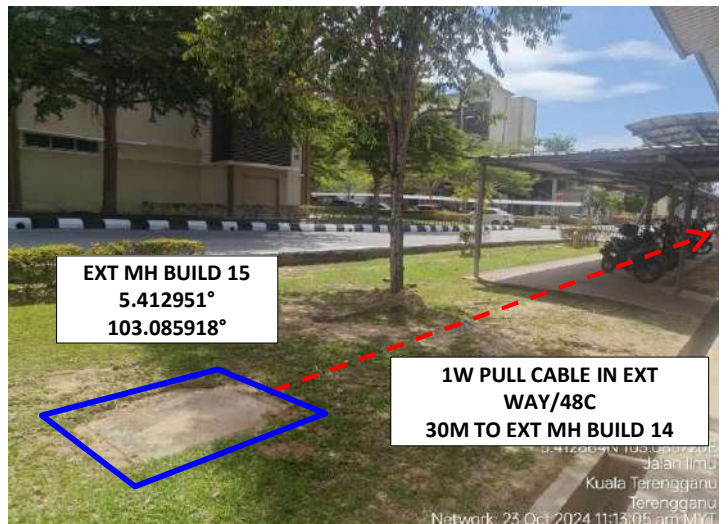

Propose route in UMT's Compound – Pull Cable method

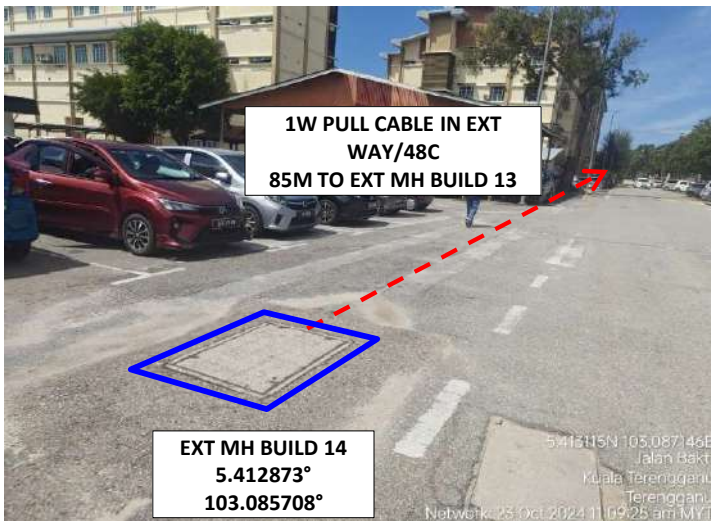

Propose route in UMT's Compound – Pull Cable method

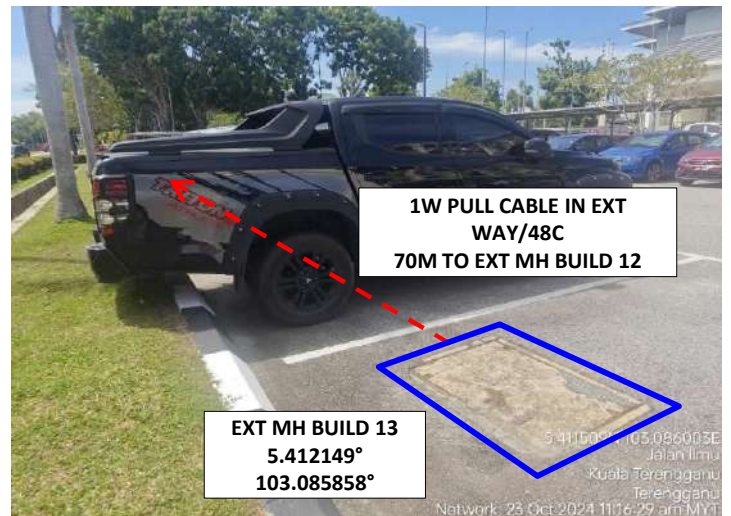

Propose route in UMT's Compound – Pull Cable method

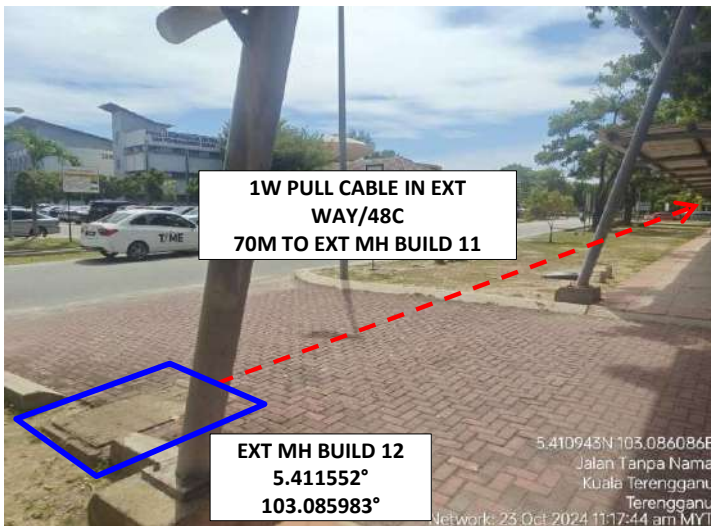

Propose route in UMT's Compound – Pull Cable method

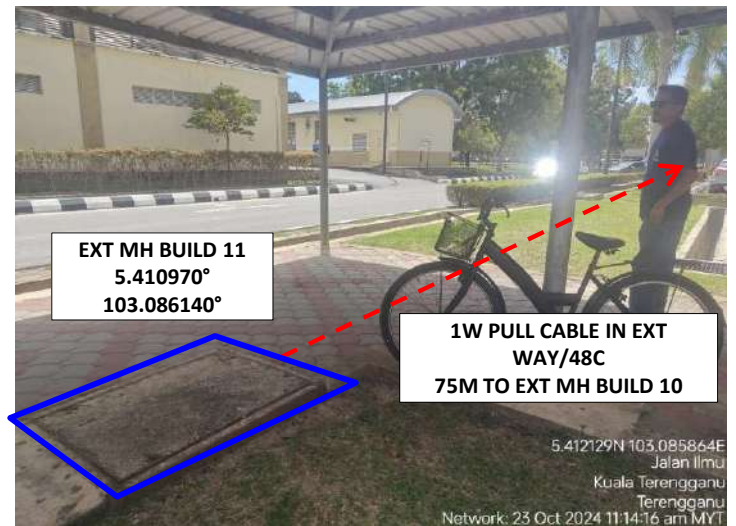

Propose route in UMT's Compound – Pull Cable method

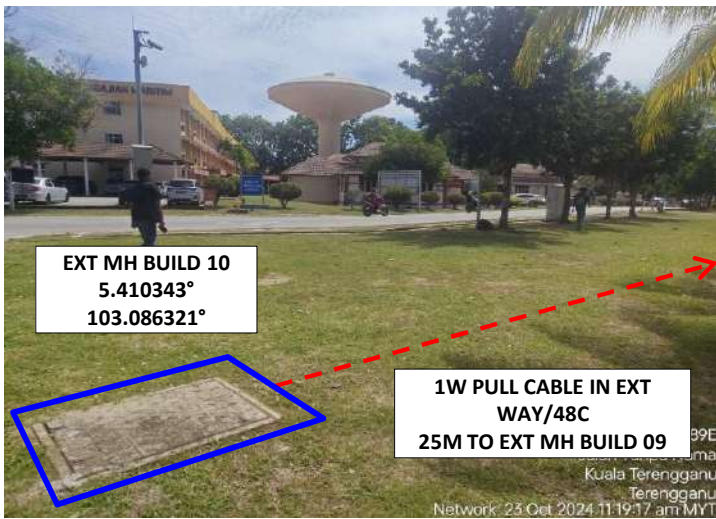

Propose route in UMT's Compound – Pull Cable method



Propose route in UMT's Compound – Pull Cable method



Propose route in UMT's Compound – Pull Cable method

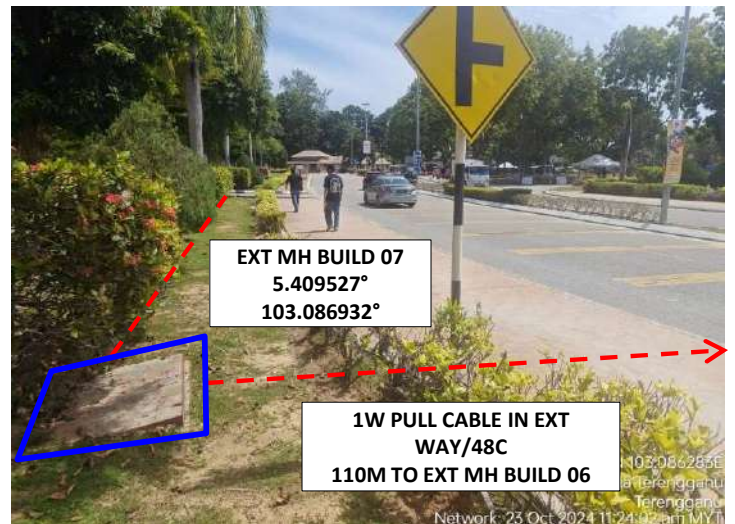

Propose route in UMT's Compound – Pull Cable method

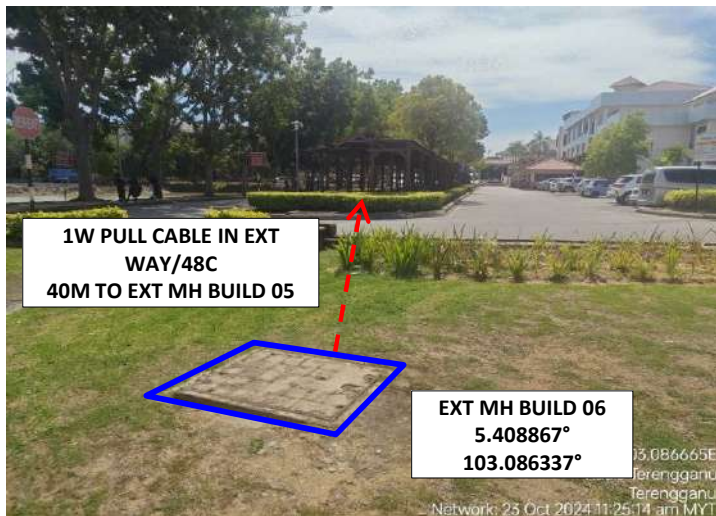

Propose route in UMT's Compound – Pull Cable method

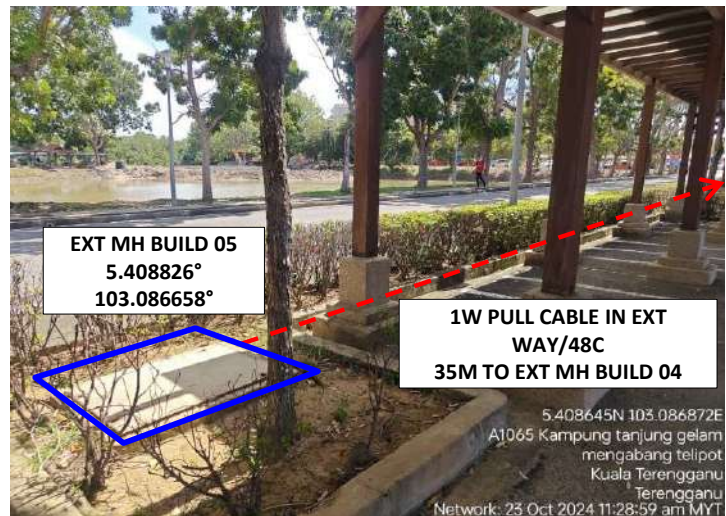

Propose route in UMT's Compound – Pull Cable method

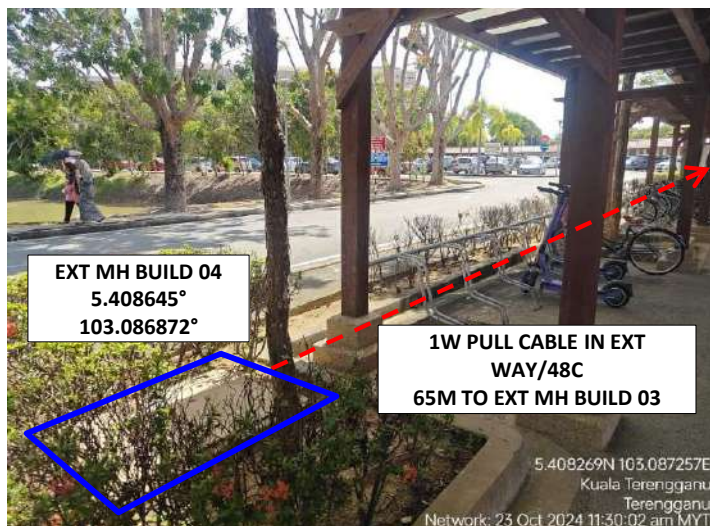

Propose route in UMT's Compound – Pull Cable method



Propose route in UMT's Compound – Pull Cable method



Propose route in UMT's Compound – Pull Cable method



Propose route in UMT's Compound – Pull Cable method