

DATUM 135.00m	GROUND LEVEL	146.50	146.50	146.20	146.20	146.50	148.00	149.60	150.50	150.80	151.90
	INVERT LEVEL	144.00	144.05	144.10	144.10	144.40	145.90	147.50	148.40	148.70	149.80
	GRADIENT	1:400	1:400								
	SUMP INVERT LEVEL										
	DISTANCE	0.00	20.00	40.00	80.00	80.00	100.00	120.00	140.00	160.00	180.00
	BOX CULVERT	U-DRAIN 1500x2100mm	U-DRAIN 1500x2100mm	U-DRAIN 1500x2100mm	U-DRAIN 1500x2100mm	U-DRAIN 1500x2100mm	U-DRAIN 1500x2100mm	U-DRAIN 1500x2100mm	U-DRAIN 1500x2100mm	U-DRAIN 1500x2100mm	U-DRAIN 1500x2100mm
	Type & Size (M)										
	HORIZONTAL SCALE 1:1										
	VERTICAL SCALE 1:1000										

**MAJLIS DAERAH GERIK**  
 NO. RUJ. OPS. NEG. OCC. 1000-16/2017  
 NO. RUJ. JP. B-1(1) dan A10(1) Kg. / Abi/19  
 NO. PELAN 10/2020  
 BIL. / TARIKH 10/2020  
 MESYUARAT 22 NOVEMBER 2020  
 PELAN JALAN DAN PARTI INI DIPERAKUI TELAH MEMATUHI KEPERLUAN YANG DITETAPKAN  
 [RUJUK SYARAT PEMATUHAN KELULUSAN]  
**DILULUSKAN**  
 Di Bawah Suruhanjaya 9(2) Akta Jalan, Partit Dan Bangunan 1974 (Akta 143)  
 Yang Dipertua  
 Majlis Daerah Gerik

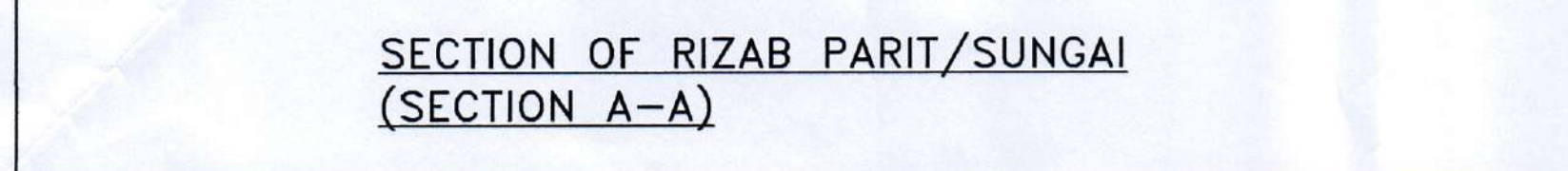

- LEGEND:-**
- PROP. 450x450 U-DRAIN
  - PROP. 450x600 U-DRAIN
  - PROP. 600x600 U-DRAIN
  - PROP. 900x900 U-DRAIN
  - PROP. 900x1200 U-DRAIN
  - PROP. 1200x1200 U-DRAIN
  - PROP. 600x600 BOX CULVERT
  - PROP. 1500x2100 U-DRAIN
  - PROP. 1500x2100 BOX-CULVERT
  - LALUAN PEJALAN KAKI/LALUAN BASIKAL
  - PROPOSED ROAD
  - PROPOSED BUMP
  - EXISTING DRAIN / EARTH DRAIN
  - EXISTING ROAD
  - PROPOSED SUMP
  - DRAIN FLOW DIRECTION
  - PL 153.30 PROP. FINISHED GROUND LEVEL
  - RL 153.00 PROP. FINISHED ROAD LEVEL
  - ERL 153.70 EXIST. FINISHED ROAD LEVEL

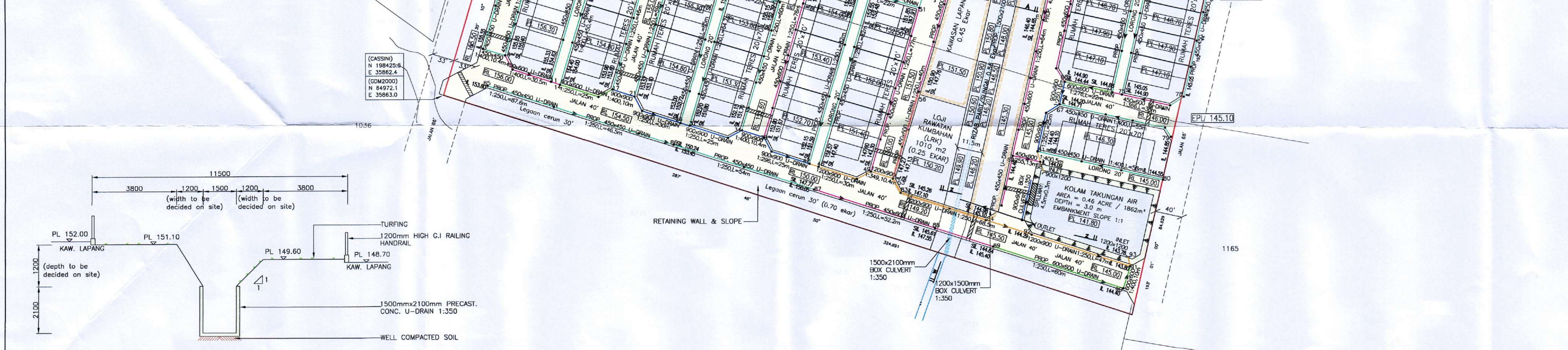

PROJECT :  
**CADANGAN JALAN DAN PERPARTAN BAGI SKIM PERUMAHAN DI ATAS LOT 1396 DAN LOT 1625, MUKIM GERIK, DAERAH HULU PERAK, PERAK DARUL RIDZUAN. UNTUK ASIA BINA IDAMAN SDN. BHD.**

OWNER SIGNATURE :  
  
 ASIA BINA IDAMAN SDN. BHD.  
 (No. Syarikat : 872920-D)  
 ADDRESS : NO. 26, JALAN SEMARAK 1, TAMAN SEMARAK, 33300 GERIK, PERAK DARUL RIDZUAN.

SUBJECT :  
 PELAN KUNCI, PELAN LOKASI & PELAN TAPAK  
 (KELULUSAN PELAN JALAN & PERPARTAN)  
**P Y K CONSULTANT**  
 CIVIL & STRUCTURAL ENGINEERS  
 MAIN OFFICE:  
 NO. 208, JALAN CHANG AH MING, PASIR PUTEH, 31650 IPOH, PERAK DARUL RIDZUAN.  
 TEL : 05-3221298 FAX : 05-3229298  
 SITE OFFICE:  
 NO. 37, FIRST FLOOR, JALAN TBC 5, TAMPING BUSINESS CENTRE, 34000 TAMPING, PERAK DARUL RIDZUAN.  
 TEL : 05-8104455 H/P : 012-5121138

SCALE 1 : 1000  
 DATE 10/2020  
 SHEET 1/4  
 DRAWN BY YANG  
 CHECKED BY TANG  
 ENGINEER SIGNATURE :  
 I certify that the design for the complete set of drawings follows the Urban Stormwater Management Manual For Malaysia (Manual Saliran Mesra Alam Malaysia) by the Department of Irrigation and Drainage Malaysia, 2000. I will full responsibility for the design and supervision of the works. If it is found the proposed drain is too small, the developer will have to enlarge the drain section accordingly so that there will not be any local flooding in this housing scheme.



DRAWING NO :  
 PYK/ABI(LOT1396)/20 (RD) 1/4

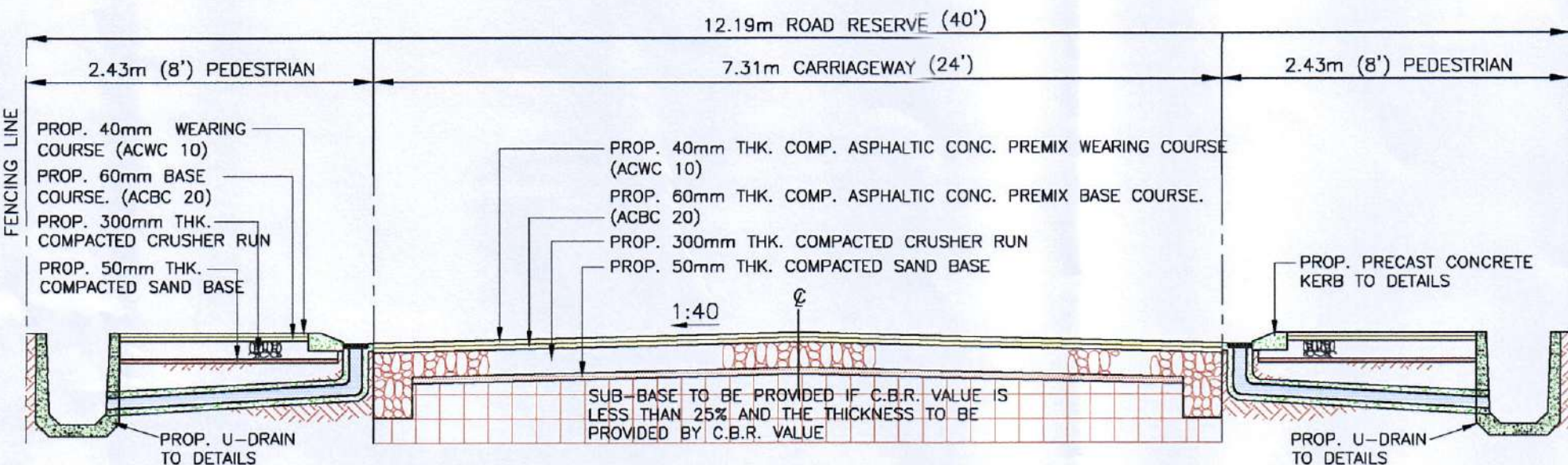

12.19m (40') ROAD RESERVE  
SCALE : NTS

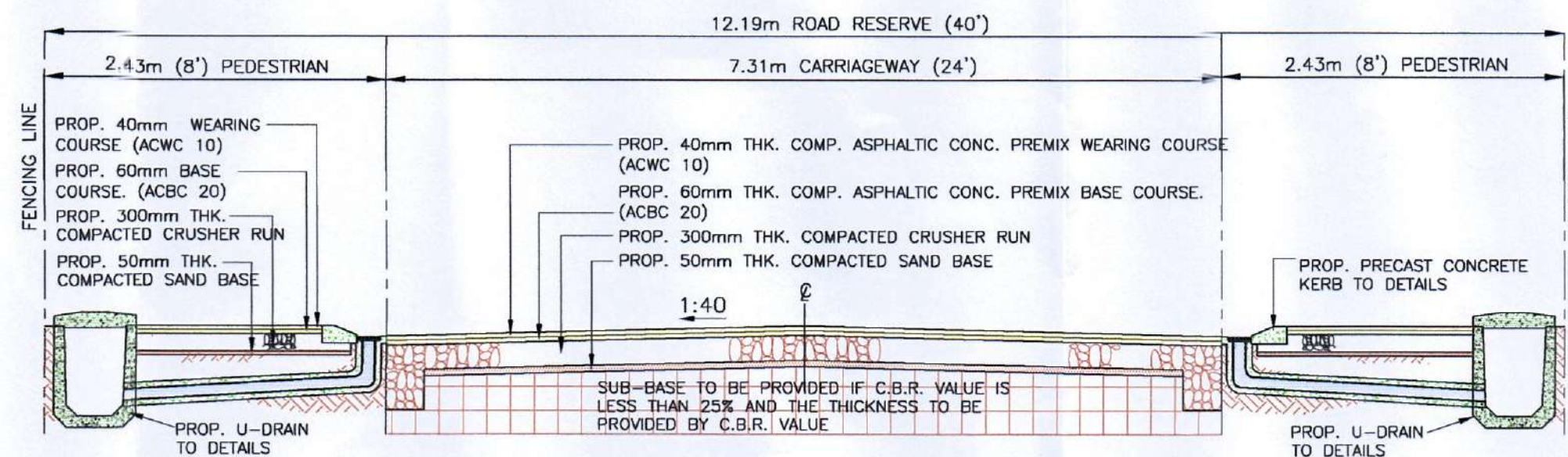

12.19m (40') ROAD RESERVE-(ENTRANCE)  
SCALE : NTS

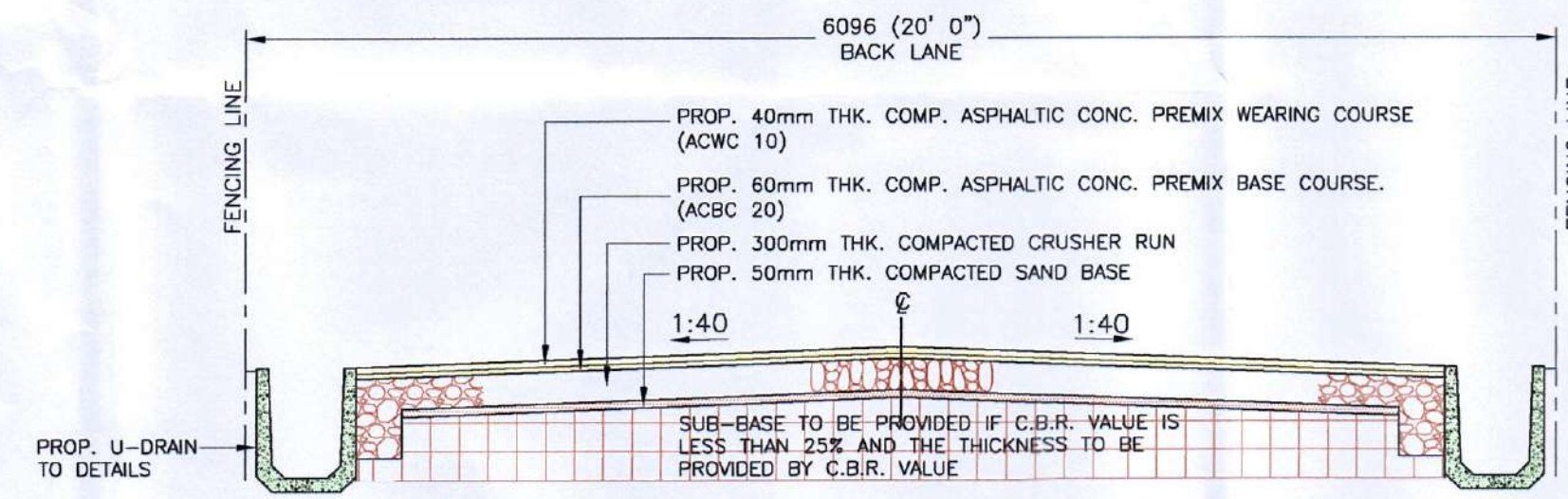

TYPICAL SECTION OF 6.096m (20') ROAD RESERVE  
SCALE : NTS

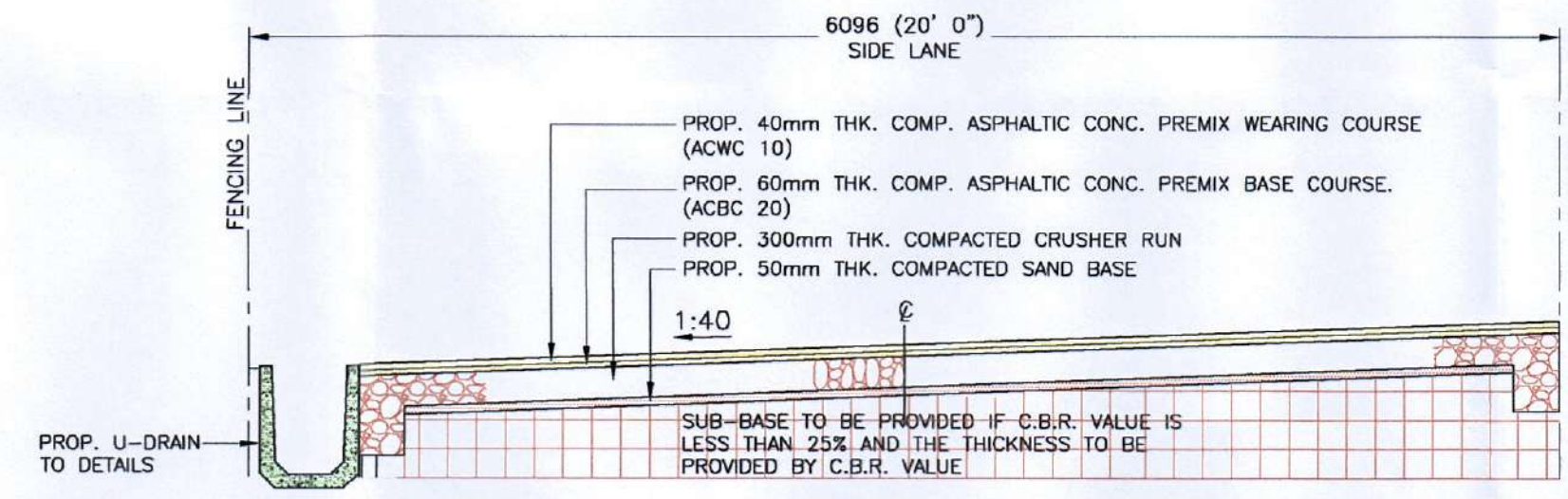

TYPICAL SECTION OF 6.096m (20') ROAD RESERVE  
SCALE : NTS

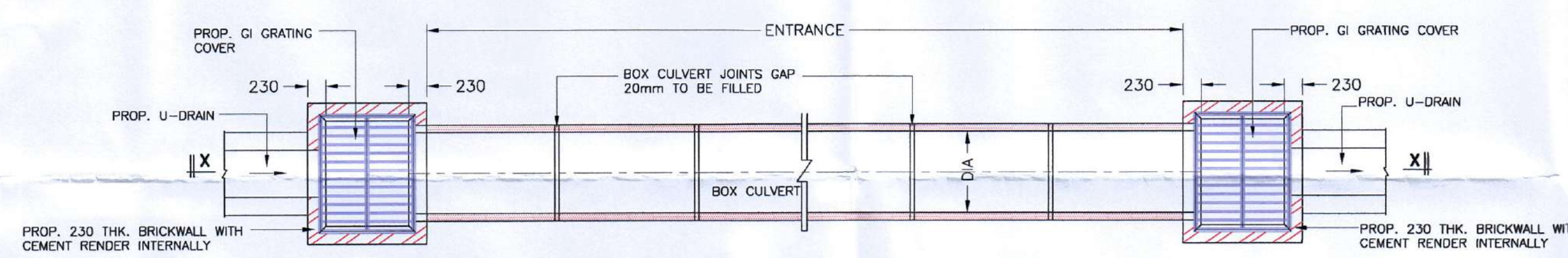

PLAN OF BOX CULVERT & SUMP DETAIL  
(ENTRANCE)  
SCALE: NTS

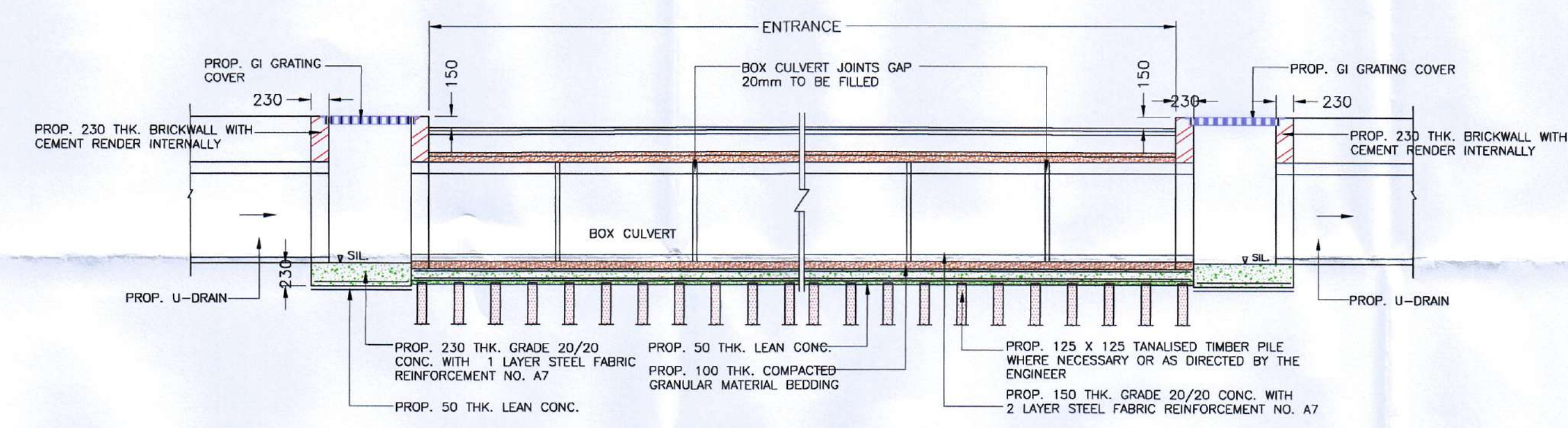

SECTION X-X (ENTRANCE)  
SCALE: NTS

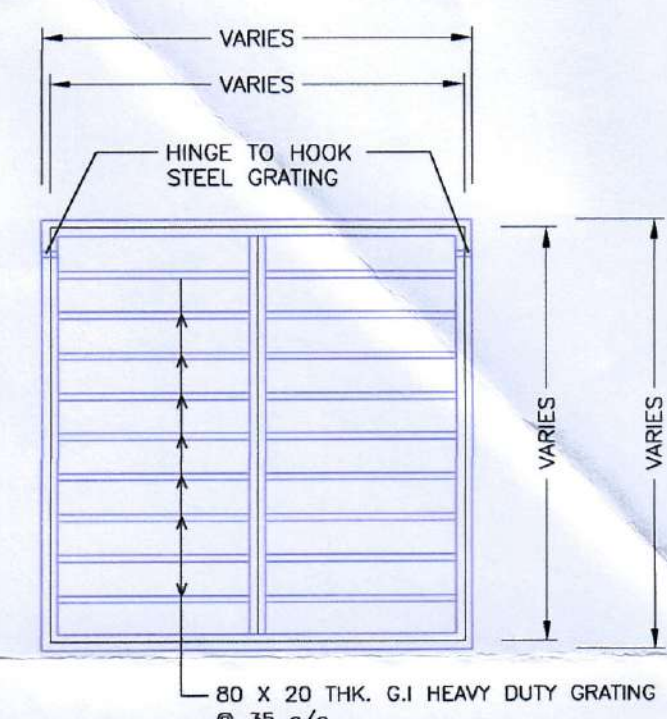

DETAIL OF G.I. GRATING  
SCALE: NTS

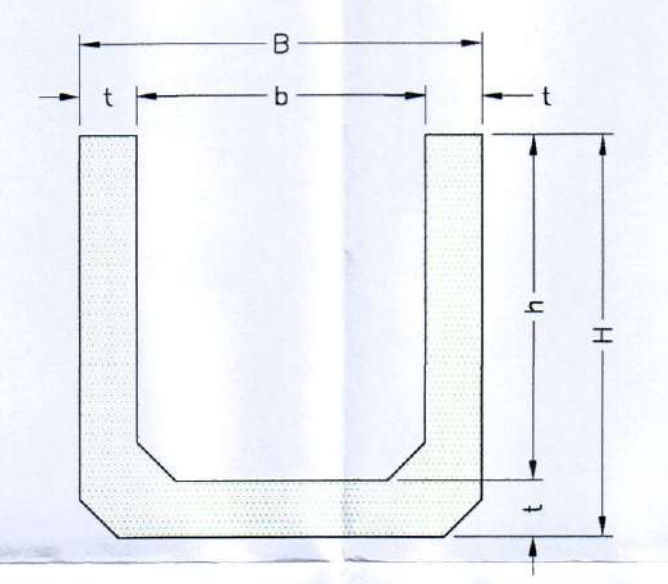

STANDARD SIZE U-DRAIN						
NOMINAL SIZE	b	h	t	B	H	
450	450	450	65	580	515	
600	600	600	65	730	665	
750	750	750	80	910	830	
900	900	900	80	1060	980	
1200	1200	1200	80	1360	1280	
1500	1500	1500	90	1720	1590	

DETAILS OF U SHAPE DRAIN  
(approved by sirm)  
SCALE: NTS

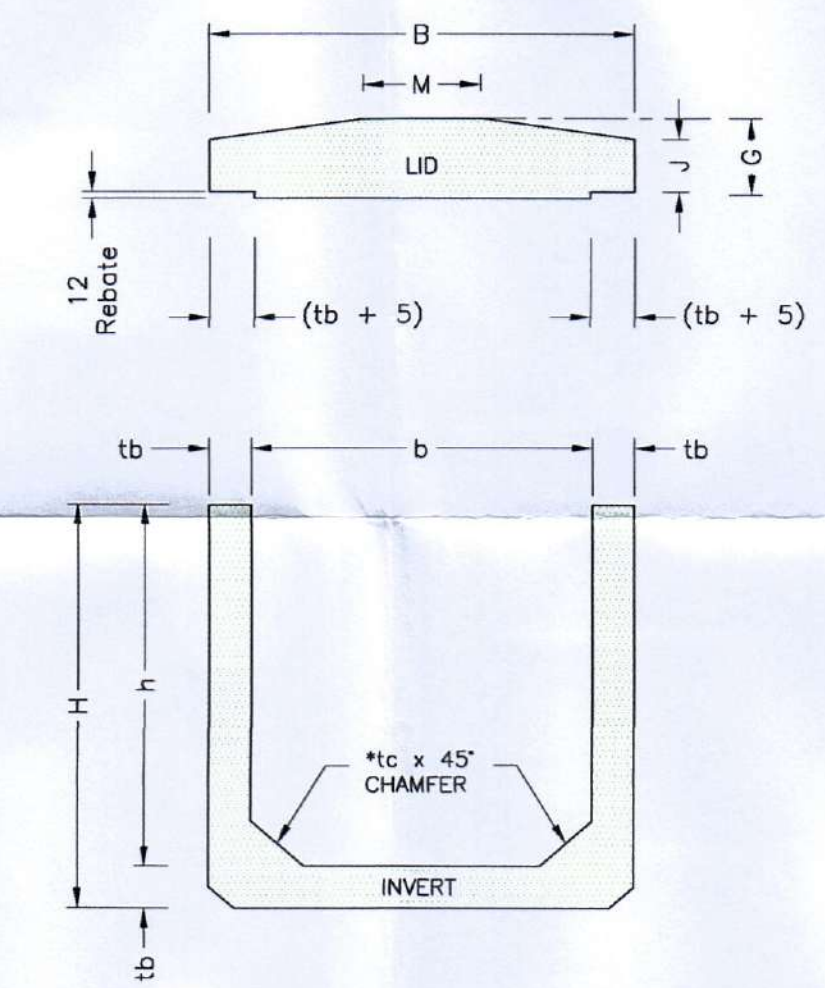

TYPICAL BOX CULVERT DETAILS

NOTE : \*tc = tb for b = 600, 900, 1500 and 1800,  
tc = 50 for b = 1200

NOMINAL SIZE	DIMENSIONS							WEIGHT (TONNES)		
	b	h	B	H	tb	C	J	M	LID	INVERT
450	450	1060	530	80	140	100	225	0.33	0.41	
	600	1060	680	80	140	100	225	0.33	0.47	
	750	1060	830	80	140	100	225	0.33	0.52	
900	900	1060	980	80	140	100	225	0.33	0.58	
	600	1390	695	95	150	110	225	0.48	0.62	
	750	1390	845	95	150	110	225	0.48	0.69	
1200	900	1390	995	95	150	110	225	0.48	0.76	
	1050	1390	1145	95	150	110	225	0.48	0.83	
	1200	1390	1295	95	150	110	225	0.48	0.90	
1500	750	1700	850	100	175	125	300	0.66	0.84	
	900	1700	1000	100	175	125	300	0.66	0.91	
	1050	1700	1150	100	175	125	300	0.66	0.98	
	1200	1700	1300	100	175	125	300	0.66	1.05	
	1350	1700	1450	100	175	125	300	0.66	1.13	
	1500	1700	1600	100	175	125	300	0.66	1.21	

BOX CULVERT TABLE

**MAJLIS DAERAH GERIK**  
 NO. RUJ. OSC MGGK-SC/2020-(U/AL-1)  
 NO. RUJ. JP R(15) dan MGGK-ke/7AD/18/19  
 NO. PELAN seperti di atas  
 BIL. /TARIKH 22 NOVEMBER 2020  
 MESYUARAT 22 NOVEMBER 2020  
 PELAN JALAN DAN PERPARTAN INI DIPERAKUI TELAH MEMATUHI KEPERLUAN YANG DITETAPKAN (RUJUK SYARAT PEMATUHAN KELULUSAN)  
**DILULUSKAN**  
 Di Bawah Seksyen 9(2) Akta Jalan, Parit Dan Bangunan 1974 (Act 143)  
 Yang Dipertua Majlis Daerah Gerik  
 TARIKH DIBERIKAN  
 TARIKH LUPUT  
 SEMUA PELAN UNTUK MEMBUAT SESUATU JALAN BAHARU YANG TELAH DILULUSKAN HENDAKLAH TAMAT APABILA BERAKHIR SATU TAHUN MELAINKAN SESUATU PEMBAHARUAN BAGI KELULUSAN ITU DIBERIKAN OLEH PIHAK BERKUALA TEMPATAN (SEKSYEN 10, AKTA 133)

PROJECT :  
 CADANGAN JALAN DAN PERPARTAN BAGI SKIM PERUMAHAN DI ATAS LOT 1396 DAN LOT 1625, MUKIM GERIK, DAERAH HULU PERAK, PERAK DARUL RIDZUAN. UNTUK ASIA BINA IDAMAN SDN. BHD.

OWNER SIGNATURE :  
  
 ASIA BINA IDAMAN SDN. BHD.  
 (No. Syarikat : 872920-D)  
 ADDRESS : NO. 26, JALAN SEMARAK 1, TAMAN SEMARAK, 33300 GERIK, PERAK DARUL RIDZUAN.

SUBJECT :  
 STANDARD DETAILS  
 (KELULUSAN PELAN JALAN & PERPARTAN)

**PYK CONSULTANT**  
 CIVIL & STRUCTURAL ENGINEERS  
 MAIN OFFICE:  
 NO. 29B, JALAN CHUNG AH MING, PASIR PUTEH, 31850 BPTM, PERAK DARUL RIDZUAN.  
 TEL : 05-3221288 FAX : 05-3229298  
 SITE OFFICE:  
 NO. 37, FIRST FLOOR, JALAN TBC 5, TAPING BUSINESS CENTRE, 34000 TAPING, PERAK DARUL RIDZUAN.  
 TEL : 012-9121138

SCALE : 1 : 750  
 DATE : 10/2020  
 SHEET : 2/4  
 DRAWN BY : AYA  
 CHECKED BY : TANG  
 ENGINEER SIGNATURE :  
 I certify that the design for the complete set of drawings follows the Urban Stormwater Management Manual for Malaysia (Manual Soliran Merau Nerus Malaysia) by the Department of Irrigation and Drainage Malaysia, 2000. I will full responsibility for the design and supervision of the work. If it is found the proposed drain is too small, the developer will have to enlarge the drain section accordingly so that there will not be any local flooding in this housing scheme.

PROFESSIONAL ENGINEER  
 CIVIL  
 IF PANG YOON KHONG  
 C114574  
 MALAYSIA

In. Pang Yoon Khong  
 B.Eng.(Hons.), M.Eng., M.Eng., P.Eng.  
 (Principal)

DRAWING NO :  
 PYK/ABI(LOT1396)/20 (RD) 2/4

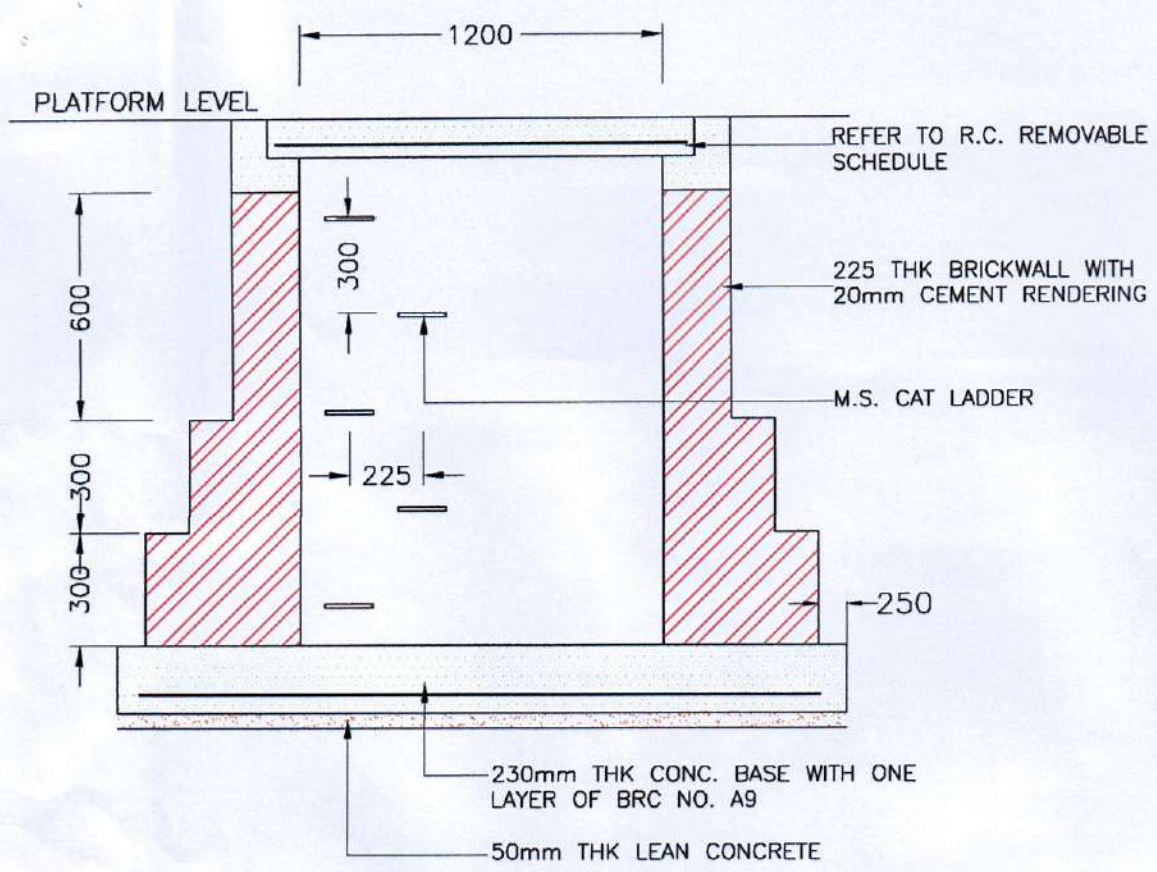

**SECTIONAL DETAIL OF SUMP  
1200mm HEIGHT AND BELOW**  
SCALE 1:20

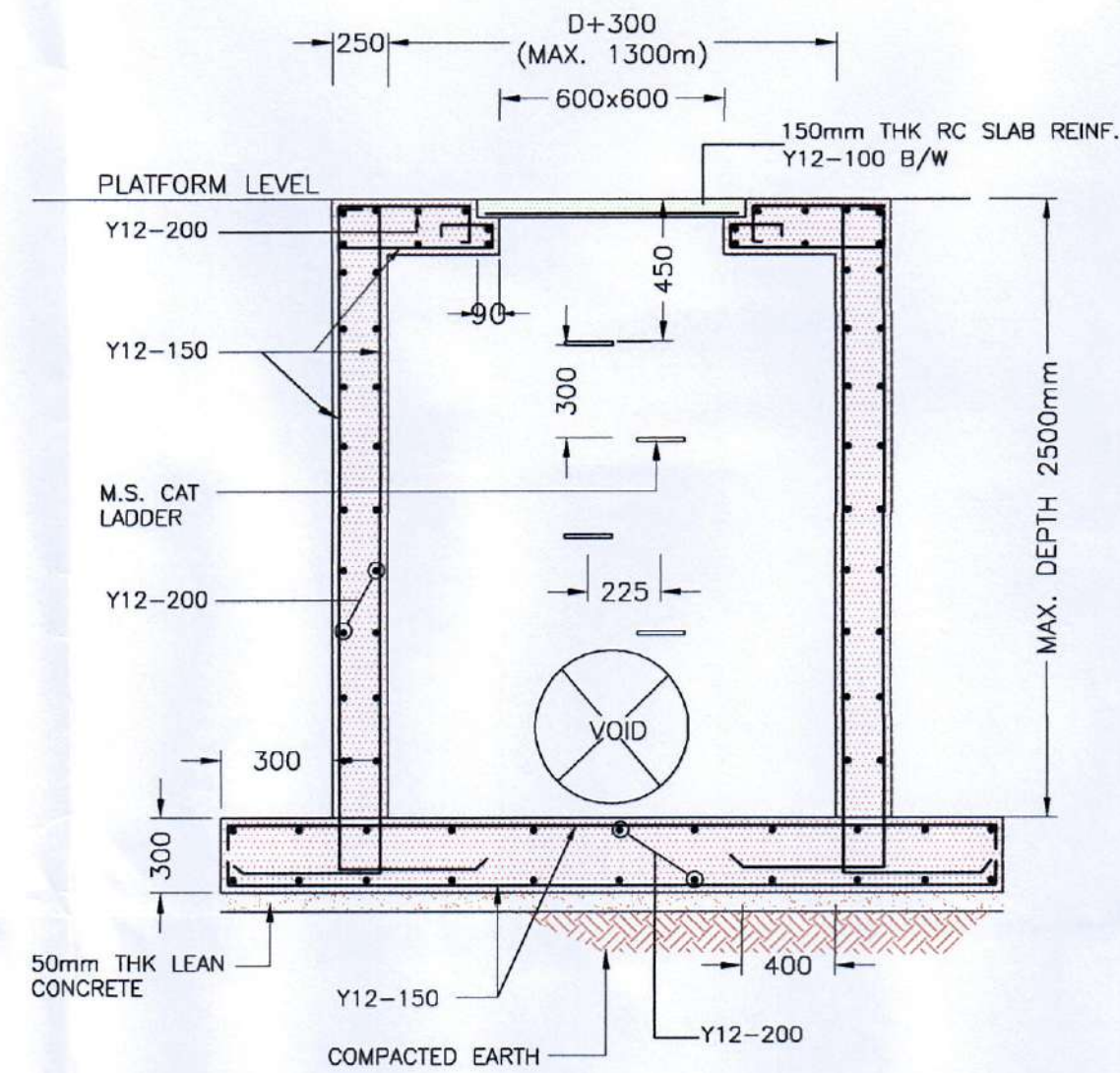

**SECTIONAL DETAIL OF SUMP  
OVER 1200mm HEIGHT**  
SCALE 1:20

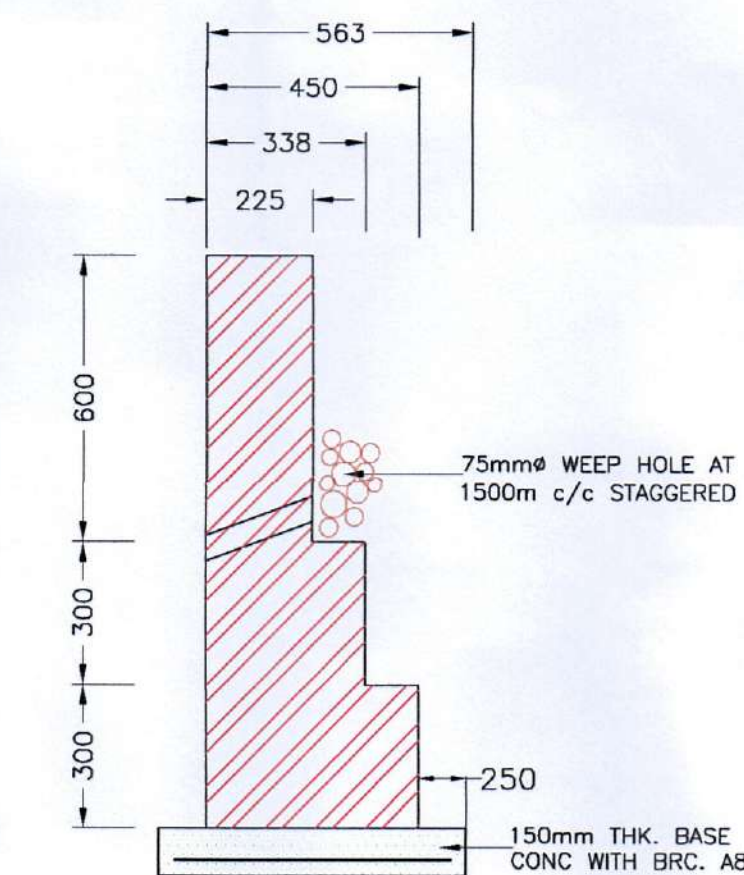

**TYPICAL BRICK RETAINING WALL**  
Scale: 1:20

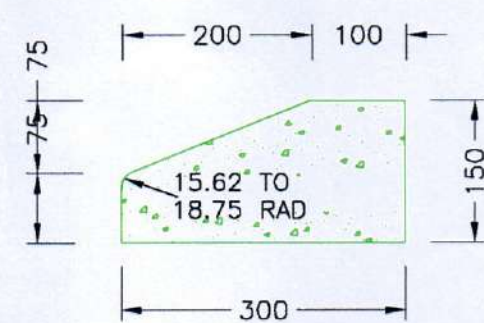

**PRECAST CONCRETE KERB**  
SCALE : 1:10

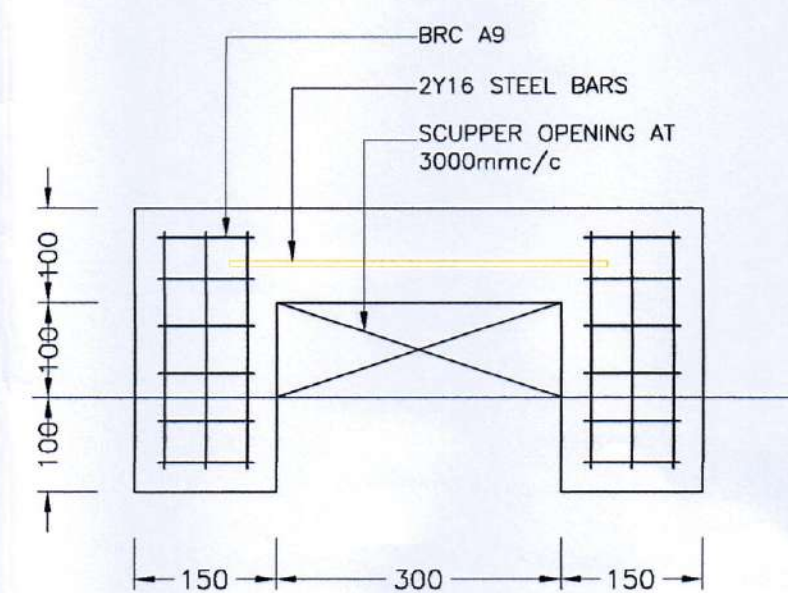

**ELEVATION OF SCUPPER OPENING**  
SCALE : 1:10

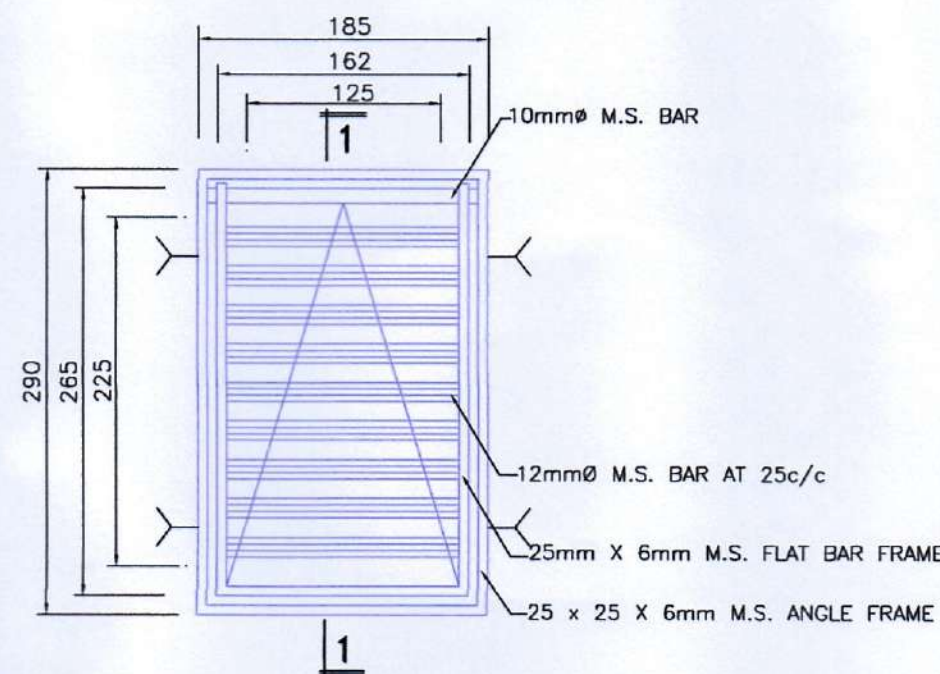

**IRON GRATING FOR ROAD GULLY**

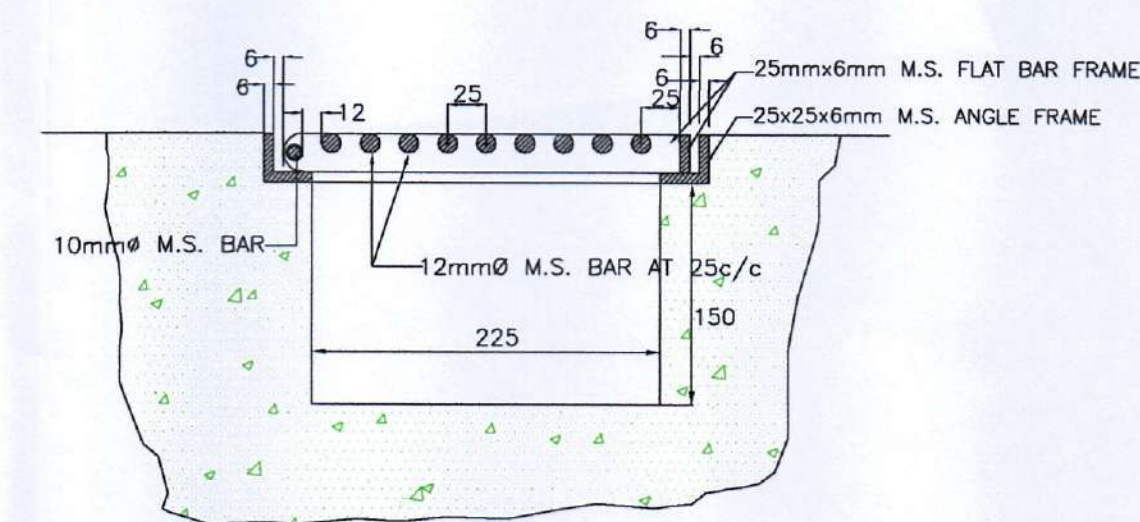

**SECTION 1-1**

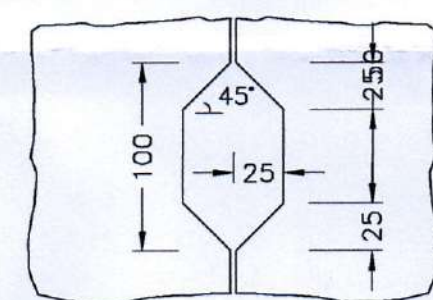

**DETAIL OF LIFTING HOLE FOR  
R.C. REMOVABLE SLAB**  
SCALE : 1:5

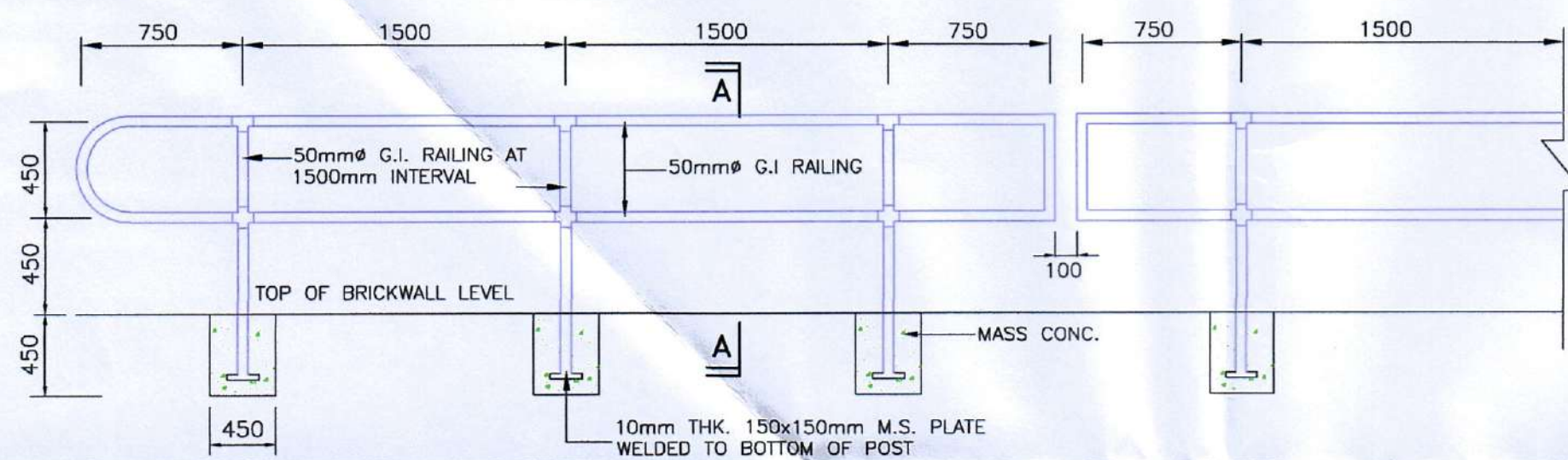

**TYPICAL DETAIL OF 50mm G.I. GUARD RAILING ALONG MONSOON DRAIN**

SCALE : N.T.S

- NOTE :**
1. RAILING SHALL BE PAINTED WITH PRIME ZINC CHROMATE, ONE UNDERCOAT AND TWO FINISHING COATS OF CONIFER-ICI-13339 GREEN COLOUR.
  2. RAILING SHALL BE PROVIDED TO ALL ROAD SIDE DRAINS EXCEEDING 1050mm DEEP AND TO MAIN DRAINS.

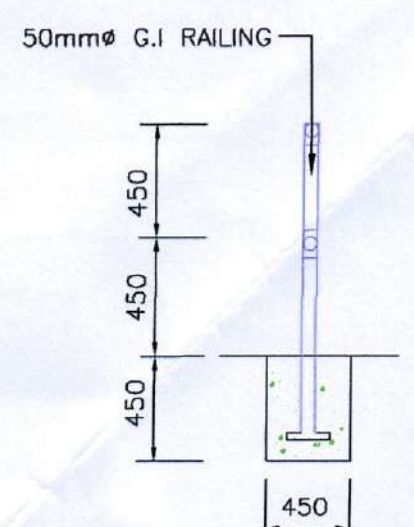

**SECTION A-A**

PROP. 50mm x 30mm  
FLAT PLATE

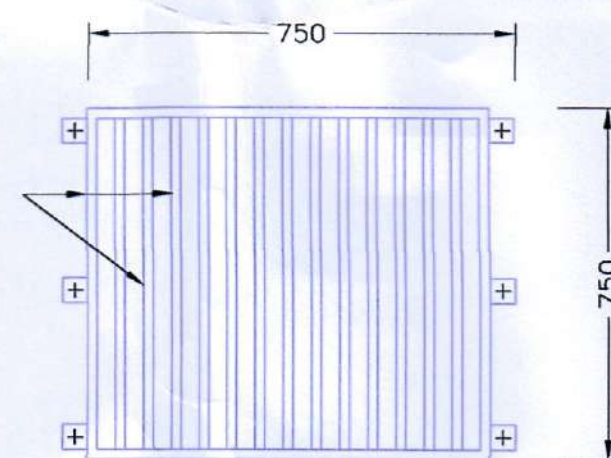

**DETAIL OF M.S. TRASH SCREEN**  
SCALE : N.T.S

**MIXTURES REQUIREMENTS**  
GRADING : COMBINED GRADING OF COARSE, FINE AGGREGATES & FILLER IS AS FOLLOW

SIEVE	ACW 14
37.5	--
28	--
20	100
14	80-95
10	68-90
5	52-72
3.35	45-62
1.8	30-45
0.425	17-30
0.150	7-16
0.075	4-10
*BINDER	5-7%

**R.C. REMOVABLE SLAB SCHEDULE**

W (WIDTH)	T (THICKNESS)	MAIN BARS	DISTRIBUTION	ALTERNATIVE REINF.
600mm	100mm	Y12-100 c/c	Y12-200 c/c	2 layers BRC A8
750mm	100mm	Y12-100 c/c	Y12-200 c/c	2 layers BRC A8
900mm	125mm	Y12-100 c/c	Y12-200 c/c	2 layers BRC A9
1050mm	163mm	Y16-125 c/c	Y12-150 c/c	2 layers BRC A10
1200mm	163mm	Y16-125 c/c	Y12-150 c/c	2 layers BRC A10
1350mm	175mm	Y16-125 c/c	Y12-150 c/c	2 layers BRC A10

**NOTED:**

1. SUB-BASE TO BE PROVIDED IF CBR VALUE IS LESS THAN 25% AND THE THICKNESS TO BE DECIDED BY CBR VALUE
2. BASE COURSE CRUSHER RUN STONES SHALL COMPLY WITH THE FOLLOWING GRADING UNITS.

BS SIEVE SIZE	% BY WEIGHT PASSING
2"	100
1 1/2"	95-100
3/4"	60-80
3/8"	40-60
3/16"	25-40
No.7	15-30
No.25	8-22
No.200	5-12

3. WEARING COURSE TO BE 75mm THK. COMPACTED ASPHALTIC CONC. PREMIX (A.C.W 14)
4. A MECHANICAL PAVER SHALL BE USED TO LAY THE PREMIX MATERIAL
5. VIBRATORY ROLLERS TO USED FOR COMPACTION IN ROADWORKS.

**MAJLIS DAERAH GERIK**  
NO. RUJ. CSC 1064/CSG/2020-16/ A11-1  
NO. RUJ. JP 10/15/2020/1064/CSG/2020-16/ A11-1  
NO. PELAN PERAK 61 PASIR PELAK  
SIL /TARIKH 7/20/20 23 NOVEMBER 2020  
MESYUARAT 23 NOVEMBER 2020  
PELAN JALAN DAN PARTI INI DIPERAKUI TELAH MEMATUHI KEPERLUAN YANG DITETAPKAN [RUJUK SYARAT PEMATUHAN KELULUSAN]  
**DILULUSKAN**  
Di Bawah Subseksyen 9(2) Akta Jalan, Partit Dan Bangunan 1974 (Akta 139)  
Yang Dipertua  
Majlis Daerah Gerik  
TARIKH DIBERIKAN  
TARIKH LUPUT  
SEMUA PELAN UNTUK MENBUAT SESUATU JALAN BAHARU YANG TELAH DILULUSKAN HENDAKLAH TAMAT APABILA BERAKHIR SATU TAHUN MELAINKAN SESUATU PEMBAHARUAN BAGI KELULUSAN ITU DIBERIKAN OLEH PIHAK BERKUALA PEMATUHAN [SYEKSYEN 10, (AKTA 133)]

PROJECT :  
**CADANGAN JALAN DAN PERPARTAN  
BAGI SKIM PERUMAHAN DI ATAS  
LOT 1396 DAN LOT 1625,  
MUKIM GERIK, DAERAH HULLU PERAK,  
PERAK DARUL RIDZUAN. UNTUK  
ASIA BINA IDAMAN SDN. BHD.**

OWNER SIGNATURE :

*(Signature)*  
ASIA BINA IDAMAN SDN. BHD.  
(No. Syarikat : 872920-D)

ADDRESS : NO. 26, JALAN SEMARAK 1,  
TAMAN SEMARAK, 33300 GERIK,  
PERAK DARUL RIDZUAN.

SUBJECT :

STANDARD DETAILS

(KELULUSAN PELAN JALAN & PERPARTAN)

**PYK CONSULTANT**

CIVIL & STRUCTURAL ENGINEERS  
MAN OFFICE:  
No. 28B, JALAN CHUNG AH MING, PASIR PUTEH,  
31650 IPOH, PERAK DARUL RIDZUAN.  
TEL : 05-3221288 FAX : 05-3229298  
SITE OFFICE:  
No. 37, FIRST FLOOR, JALAN TEB 5,  
TAPING BUSINESS CENTRE, 34000 TAPING, PERAK DARUL RIDZUAN.  
TEL : 012-5121138

SCALE 1 : 750

DATE 10/2020

SHEET 3/4

DRAWN BY AYA

CHECKED BY TANG

ENGINEER SIGNATURE :

I certify that the design for the complete set of drawings follows the Urban Stormwater Management Manual For Malaysia (Manual Saliran Mearu Alam Malaysia) by the Department of Irrigation and Drainage Malaysia, 2000. I will full responsibility for the design and supervision of the works. If it is found the proposed drain is too small, the developer will have to enlarge the drain section accordingly so that there will not be any local flooding in this housing scheme.

**PROFESSIONAL ENGINEER**  
CIVIL  
Ir. PANG YOON KHONG  
C114574  
MALAYSIA

Ir. Pang Yoon Khong  
B.Eng.(Hons.),J.M.S., M.T.M., P.Eng.  
(Principal)

DRAWING NO :  
PYK/ABI(LOT1396)/20 (RD)

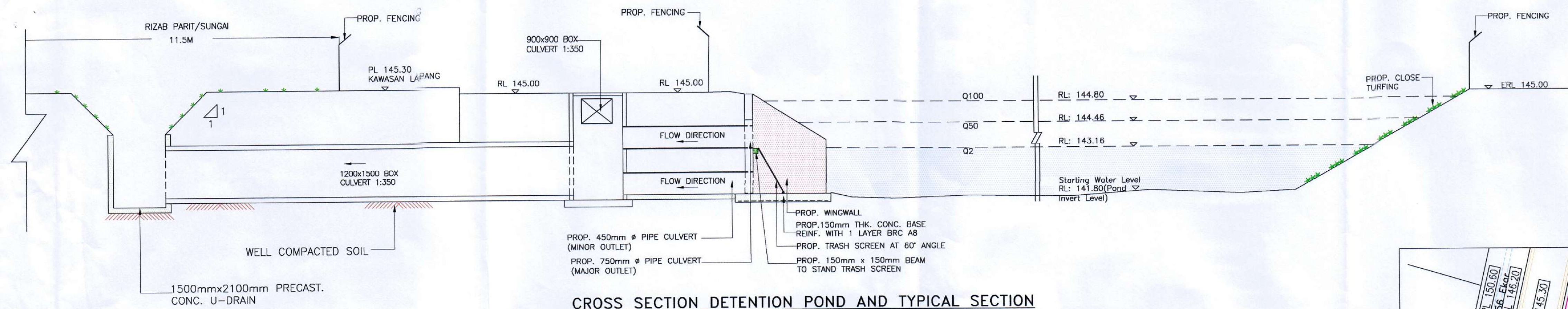

**CROSS SECTION DETENTION POND AND TYPICAL SECTION  
OUTLET DETENTION POND (SECTION Z-Z)**  
SCALE : NTS

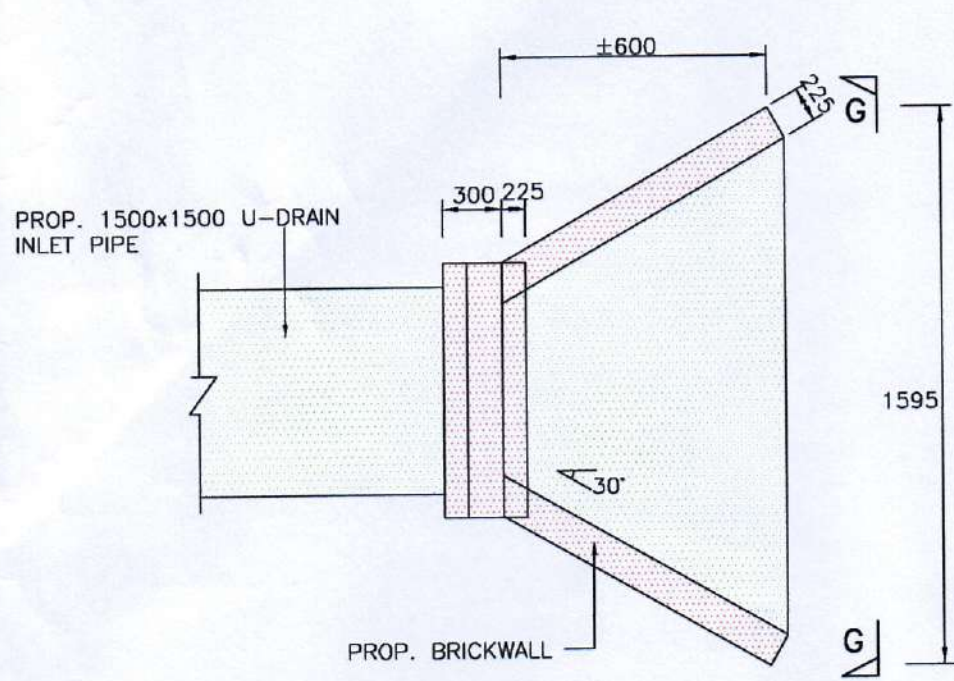

**TYPICAL PLAN VIEW OF BRICKWALL  
INLET STRUCTURE TO DETENTION POND**  
(NOT TO SCALE)

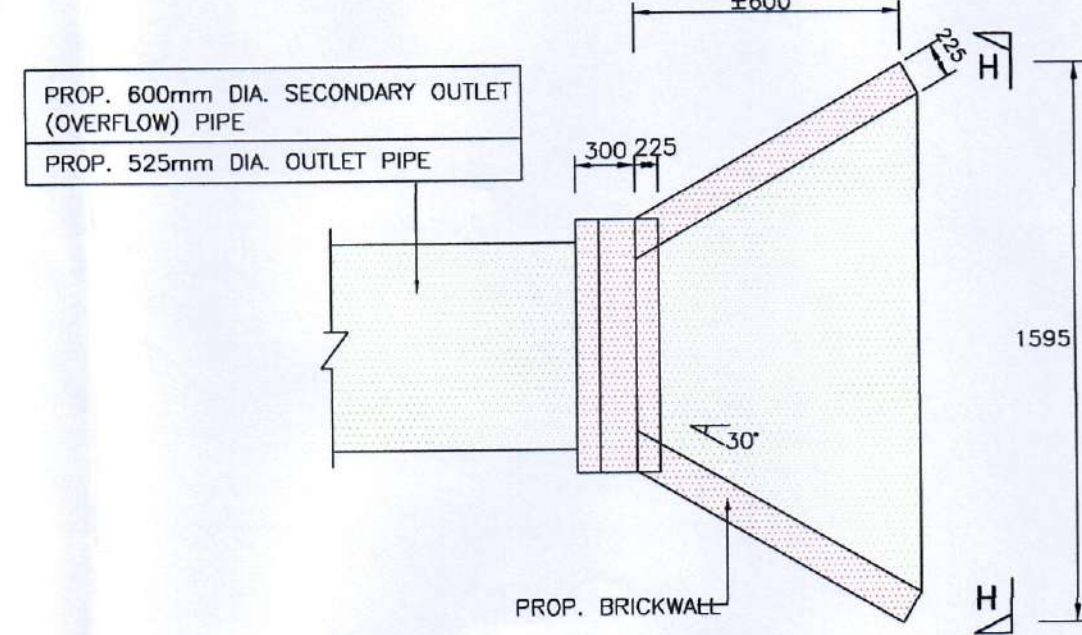

**TYPICAL PLAN VIEW OF BRICKWALL  
OUTLET STRUCTURE TO MONSOON DRAIN**  
(NOT TO SCALE)

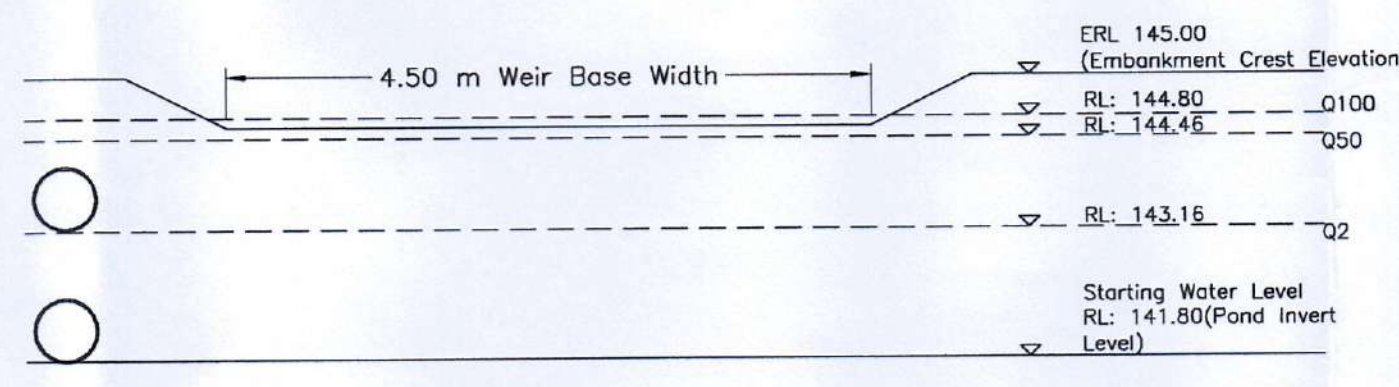

**WATER PROFILE FOR OUTLET DETENTION DRAIN**  
SCALE 1:750

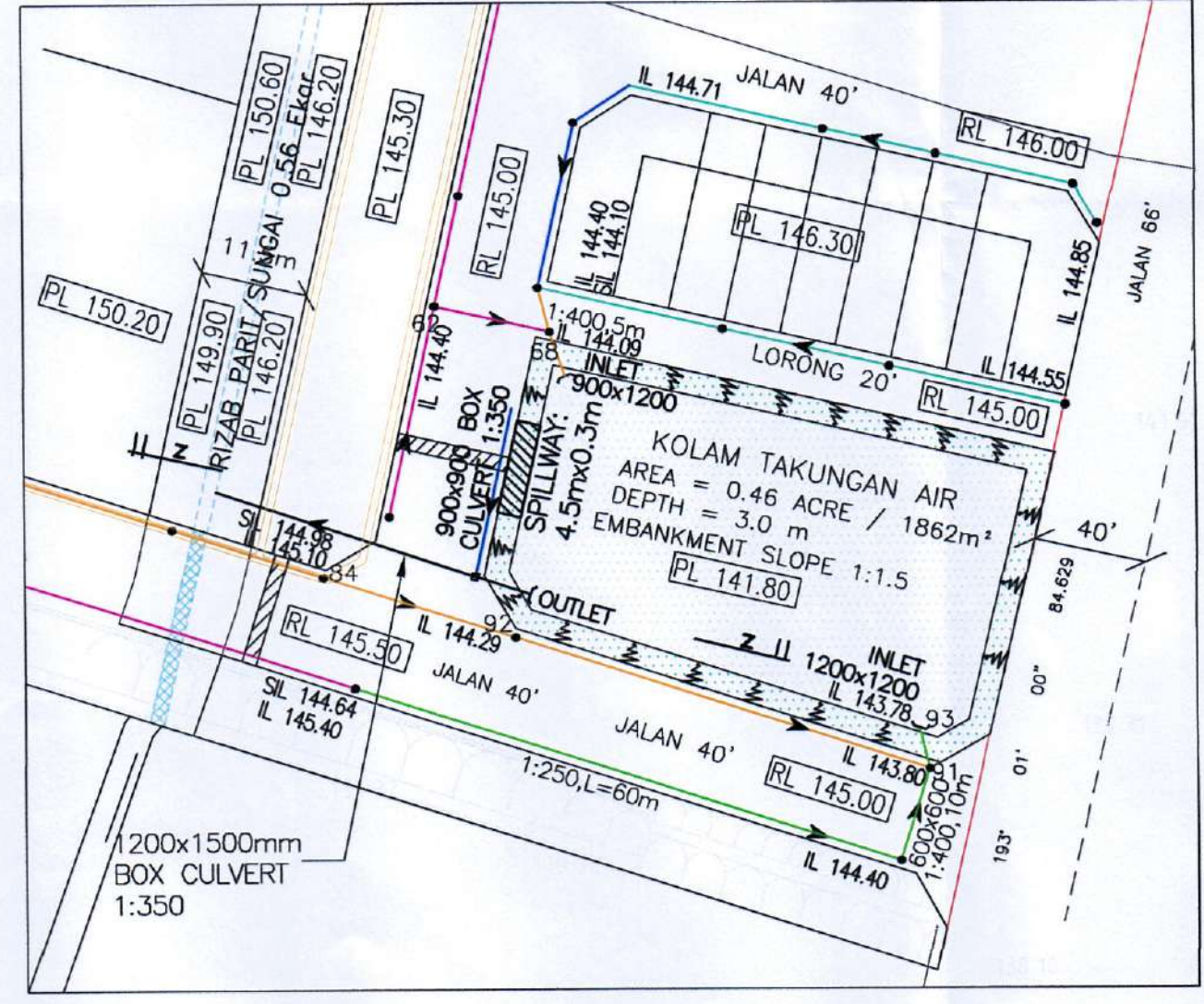

**VIEW OF DETENTION POND**  
SCALE 1:1000

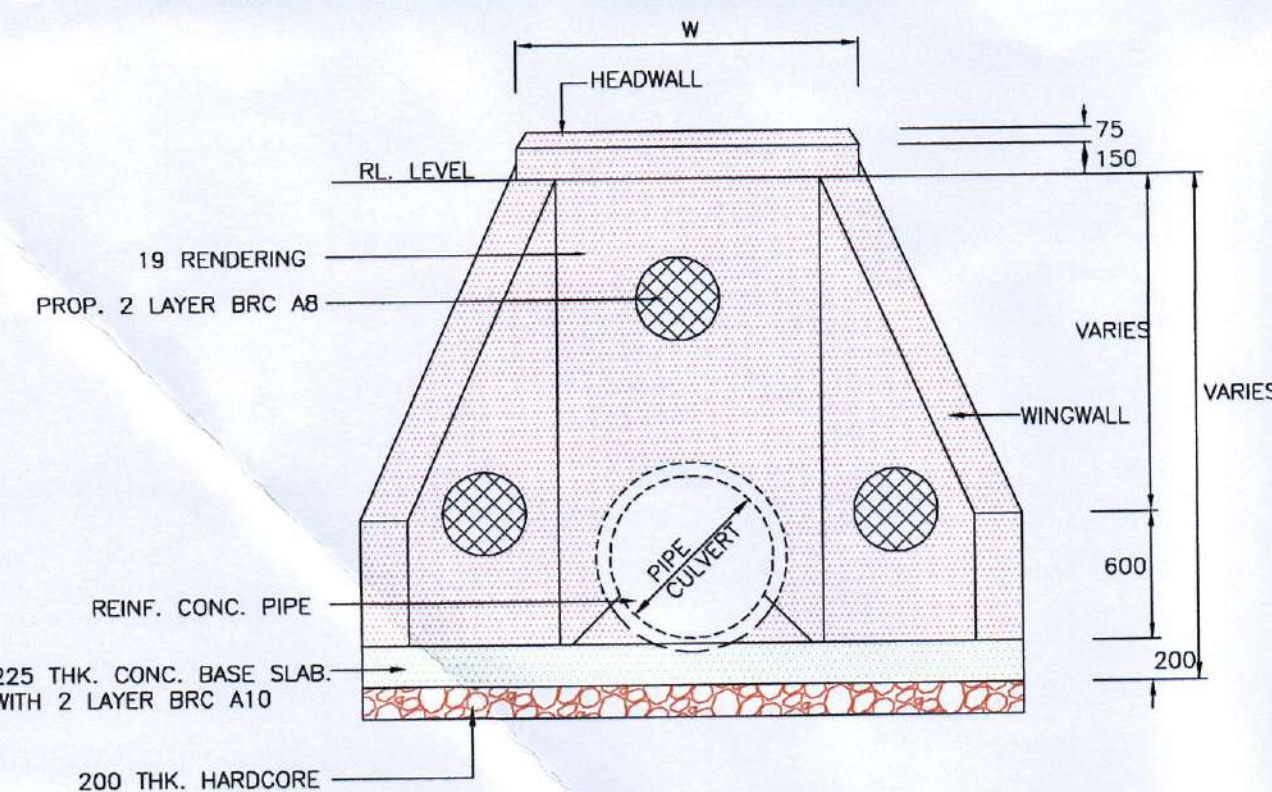

**INLET DETENTION POND/  
SECTION G-G**  
SCALE : NTS

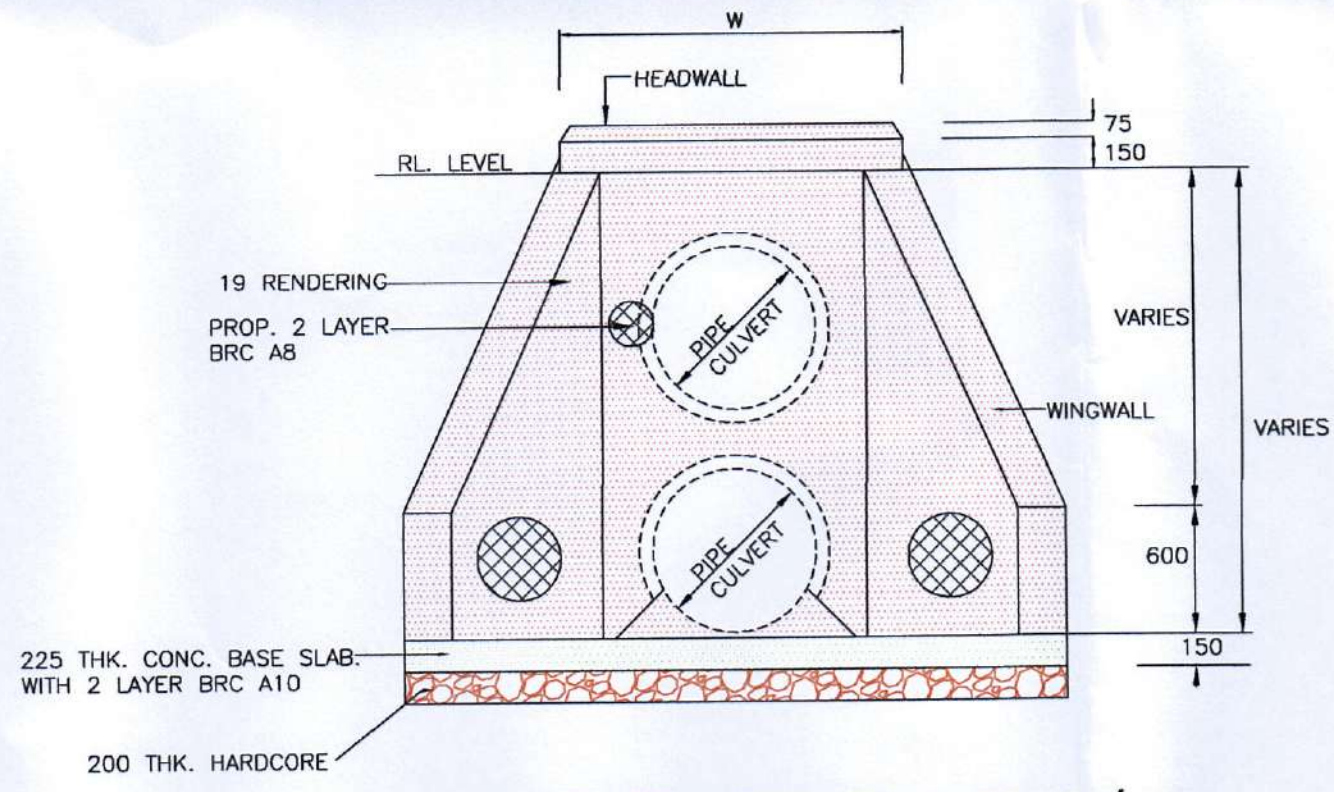

**OUTLET DETENTION POND/  
SECTION H-H**  
SCALE : NTS

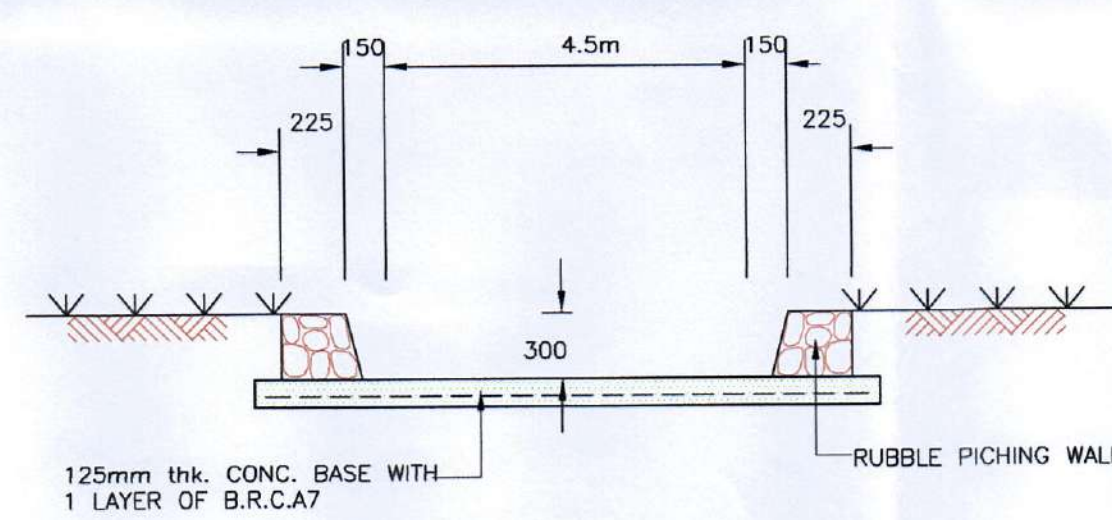

**SECTION S-S (SPILLWAY POND)**  
SCALE : NTS

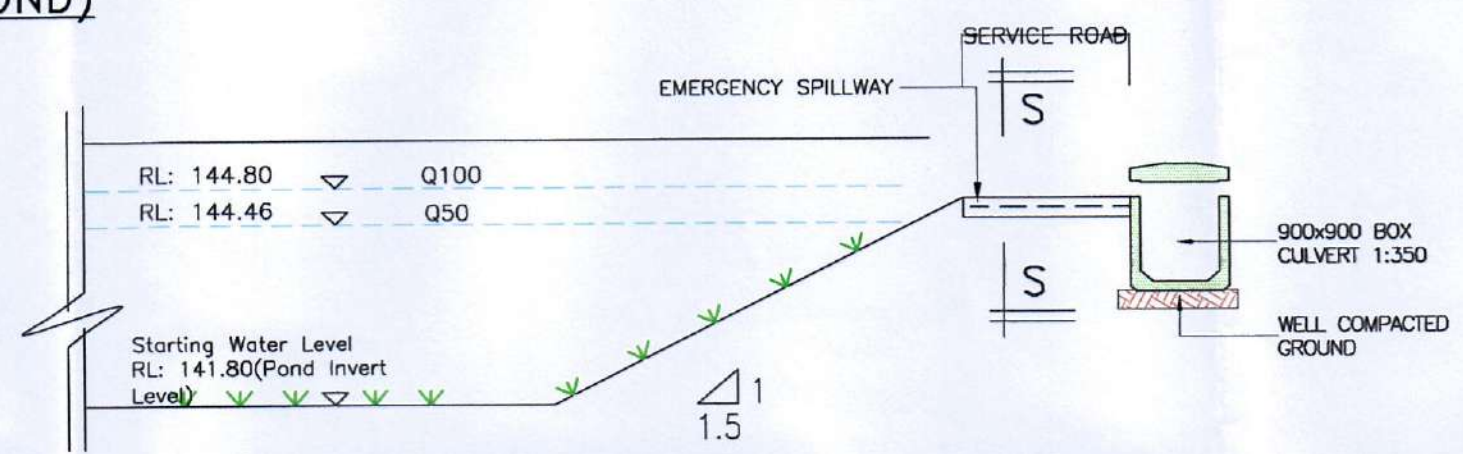

**EMERGENCY SPILLWAY (DETENTION POND)**  
SCALE : NTS

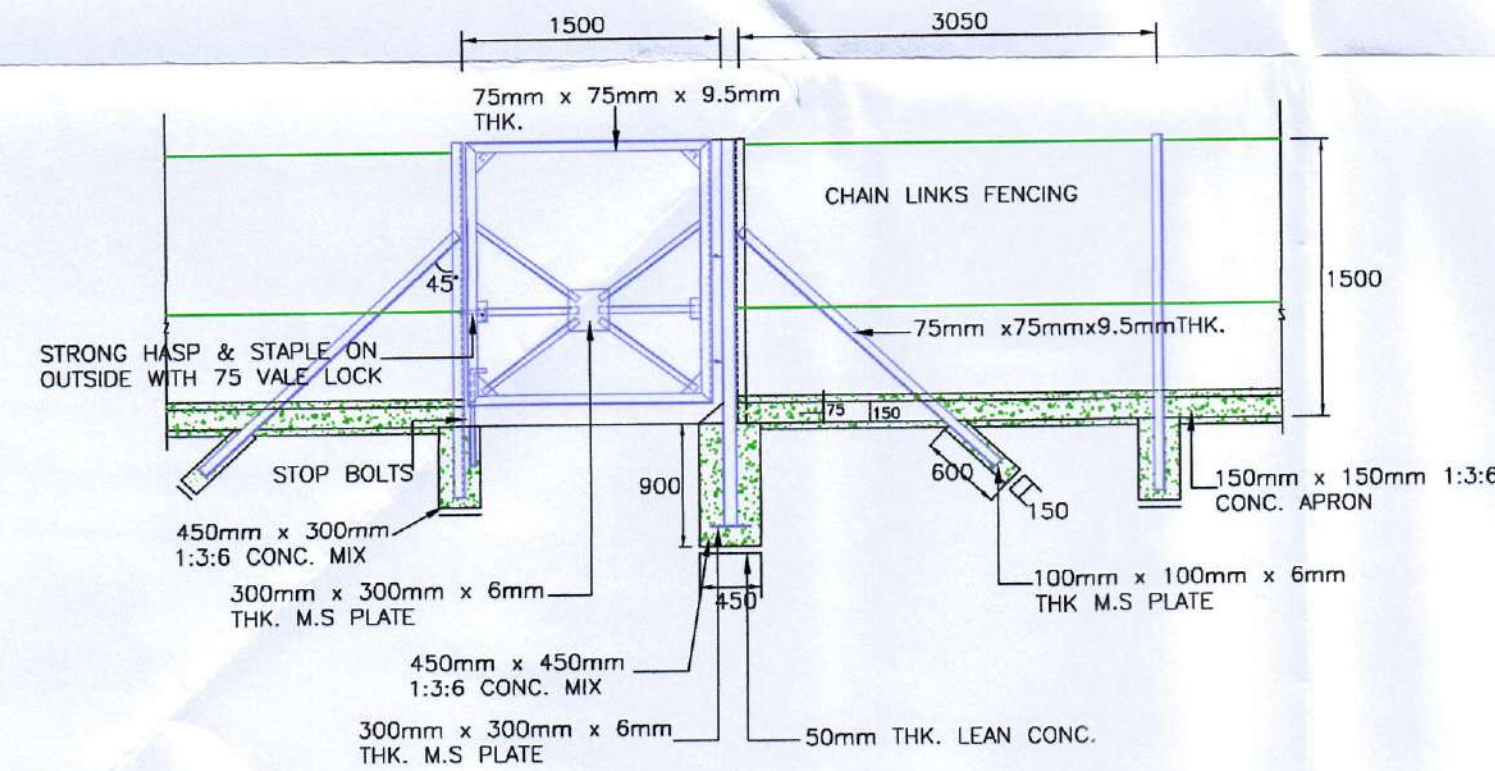

**DETAILS OF GATE AND FENCING AT DETENTION POND**  
SCALE : NTS

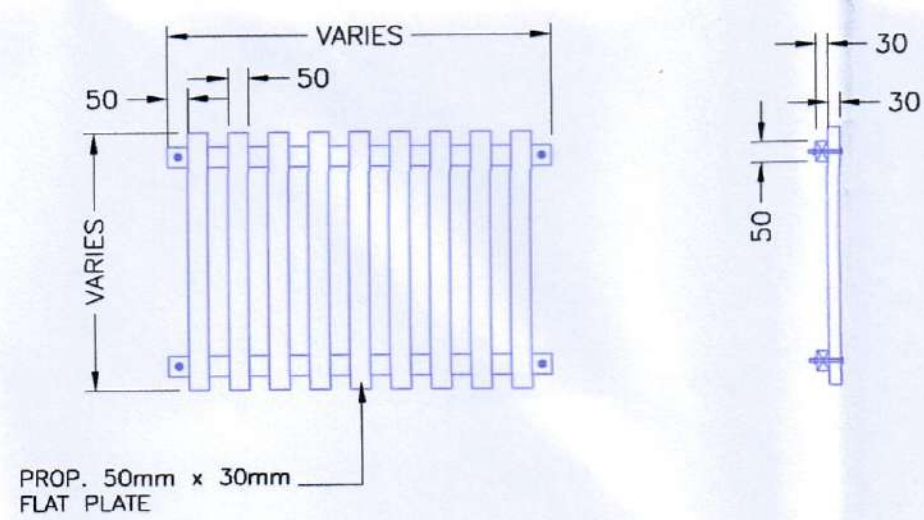

**DETAIL OF TRASH SCREEN**  
SCALE 1:750



**TYPICAL OSD ADVISORY SIGN (UPRCT, 1999)**  
SCALE : NTS  
Colours:  
Triangle and "WARNING" - Red  
Water - Blue  
Figure and other lettering - Black

**MAJLIS DAERAH GERIK**  
NO. RUJ. OSC MAB/OS/1920-16/BI-1  
NO. RUJ. JP Bt (G)19/ANP/Kej/Am/58/19-200/1 Puc  
NO. PELAN RUMAH TANI DI BINS PELAN  
BIL / TARIKH MAB-OS BIL 09/10/20  
MESYUARAT 22 NOVEMBER 2020  
PELAN JALAN DAN PARIT INI DIPERAKUI  
TELAH MEMATUHI KEPERLUAN YANG  
DITETAPKAN  
**[RUJUK SYARAT PEMATUHAN KELULUSAN]**  
**DILULUSKAN**  
Di Bawah Sukeksyen 9(2)  
Akta Jalan, Parit Dan Bangunan 1974  
(Akta 133)  
*[Signature]*  
Yang Dipertua  
Majlis Daerah Gerik

TARIKH DIBERIKAN  
TARIKH LUPUT  
SEMUA PELAN UNTUK MEMBUAT SESUATU JALAN  
BAHARU YANG TELAH DILULUSKAN HENDAKLAH  
TAMAT APABILA BERAKHIR SATU TAHUN  
MELAKSANAKAN SESUATU PEMBAHARUAN BAGI  
KELULUSAN ITU DIBERIKAN OLEH PIHAK  
BERKUALA TEMPATAN [SYEKSYEN 10, (AKTA 133)]

PROJECT :  
CADANGAN JALAN DAN PERPARTAN  
BAGI SKIM PERUMAHAN DI ATAS  
LOT 1396 DAN LOT 1625,  
MUKIM GERIK, DAERAH HULU PERAK,  
PERAK DARUL RIDZUAN. UNTUK  
ASIA BINA IDAMAN SDN. BHD.

OWNER SIGNATURE :  
*[Signature]*  
ASIA BINA IDAMAN SDN. BHD.  
(No. Syarikat : 872920-D)  
ADDRESS : NO. 26, JALAN SEMARAK 1,  
TAMAN SEMARAK, 33300 GERIK,  
PERAK DARUL RIDZUAN.

SUBJECT :  
STANDARD DETAILS  
(KELULUSAN PELAN JALAN & PERPARTAN)  
**PYK CONSULTANT**  
CIVIL & STRUCTURAL ENGINEERS  
MAIN OFFICE:  
NO. 258, JALAN CHUNG AH MING, PASIR PUTIH,  
31850 IPH, PERAK DARUL RIDZUAN.  
TEL : 05-3221298 FAX : 05-3229298  
SITE OFFICE:  
NO. 37, FIRST FLOOR, JALAN TIC 5,  
TAPING BUSINESS CENTRE, 34000 TAPING, PERAK DARUL RIDZUAN.  
TEL : 012-5121138

SCALE : 1 : 750  
DATE : 10/2020  
SHEET : 4/4  
DRAWN BY : AYA  
CHECKED BY : TANG  
ENGINEER SIGNATURE :  
I certify that the design for the complete set of drawings follows the  
Urban Stormwater Management Manual For Malaysia (Manual Soliran  
Muar Alam Malaysia) by the Department of Irrigation and Drainage  
Malaysia, 2000. I will full responsibility for the design and supervision  
of the works. If it is found the proposed drain is too small, the  
developer will have to enlarge the drain section accordingly so that  
there will not be any local flooding in this housing scheme.  
*[Signature]*  
PROFESSIONAL ENGINEER  
WITH PRACTISING CERTIFICATE  
CIVIL  
IR. PANG YOON KHONG  
C114574  
MALAYSIA  
Ir. Pang Yoon Khong  
B.Eng.(Hons.),M.S., M.IEM, P.Eng.  
(Principal)