

Cadangan Pembangunan	Unit	Penduduk Setara	Jumlah
Hotel Rooms (Sediada)	54	4/ room	216
Service Apartments (Sediada)	24	5/ house	120
Jumlah Besar			336

**SAMBUNGAN KE RANGKAIAN PAIP PIHAK JPP (IPH-611)**  
(Projek Loji Rawatan Kumbahan Serantau & Rangkaian Paip Pembetulan di PAPAN 1)

- Dari Jadual 5-2: (MSIG Volume 1, Planning Principles and Tools\_2025)
- Jumlah Keseluruhan PE = 336 PE
- Alliran kumbahan ini akan disambungkan ke rangkaian paip yang dibina oleh pihak JPP (Projek Loji Rawatan Kumbahan Serantau & Rangkaian Paip Pembetulan di PAPAN 1).

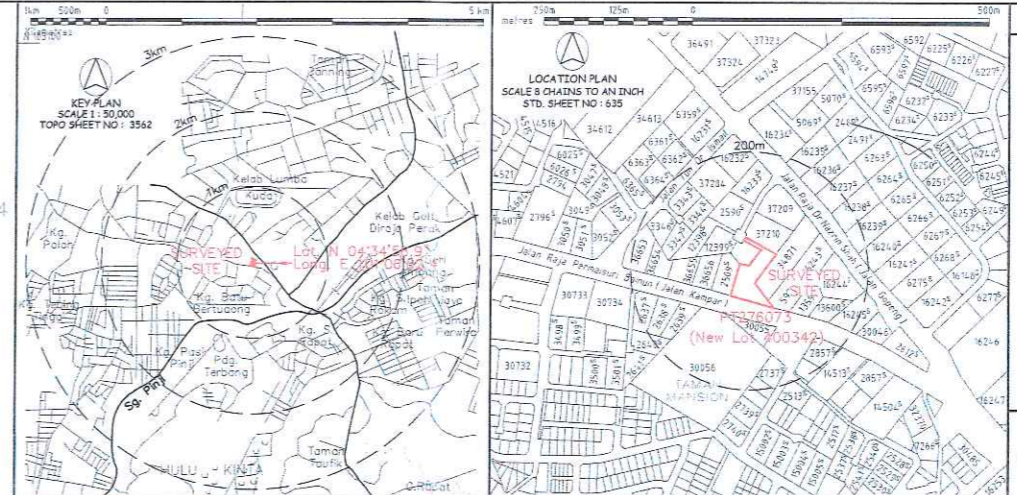

IWK/C/PK.01/25/0129

AGENCI PERAWAN - PEMBTUNGAN (IPHS) NO. 25

PELAN-PELAN UNTUK MEMBINA REKABENTUK SISTEM PEMBTUNGAN ADALAH

**DILULUSKAN**

BERSEKUTUAN KEPADA PERUBAHAN TERTAKUT (PERUB) JURUTERA PROFESIONAL BERKENAAN DAN TERHADAP KESAPA BERSEKUTUAWAN BAL. No. 16

DI DALAM PAIP IWK/C/PK.01/25/0129

1) KELULUSAN ASAL  
2) PINDAN PERTAMA  
3) PINDAN KEDUA

Pij

Pengarah Agensi Perawanan Pembetulan Perak Darul Ridzuan (dibantu oleh SPAN)

Tarikh: 11/11/20

KELULUSAN NI TIDAK TERMASUK REKABENTUK STRUKTUR KEAJURUTERAAN

- Note:
- FOLLOWING DESIGN ARE BASED ON CODE OF PRACTICE FOR DESIGN AND INSTALLATION SEWERAGE SYSTEMS MALAYSIA STANDARD M.S. 1228.1:1991.
  - THE MINIMUM SIZE OF FOUL SEWERS TO BE TAKEN OVER SHALL BE 9" (225 mm) DIAMETER.
  - THE MINIMUM SIZE OF DOMESTIC CONNECTIONS TO THE PUBLIC SEWER SHALL BE 6" (150mm) DIAMETER.
  - THE MINIMUM DEPTH OF MANHOLE INVERT SHALL BE 4' 0" (1.2m).
  - THE MINIMUM GRADIENT BETWEEN MANHOLES SHALL BE AS FOLLOW:-  
 PROPOSED 225 mm DIAMETER V.C PIPE. EXISTING 225 mm DIAMETER V.C PIPE. EXISTING 900 mm DIAMETER R.C PIPE.
  - ALL VETRIFIED CLAY PIPES (V.C. PIPES) SHALL BE IN ACCORDANCE WITH B.S.65 1981/1988 (SPECIFICATION VETRIFIED CLAY PIPES FITTINGS AND JOINTS) AND SHALL BE APPROVED BY SIRIM MINISTRY OF HEALTHY AND LOCAL COUNCIL OR H.D.P.E DOUBLE WALL CORRUGATED SEWER PIPE SYSTEM.
  - CONTRACTOR/DEVELOPER IS TO OBTAIN FROM WSIA/PDC 6 (NOTICE OF COMMENCEMENT OR RESUMPTION OF SEWERAGE WORKS) AND FROM WSIA/PDC 7 (NOTICE OF INSPECTION AND TESTING) FROM CONSULTANT ENGINEER PRIOR TO COMMENCEMENT OF CONSTRUCTION WORKS.
  - PAIP - PAIP YANG MERENTANGI PARIT HENDAKLAH DITUKARKAN DENGAN DUCTILE IRON PAIP.

Land Owner's Signature:

HEADLINES INTERNATIONAL SDN. BHD.  
(Company No. : 954473-X)

*Wong Yoke Shin*

NAME : WONG YOKE SHIN  
IC NO. : 710605-08-5827  
ADDRESS : 55A, JALAN LAPANGAN SIBER 6, BANDAR CYBER, 31350 IPOH, PERAK

Owner's Signature:

HEADLINES REAL ESTATE MANAGEMENT SDN. BHD.  
(Company No. : 1277196-H)

*Wong Cheng Choy*

NAME : WONG CHENG CHOY  
IC NO. : 691211-08-5995  
ADDRESS : 55A, JALAN LAPANGAN SIBER 6, BANDAR CYBER, 31350 IPOH, PERAK

Project Title:

CADANGAN SALURAN PEMBTUNGAN BAGI CADANGAN PEMBANGUNAN BERCAMPUR (PANGSAPURI SERVIS DAN HOTEL) DI ATAS LOT 2510s (GRN 53700), LOT 14698s (PN 147171) DAN LOT 14699s (PN 147169), BANDAR IPOH [S], DAERAH KINTA, PERAK DARUL RIDZUAN. LOKASI: KPP (PB) YANG MERANGKUMI:

a) 1/2 TINGKAT BASEMENT KEPADA TIADA BASEMENT.  
b) 8 TINGKAT HOTEL DAN PANGSAPURI SERVIS (54 UNIT) KEPADA 8 TINGKAT HOTEL DAN PANGSAPURI SERVIS (24 UNIT), DI JALAN TUANKU BAINUN (JALAN KAMPAR)

UNTUK TETUAN: HEADLINES INTERNATIONAL SDN BHD

Sub Title:

PELAN TATATUR  
PELAN LOKASI  
PELAN KUNCI

Engineer's Signature:

*Hui Wei Tuck*

**PERUNDING MANH SDN BHD** (1332455-W)  
CONSULTING ENGINEERS / JURUTERA PERUNDING  
No. 10, Jalan Chew Boon Juan,  
30250 Ipoh, Perak Darul Ridzuan.  
Tel / Fax : 05-210 0818  
E-mail: manh.ip@yahoo.com

I hereby certify that these works have been designed by me in accordance with sound engineering practice and that I take full responsibility for the design and proper performance of the same.

DESIGNED BY	Juanhao	SCALE	1: 500
CHECKED BY	Ir. Hui Wei Tuck	DATE	12-12-2026
DRAWN NO:	HI/2547/SEW	SHEET NO:	SE1/2

