

Scale 1 : 1000

Nota : 1) Semua dimensi dalam meter
2) Diketahui, Jalan Ipoh - Puncak Di Hutan
Balai Polis Kluang.
BERICHTAAR :
Semua ukuran dalam unit meter dan semua area berdasarkan dari
BM 40134 (RL 42.15m) di dalam Jalan Ipoh - Puncak di Hutan
Balai Polis Kluang.

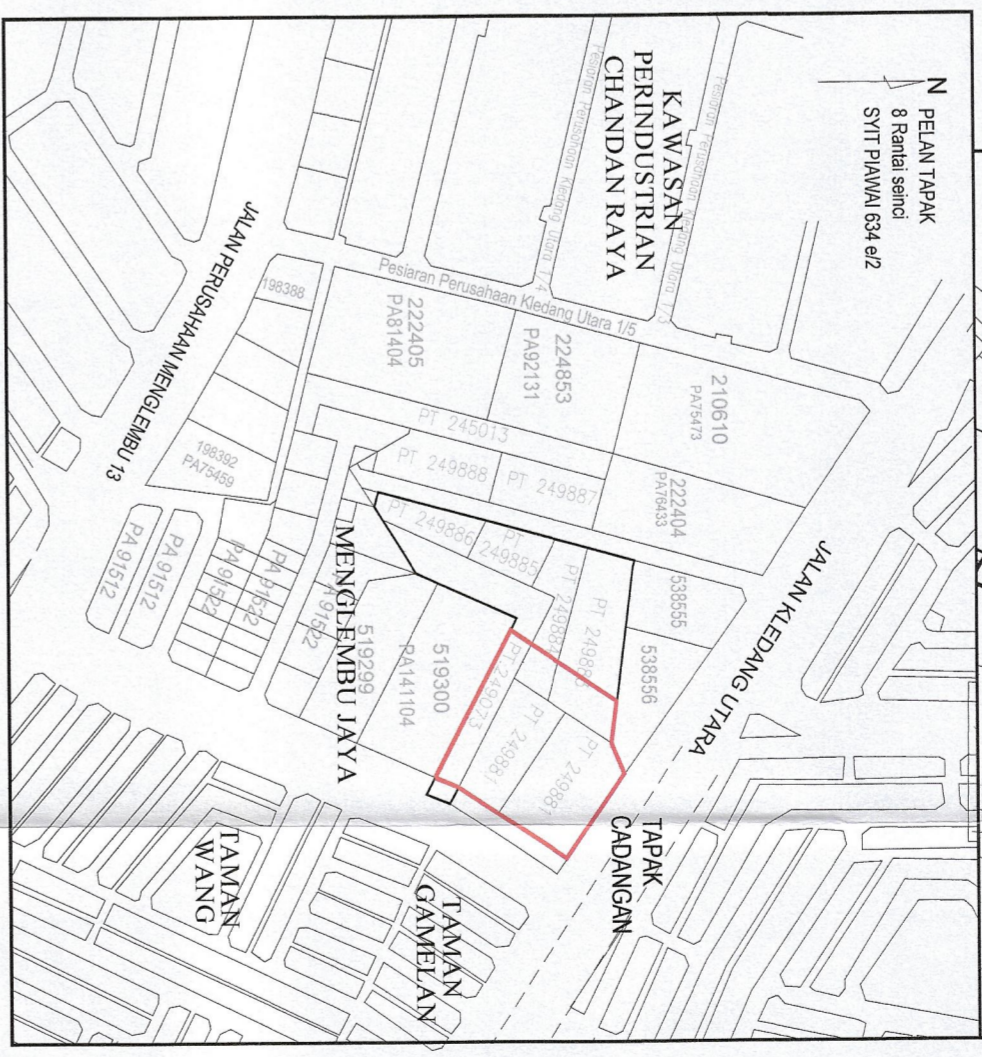
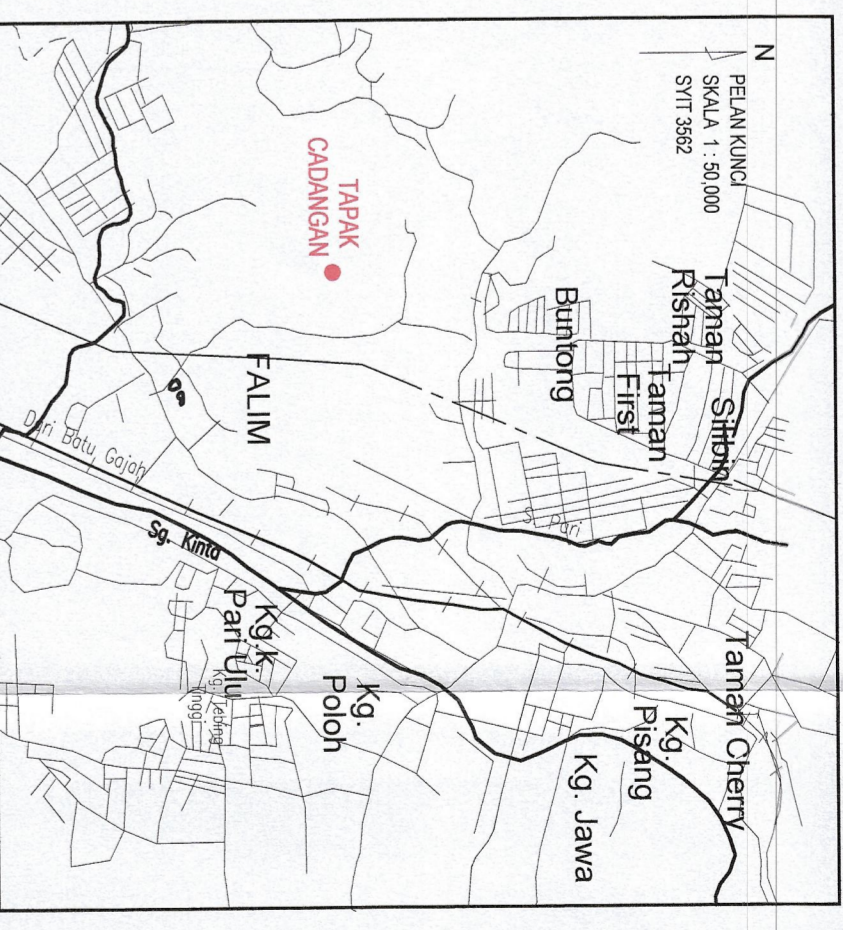

Cadangan Pembangunan	Unit	Pengandaik	Jumlah
Kompleks Permagan (Econsave)	1	282	282
Jumlah penduduk selama = 1000 x 8.735 00m ² = 282			
Jumlah			282

- SAMBUNGAN KE LOJI RAWATAN KUMBUHAN SEDADA**
- Duti Jadual 4.1 (Sewerage Treatment Plant Volume 4)
 - Jumlah Keseluruhan PE = 282 pe
 - Reka bentuk PE : 12.254 pe
 - PE yang Sedada : 11.885 pe
 - 569 pe > 282 pe (overcapacity)
 - Aliran kumbahan dari tapak cadangan ini akan mengalir ke loji rawatan kumbahan sedada di Taman Bandar Baru, Mergelambou (PH 154).

INDIA WATER KONSORTIUM S.M. BHD.
SKALA 1 : 30,000
SITI 382
SITI PAVANA S4 42

DILULUSKAN

PERALIHAN TITIK TANDA
REBAH BENTUK STRUKTUR/KELOMPOKAN

Agensi Penguatkuasaan
Pembinaan Tanah Awam
Kluang
SITI 382
SITI PAVANA S4 42

- NOTE:
- 1) FOLLOWING DESIGN ARE BASED ON CODE OF PRACTICE FOR DESIGN AND INSTALLATION SEWERAGE SYSTEMS MALAYSIA STANDARD M.S. 1238:1991.
 - 2) THE MINIMUM SIZE OF FOLI SEWERS TO BE TAKEN OVER SHALL BE 9" (225 mm) DIAMETER.
 - 3) THE MINIMUM SIZE OF DOMESTIC CONNECTIONS TO THE PUBLIC SEWER SHALL BE 4" (100mm) DIAMETER.
 - 4) THE MINIMUM DEPTH OF MANHOLE INVERT SHALL BE -4' - 0" (1.2m).
 - 5) THE MINIMUM GRADIENT BETWEEN MANHOLES SHALL BE AS FOLLOW:-
 PROPOSED 225 mm DIAMETER VC PIPE
 EXISTING 225 mm DIAMETER VC PIPE
 - 6) ALL VENTED C.V. PRESSURE PRESS SHALL BE IN ACCORDANCE WITH BS.65 1987/1988 SPECIFICATION. VENTED CLAY PIPES FITTINGS AND JOINTS AND SHALL BE APPROVED BY SIRIM MINISTRY OF HEALTH AND LOCAL COUNCILOR HDPE DOUBLE WALL COMPACTED SEWER PIPE SYSTEM.
 - 7) CONTRACTOR/DEVELOPER IS TO OBTAIN FROM WSA/PPDC (NOTE OF COMMENCEMENT OR RESUMPTION OF SERVICES WORKS) FROM CONSULTANT ENGINEER PRIOR TO COMMENCEMENT OF CONSTRUCTION WORKS.
 - 8) PAIP TRAP YANG MERENTANGI PARTI HENDAKKAH DITUKARKAN DENGAN DUCTILE IRON PAIP.

The Actual East House Manhole position shall follow the Architectural Layout.

Developer's Signature
HYPERGAN SDN BHD
(No. Syarikat : 332888-D)

Project Title:
NAME : CHIN CHAN WA
ICNO : 42072-08-5983
ADD : JALAN LAMATI
30200 POH, RIQUAN
SEKANG, JOHOR
TEL : 05-254 4279
FAX : 05-254 1001

Site Title:
SITE PLAN
LOCATION PLAN

Engineer's Signature:
IR. MA WEE EEF
(No. Syarikat : 332888-D)

I hereby certify that these works have been designed by me in accordance with sound engineering practice and that I accept full responsibility for the design and proper performance of the same.

PERUNDING MANH SDN BHD
CONSULTING ENGINEERS/JURUTERA PERUNDING
30200 POH, RIQUAN
SEKANG, JOHOR
Tel / Fax : 05-210 0818
E-mail : manh@perund.com
SST / AIC/201/52/10083

DESIGNED BY : Izzah
DRAWN BY : Izzah
CHECKED BY : Izzah
SCALE : 1 : 1000
DRAWING NO : H/2026/H
SET/2

