

**ROAD AND DRAINS WORKS CHECKLIST FOR INTERIM FOR PROGRESS CLAIMS**

ITEM	WORK ITEM	WORKS DESCRIPTION
1.	ROADS	<input type="checkbox"/> Materials Approval
		<input type="checkbox"/> Compaction Test
		<input type="checkbox"/> C.B.R. Test ( _ Nos)
2.	DRAINS	<input type="checkbox"/> Materials Approval
		<input type="checkbox"/> Interim As-built Levels
		<input type="checkbox"/> Interim As-built I.L.'s

**ROAD AND DRAINAGE WORKS CHECKLIST AS-BUILT DOCUMENTATIONS FOR C.P.C**

NO.	DESCRIPTION
1.	GENERAL
1.1	Keyplan, Location Plan, Site/Layout Plan.
1.2	TBM Location and R.L.
1.3	all with reference to the Construction Drawing.
2.	AS-BUILT WORKS(BY LICENCED SURVEYOR)
2.1	Drains
	(a) sizes (in different colour legends).
	(b) lengths.
	(c) gradient.
	(d) types.
2.2	I.L of
	(a) sumps.
	(b) culverts.
	(c) drains corners.
	(d) drains at every 50m. straight length.
2.3	Road
	(a) reserve width.
	(b) finished R.L. (location ref. To Construction Drawing).
	(c) pavement line and width.
	Outfall structure (a) layout and I.L.'s
	(b) longitudinal section and for the whole of length of the connecting main drain c/w I.L. at 50m.
3.	DRAFT SUBMISSION
3.1	One (1) set print for checking and/or comments by the Engineer.
4.	FINAL SUBMISSION
4.1	Three (3) set print c/w P.T. No., Building/Unit No., Road Name and Scheme Name ("Taman") and Licenced Surveyor's cop and sign.

**LEGEND :**

- E.R.L=0.00m EXTERNAL ROAD LEVEL
- R.L.=+0.30m ROAD LEVEL
- F.F.L.=+0.45m FINISH FLOOR LEVEL
- PROPOSED 375mmØ PIPE CULVERT (1:250)
- PROP. 150mmØ UPVC PIPE WITH 50mm THK. CONCRETE SURROUND
- PROP. ANTI-CLIMB FENCE
- PROP. INTERNAL PERIMETER ROAD
- PROPOSED 600(W)X600(L)mm BRICKWORKS SUMP

**NO. FAIL MAJLIS BANDARAYA IPOH:**

1. PELAN BANGUNAN
2. PELAN KERJA TANAH
3. PELAN LAMPU JALAN: -

DESIGN MANUAL = MSMA 2ND EDITION  
 METHOD = SIMPLIFIED METHOD  
 TYPE OF DETENTION SYSTEM: OSD BOX CULVERT  
 A.) PROP. -m(W) X -m(H) OSD BOX CULVERT  
 LENGTH= -m VOLUME = -m<sup>3</sup>  
 B.) CONVEYANCE DRAIN STORAGE (-mmØ PIPE CULVERT)  
 LENGTH= -m VOLUME= -m<sup>3</sup>  
 TOTAL SITE STORAGE VOLUME= - m<sup>3</sup>  
 PERMISSIBLE SITE DISCHARGE (PSD) = - 1/s  
 SITE STORAGE REQUIREMENT (SSR) = - m<sup>3</sup>  
 PRIMARY OUTLET PIPE = - NO. OF -mmØ PIPE (ARI 2 YEARS)  
 SECONDARY OUTLET = - NO. OF -mmØ PIPE (ARI 20 YEARS)

**NOTA:-**

1. BUKAN PERMUKA BERSEKUTU MEMBINA PERKAMPARAN KAWASAN BERSEKUTU DAN MEMBINA PERKAMPARAN PERKAMPARAN KAWASAN BERSEKUTU.
2. (a) BUKAN PERMUKA BERSEKUTU PERKAMPARAN PERKAMPARAN BERSEKUTU MELEBIHI 3'-6".
3. BUKAN PERMUKA BERSEKUTU PERKAMPARAN PERKAMPARAN BERSEKUTU MELEBIHI 3'-6".
4. BUKAN PERMUKA BERSEKUTU PERKAMPARAN PERKAMPARAN BERSEKUTU MELEBIHI 3'-6".
5. BUKAN PERMUKA BERSEKUTU PERKAMPARAN PERKAMPARAN BERSEKUTU MELEBIHI 3'-6".
6. BUKAN PERMUKA BERSEKUTU PERKAMPARAN PERKAMPARAN BERSEKUTU MELEBIHI 3'-6".
7. BUKAN PERMUKA BERSEKUTU PERKAMPARAN PERKAMPARAN BERSEKUTU MELEBIHI 3'-6".
8. BUKAN PERMUKA BERSEKUTU PERKAMPARAN PERKAMPARAN BERSEKUTU MELEBIHI 3'-6".
9. BUKAN PERMUKA BERSEKUTU PERKAMPARAN PERKAMPARAN BERSEKUTU MELEBIHI 3'-6".
10. BUKAN PERMUKA BERSEKUTU PERKAMPARAN PERKAMPARAN BERSEKUTU MELEBIHI 3'-6".

KEHENDAK-KEHENDAK DI ATAS AKAN DIPATUHI OLEH PERUNDING / PEMAJU

REVISIONS: 1/1/2024

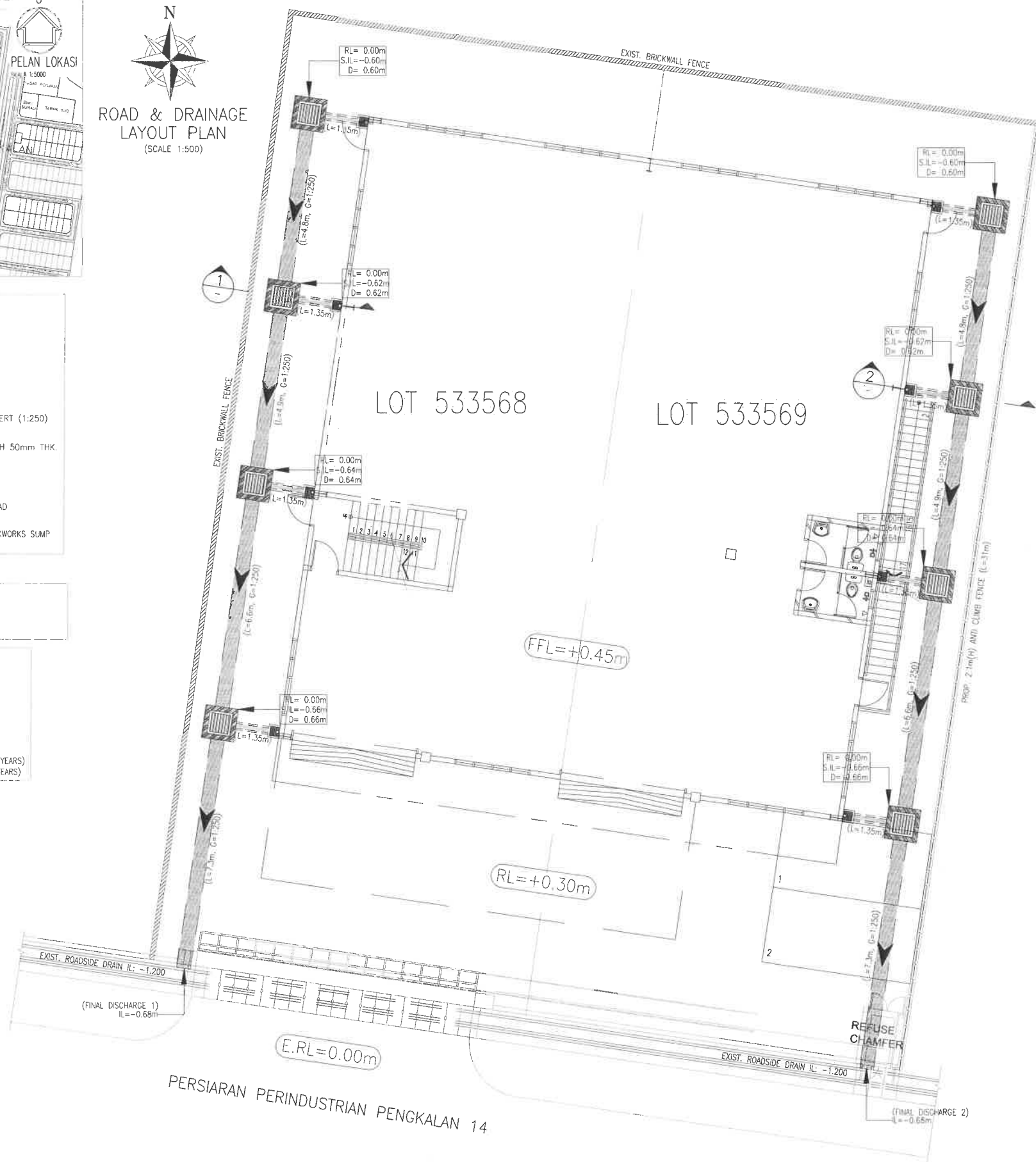

This Drawing is Copyright And Remains The Property Of ISP Consultant And Must Not Be Use / Retained Or Copied Without Written Permission.

DRAWINGS ARE TO BE USED IN CONSTRUCTION WITH ONLY RELATED ARCHITECTURAL, MECHANICAL, ELECTRICAL, INSTRUMENTATION, CIVIL AND ETC.

WITHOUT COMPETENCE WORK ON SITE, CONTRACTOR SHALL CONDUCT A SITE SURVEY TO VERIFY THAT THE EXISTING DRAINAGE LEVELS ARE ACCURATELY MATCH THE DRAWINGS.

ANY DISCREPANCY SHALL BE REPORTED TO THE ENGINEER IMMEDIATELY.

DATE	DESCRIPTION	REV. NO.
<b>AMENDMENT</b>		
<input type="checkbox"/> FOR CONSTRUCTION	<input type="checkbox"/> FOR SUBMISSION	
<input type="checkbox"/> FOR TENDER	<input type="checkbox"/> FOR PRELIMINARY	
<input type="checkbox"/> FOR CLIENT	<input type="checkbox"/> FOR DRAINAGE	
<input type="checkbox"/> FOR APPROVAL/PERMIT	<input type="checkbox"/> FOR APPROVAL/PERMIT	

**PROJECT OWNER :**

NAME: EN. CHAN YEE FAH  
 IC: 570810-08-6059  
 ADDRESS: NO.7 JALAN PENGKALAN PENGKALAN 18, PINGGIR PENGKALAN, PERKAMPARAN 31650 IPOH, PERAK.

NAME: EN. CHAN YEE FAH  
 IC: 570810-08-6059  
 ADDRESS: NO.7 JALAN PENGKALAN PENGKALAN 18, PINGGIR PENGKALAN, PERKAMPARAN 31650 IPOH, PERAK.

**PROJECT TITLE :**

CADANGAN MEMBINA SEBUAH KILANG 1 1/2 TINGKAT YANG MANGANDUNGI RUANG MEMPROSES MAKANAN DAN RUANG PEJABAT DI TINGKAT 1, DI ATAS LOT 533568 DAN LOT 533569, PERSIARAN PERINDUSTRIAN PENGKALAN 14, KAWASAN PERINDUSTRIAN PENGKALAN, LAHAT, DAERAH KINTA, MUKIM HULLU KINTA, IPOH, PERAK DARUL RIDZUAN UNTUK ENCIK KOK CHIN HUAT DAN PUAN TIOW AI HONG.

**ROAD & DRAINAGE**

**DRAWING TITLE :**

- LOCATION PLAN
- KEY PLAN
- ROAD & DRAINAGE SITE PLAN

**CONSULTANT :**

**ISP CONSULTANT**  
 CIVIL & STRUCTURE CONSULTING ENGINEER  
 No. 28A, HALA TASEK TIMOR 42, ANJUNG BERCHAMALITARA, 31400 IPOH, PERAK DARUL RIDZUAN.  
 TEL. : 05-6362127 E-MAIL : info@ispconsult.com.my

**ENGINEER'S SIGNATURE :**

I certify that the design for the complete set of drawings follows the Urban Stormwater Management Manual For Malaysia (Manual Saliran Mesta Alam Malaysia) by the department of irrigation and drainage malaysia, 2000. I will full responsibility for the design and supervision of the works. If it is found the proposed drain is too small, the developer will have to enlarge the drain section accordingly so that there will not be any local flooding in this housing scheme.

(s) CHAN YEE FAH B.Eng (Hons) Civil, P.Eng, M.Eng, M.A.C.E.M., A.A.E.	
DESIGNED BY : YS.CHOK	SCALE : 1:75
DRAWN BY : ADILA	
CHECKED BY : A. Anwarul Clon	
DATE : SEPTEMBER 2024	
DRAWING No. :	REV. :

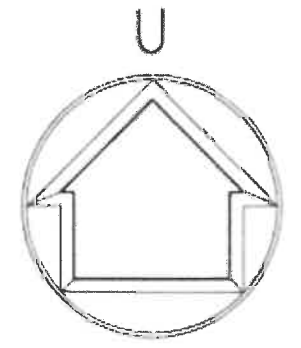

# PELAN LOKASI

SKALA 1:5000

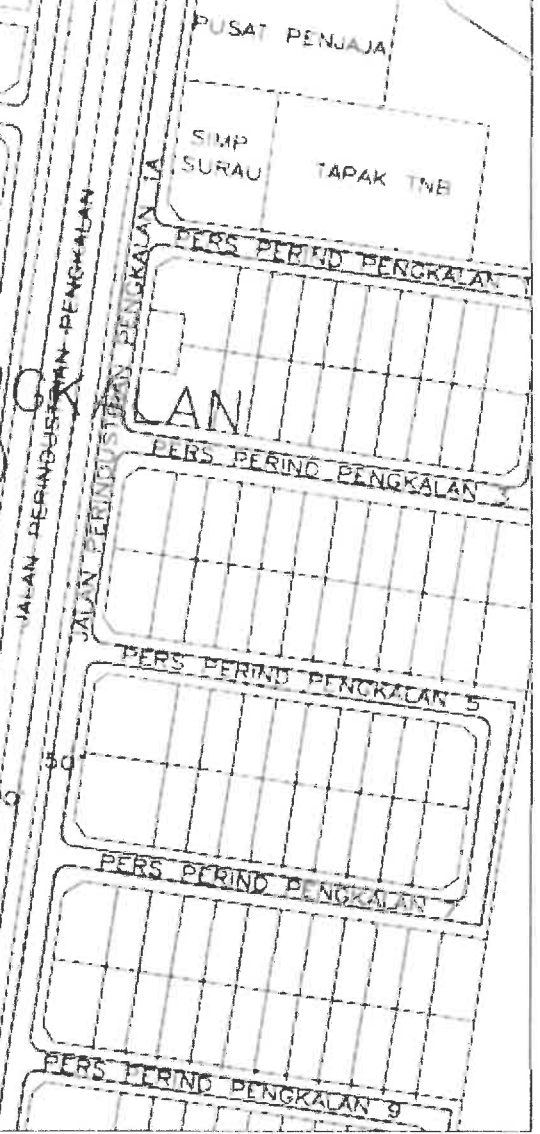



PERSIARAN

P/E INDUSTRI PENGKALAN NO.2

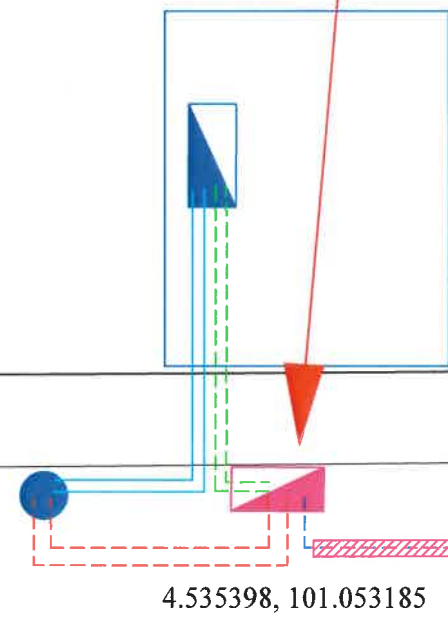

4.535398, 101.053185

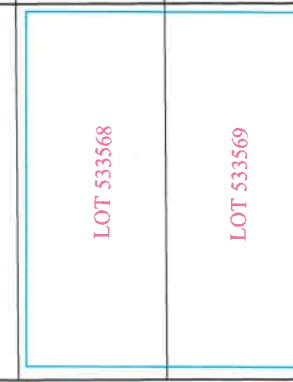

4.535227, 101.054365

PERSIARAN PERINDUSTRIAN PENGKALAN 14

Petunjuk: (Sedia ada)



Peti Pembekal 1600A



Tiang konkrit 9.0m

Kabel B/Tanah VR 185mm x 4 teras XLPE AL (1kV)  
(Rombak Feeder A dan B)

Petunjuk: (Cadangan)



Peti Pembekal 800A



Meter Kiosk

Kabel B/Tanah VR 300mm x 4 teras XLPE AL (1kV)

Kabel B/Tanah VR 185mm x 4 teras XLPE AL (1kV)

Kabel B/Tanah VR 185mm x 4 teras XLPE AL (1kV)



Corrugated 100mm Open Cut Tar (130m)

ALL RIGHTS RESERVED  
LUKISAN INI TIDAK BOLEH DIUBAHSAJAI  
TANPA KEBENARAN DARI JURUTERA  
TENAGA NASIONAL BERHAD



Kawasan IPOH Daerah  
No. Fail : 11000935899

KOK CHIN HUAT

Pindaan	Dilukis : SHAKIR	Diluluskan : IKRAM
	Disemak : ZAINI	Tarikh : 08/06/25
	No. Lukisan :	