

PELAN KUNCI

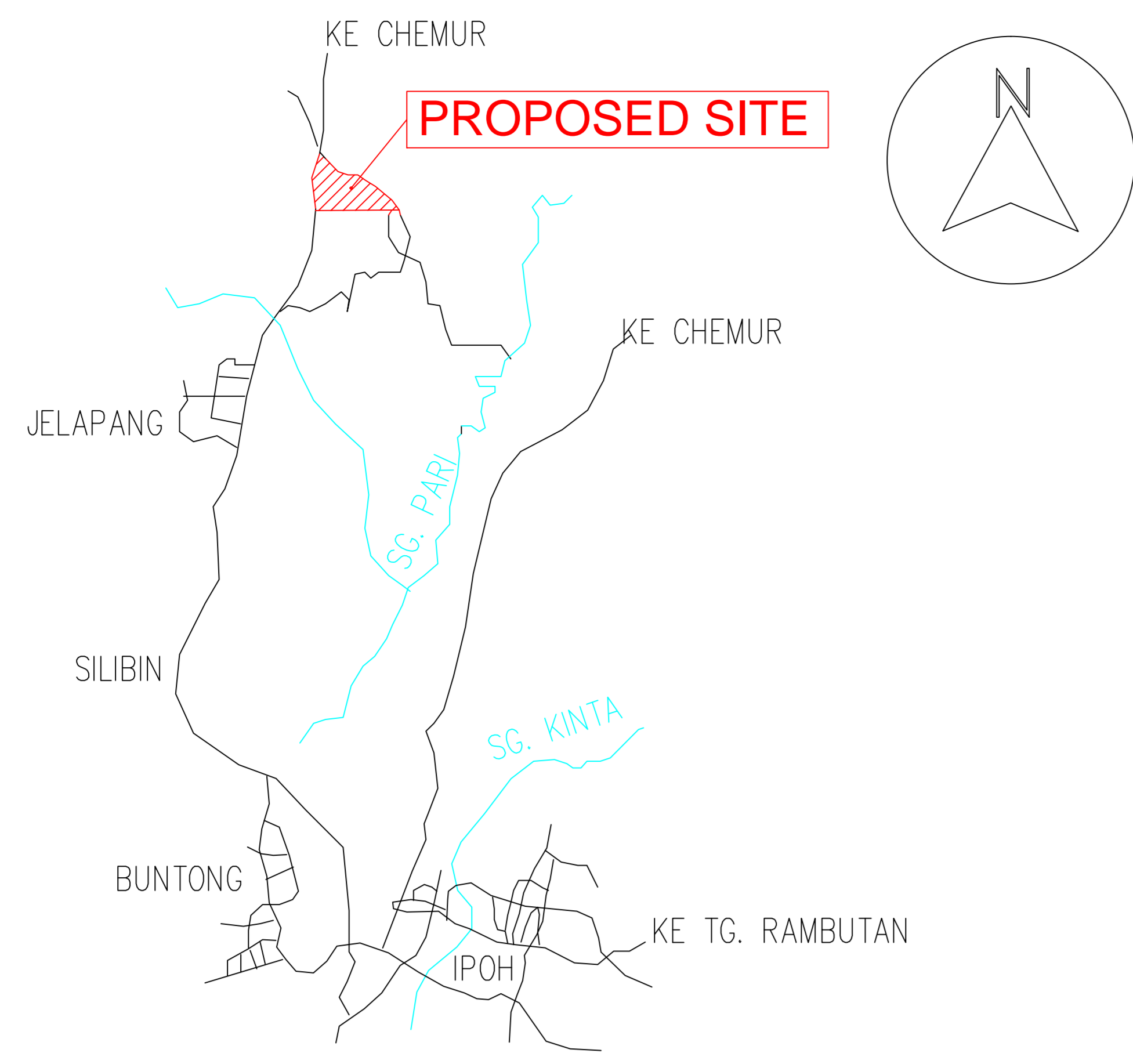

PELAN LOKASI

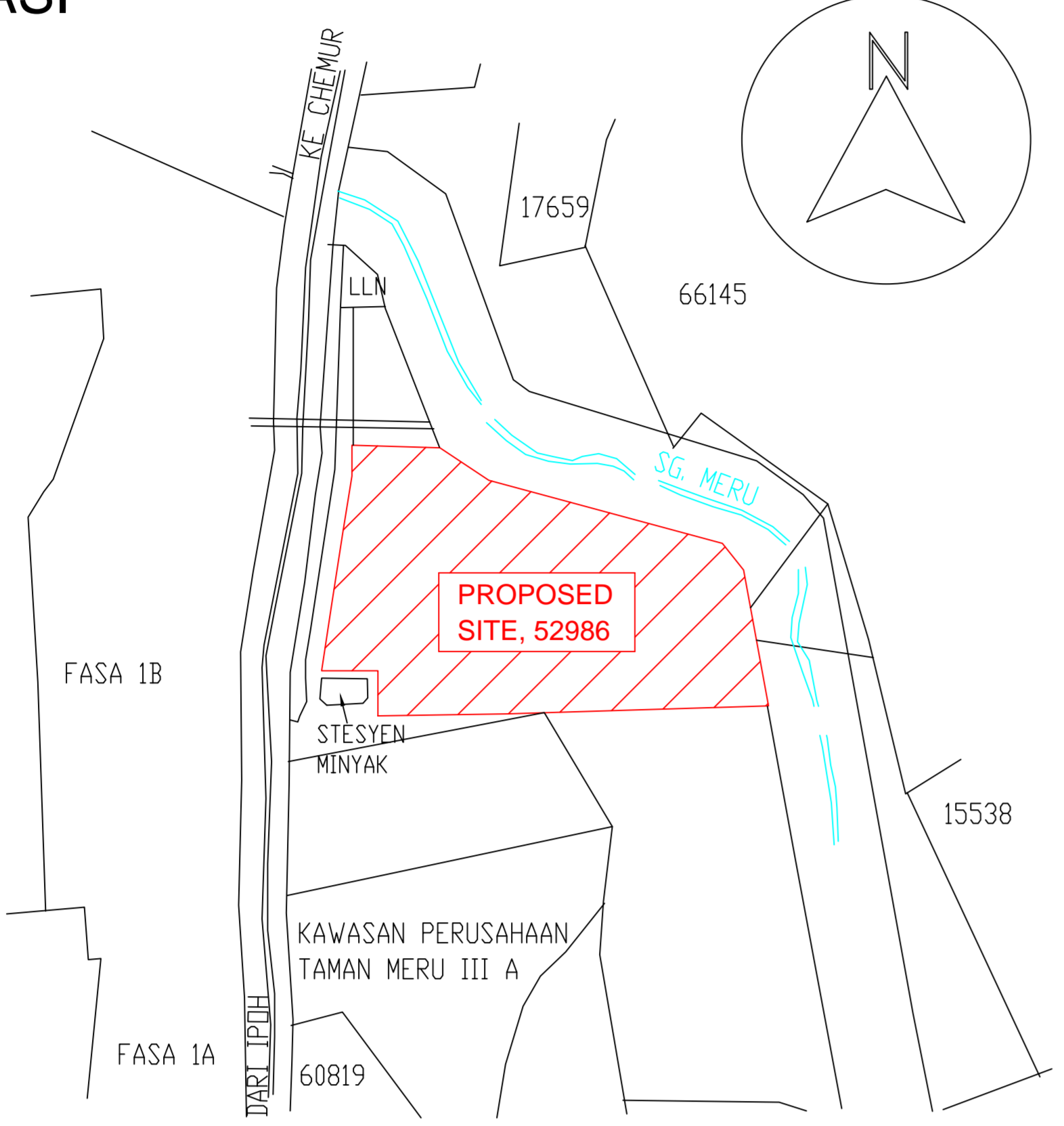

KOORDINAT : 4.651210°N, 101.073799°



PETUNJUK :

- CADANGAN MERENTANG SATU LITAR KABEL BAWAH TANAH 3 X 630 MMP 33KV XLPE DAN 1 LITAR KABEL PILOT (6 KM)
- SEDIADA KABEL BAWAH TANAH 3 X 630 MMP 33KV XLPE
- CADANGAN HDD
- STRAIGHT THROUGH JOINT

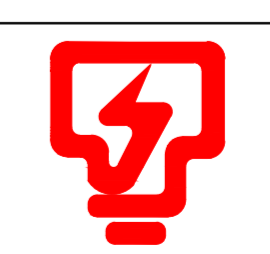

TENAGA NASIONAL BERHAD
Bahagian Pembahagian

Pejabat Pengurus Besar Negeri (Perak)
Wisma TNB, Jalan Lahat
30200 Ipoh, Perak Darul Ridzuan

Tajuk:
MSVT - MERENTANG SATU LITAR KABEL BAWAH TANAH
3 X 630 MMP 33KV XLPE DIANTARA PMU SILIBIN 132/33KV
2X90 MVA KE SSU CARSEM JELAPANG 33KV, IPOH

Dilukis: Salehuddin bin Aziz Tarikh: 09.11.2017
Disemak: Shahniza Amri B.Mohd Salleh No. Projek: PZA 1600
Diluluskan: Che Kamariah Che Isa Skala: not to scale
Ruj: \\inbw\ZONTENGA\IPOH\Projek 33KV\PZA 1600

PMU SILIBIN
132/33 KV