

PELAN TAPAK

SKALA : 1 : 1000
 SYIT : 827
 MUKIM BIDOR
 DAERAH BATANG PADANG

U 53105.241
 T 50896.821

1629

3605

PELAN LURAH TELAH DISEMAK DAN DILULUSKAN
 TIA TECHNOLOGY SERVICES SB

DISEMAK OLEH:

Pegawai Teknik
 Integrated Planning Perak
 Azma Network Delivery Perak
 Mukim Perak
 Area 4, Bangunan TM
 Jalan Jampang, 30020 IPOH

DILULUSKAN OLEH:

SHAWAZWY BINTI ABDUL
 Assistant Manager
 Integrated Planning Perak
 Azma Network Delivery Perak
 Mukim Perak
 Area 4, Bangunan TM
 Jalan Jampang, 30020 IPOH

NO. LURAH: MS&2301683/190
 NO. LURAH: 41823

PELAN KUNCI
 SKALA : 1 : 50,000
 SIT : 3601

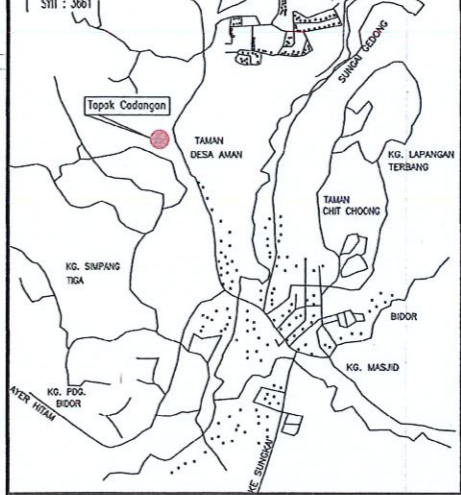

- LEGEND**
- EXISTING TEL. MANHOLE
 - EXISTING 2 NOS. 100mmØ UNDERGROUND PVC DUCTS ROUTE
 - ▣ PROPOSED TEL. MANHOLE TYPE JRC7 C/W HEAVY DUTY COVER
 - PROPOSED 30"x18"x30" TEL. JOINTING PIT TYPE JB30 C/W HEAVY DUTY COVER
 - 2W — PROPOSED 2 NOS. 100mmØ UNDERGROUND PVC DUCTS ROUTE

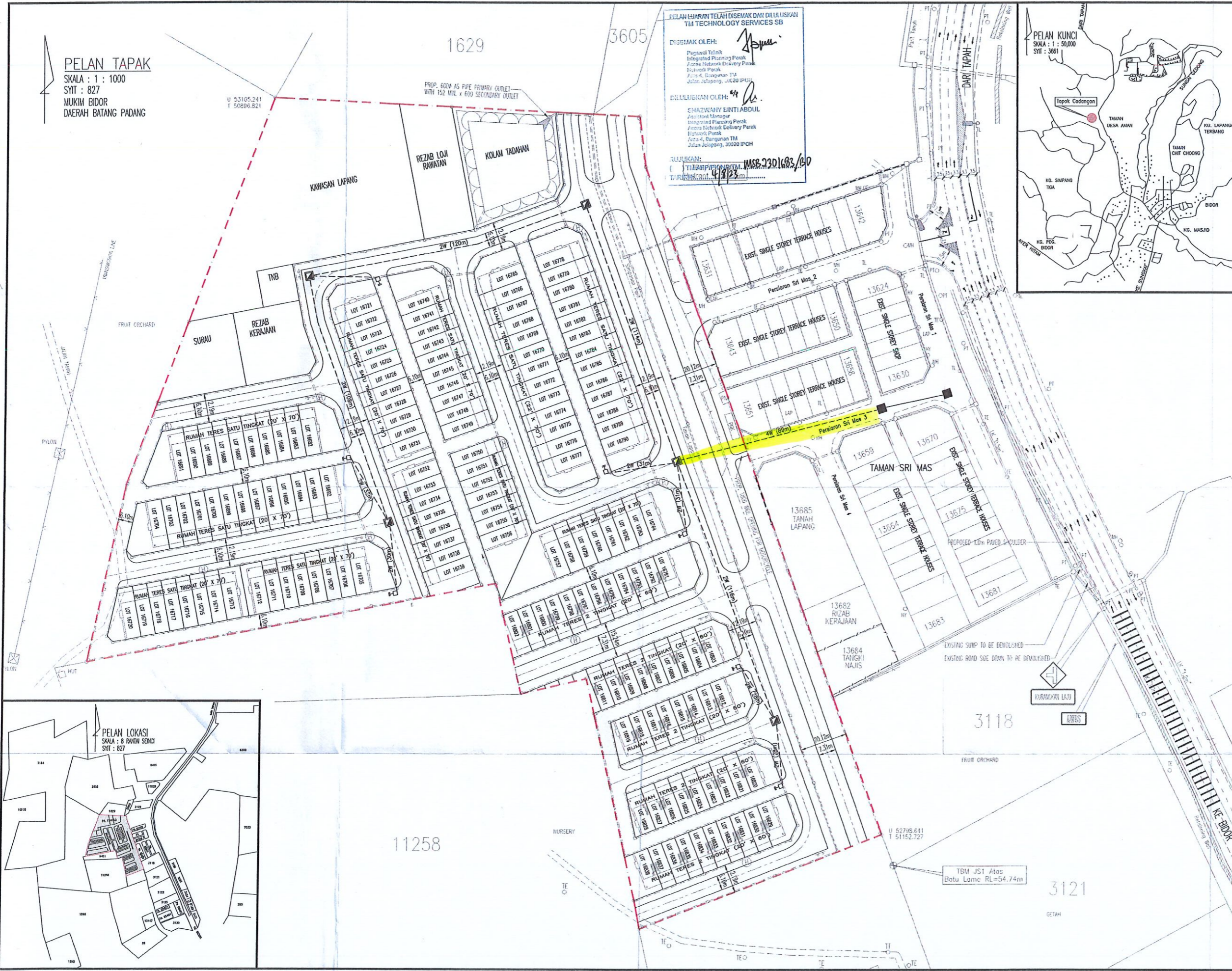

TITLE
 KEY, LOCATION AND SITE PLAN
 -EXTERNAL TELEPHONE LAYOUT

PROJECT
 CADANGAN MEMBINA SKIM PERUMAHAN
 YANG MENDUNGI :
 - 83 UNIT RUMAH TERES 1 TINGKAT
 JENIS A (20'x70') DI ATAS
 LOT 16682 - LOT 16764
 - 26 UNIT RUMAH TERES 1 TINGKAT
 JENIS B (22'x70') DI ATAS
 LOT 16765 - LOT 16790
 - 48 UNIT RUMAH TERES 2 TINGKAT
 DI ATAS LOT 16791 - LOT 16838
 BERHAMPIRAN TAMAN SRI MAS,
 MUKIM BIDOR, DAERAH BATANG PADANG,
 PERAK. UNTUK TETUAN:-

LANGKAU MAJU SDN. BHD.

JURUTERA PERUNDING :
KYS PERUNDING KYS SDN. BHD.
 (Company no. 1278819-T)
 (MECHANICAL & ELECTRICAL CONSULTING ENGINEERS)
 UNIT NO. A-3-1, (3RD FLOOR),
 JALAN MEDAN IPOH 2,
 BANDAR BARU MEDAN IPOH,
 31400 IPOH, PERAK DARUL RIDZUAN.
 TEL : 05-5483322 & 05-5483399
 FAX : 05-5499220
 E-MAIL ADDRESS : perundingkys@gmail.com

APPROVED

CHECKED : MR. GOH DRAWN : LEONG
 SCALE : 1 : 750 DATE : MAY 2023
 DRAWING NO. PKL/23-46/T1