

TECHNICAL PROPOSAL

PROJECT DESCRIPTION	SRR FTTH BD_CXXX TAMAN BIDORIA (KAMPUNG BATU EMPAT)
PROJECT NUMBER	TMNA/251751
PREPARED BY	NUR FATIHAH HIDAYAT
COMPANY NAME	MTK COMMUNICATION SDN.BHD
DATE	26 JUNE 2025
REVISION	03

PROJECT DETAIL

BIL	INFO	DETAIL
1	PROJECT NAME	SRR FTTH BD_CXXX TAMAN BIDORIA (KAMPUNG BATU EMPAT)
2	PROJECT NUMBER	TMNA/251751
3	TM NODE	BD
4	REGION	NORTHERN
5	NE ID	PRK
6	TOTAL FTTH PORTS	232
7	TOTAL PROPERTY	419
8	RFSI DATE	30-JULY-25
9	PF (%)	60%

FDC Location & Boundary



MTK COMMUNICATION SDN BHD



ACCESS NETWORK DEVELOPMENT (AND)
KAWASAN AND
Fibre

IBUSAWAT: BD

TAJUK PROJEK:
SRR FTTH BD CXXX
TAMAN BIDORIA
(KAMPUNG BATU
EMPAT)
TMNA/251751

DISEDIAKAN OLEH

NUR FATIMAH HIDAYAT
SITE OFFICER
018-2492640

T/T

FDC Details and Illustration

Propose Location



MTK COMMUNICATION SDN BHD



ACCESS NETWORK DEVELOPMENT (AND)
KAWASAN AND
Fibre

IBUSAWAT: BD

TAJUK PROJEK:

SRR FTTH BD CXXX
TAMAN BIDORIA
(KAMPUNG BATU
EMPAT)
TMNA/251751

DISEDIAKAN OLEH

NUR FATIMAH HIDAYAT
SITE OFFICER
018-2492640

T/T

No	Info	Road/Location	Type	Total Splitter	Coordinate
1	FDC	JALAN RESIDENSI BIDORIA 5, RESIDENSI BIDORIA, KAMPUNG BATU EMPAT, 35500 BIDOR, PERAK	Normal	24	4.078453, 101.243350

1 Way Trenching Details and Illustration

Propose Location



MTK COMMUNICATION SDN BHD



ACCESS NETWORK DEVELOPMENT (AND)
KAWASAN AND
Fibre

IBUSAWAT: BD

TAJUK PROJEK:

SRR FTTH BD CXXX
TAMAN BIDORIA
(KAMPUNG BATU
EMPAT)
TMNA/251751

DISEDIAKAN OLEH

NUR FATIMAH HIDAYAT
SITE OFFICER
018-2492640

T/T

1 Way Trenching Details and Illustration

Propose Location



MTK COMMUNICATION SDN BHD



ACCESS NETWORK DEVELOPMENT (AND)
KAWASAN AND
Fibre

IBUSAWAT: BD

TAJUK PROJEK:

SRR FTTH BD CXXX
TAMAN BIDORIA
(KAMPUNG BATU
EMPAT)
TMNA/251751

DISEDIAKAN OLEH

NUR FATIMAH HIDAYAT
SITE OFFICER
018-2492640

T/T

1 Way Trenching Details and Illustration

Propose Location

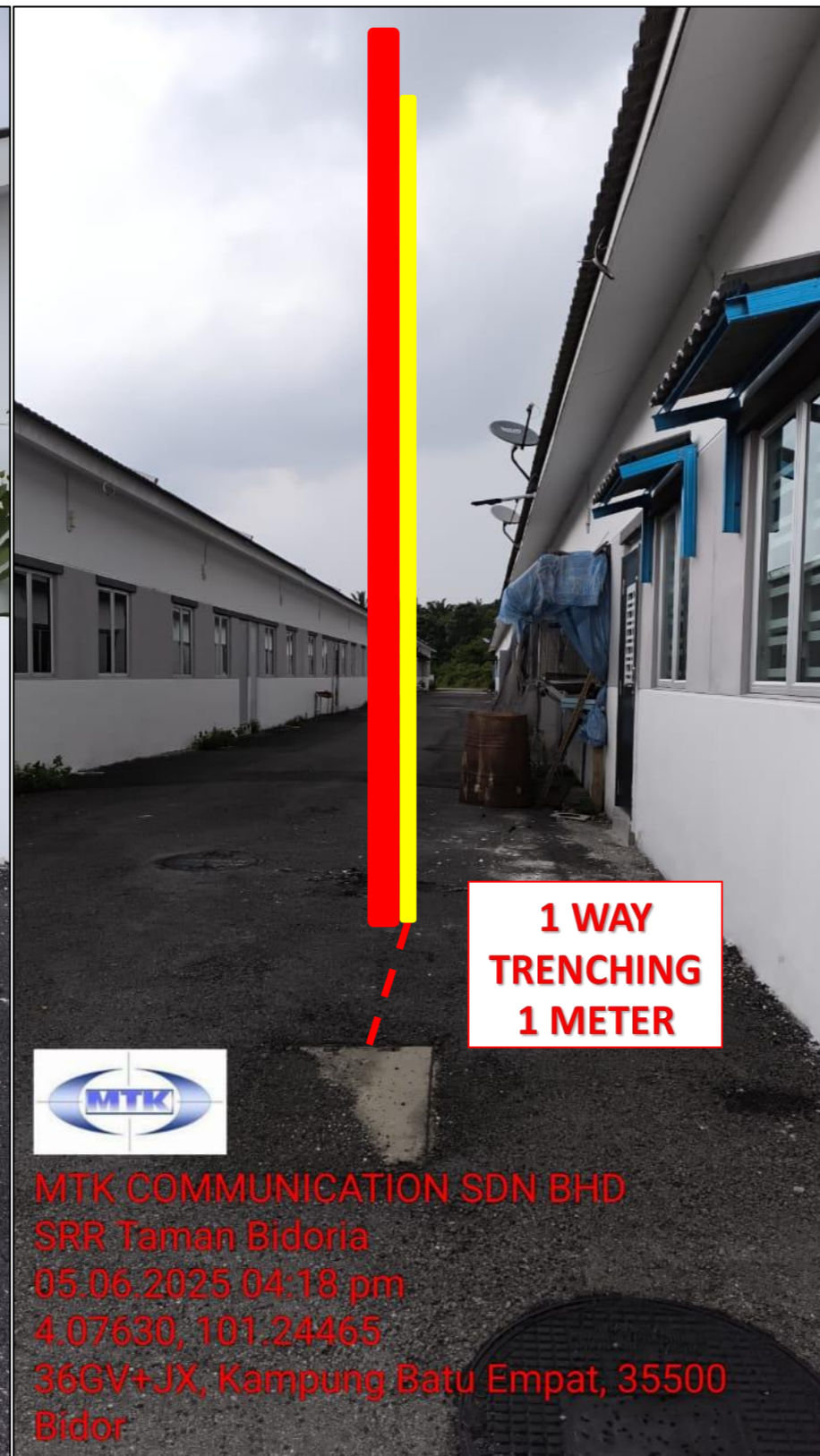

MTK COMMUNICATION SDN BHD



ACCESS NETWORK DEVELOPMENT (AND)
KAWASAN AND
Fibre

IBUSAWAT: BD

TAJUK PROJEK:

SRR FTTH BD CXXX
TAMAN BIDORIA
(KAMPUNG BATU
EMPAT)
TMNA/251751

DISEDIAKAN OLEH

NUR FATIMAH HIDAYAT
SITE OFFICER
018-2492640

T/T

FOC Road Crossing On Pole Concrete 9.0M Details and Illustration

Propose Location



**1 WAY
TRENCHING
1 METER**

**MTK COMMUNICATION SDN BHD
SRR Bidoria
24.06.2025 05:50 pm
4.07942, 101.24334
36HV+W7, Kampung Batu Empat,
35500 Bidor**



MTK COMMUNICATION SDN BHD



ACCESS NETWORK DEVELOPMENT (AND)
KAWASAN AND
Fibre

IBUSAWAT: BD

TAJUK PROJEK:
SRR FTTH BD CXXX
TAMAN BIDORIA
(KAMPUNG BATU
EMPAT)
TMNA/251751

DISEDIAKAN OLEH

NUR FATIMAH HIDAYAT
SITE OFFICER
018-2492640
T/T

FOC Road Crossing On Pole Concrete 7.5M Details and Illustration

Propose Location



MTK COMMUNICATION SDN BHD
SRR Bidoria
24.06.2025 05:51 pm
4.07925, 101.24349
36HV+W7, Kampung Batu Empat,
35500 Bidor



MTK COMMUNICATION SDN BHD



ACCESS NETWORK DEVELOPMENT (AND)
KAWASAN AND
Fibre

IBUSAWAT: BD

TAJUK PROJEK:

SRR FTTH BD CXXX
TAMAN BIDORIA
(KAMPUNG BATU
EMPAT)
TMNA/251751

DISEDIAKAN OLEH

NUR FATIMAH HIDAYAT
SITE OFFICER
018-2492640

T/T

FDP Boundary

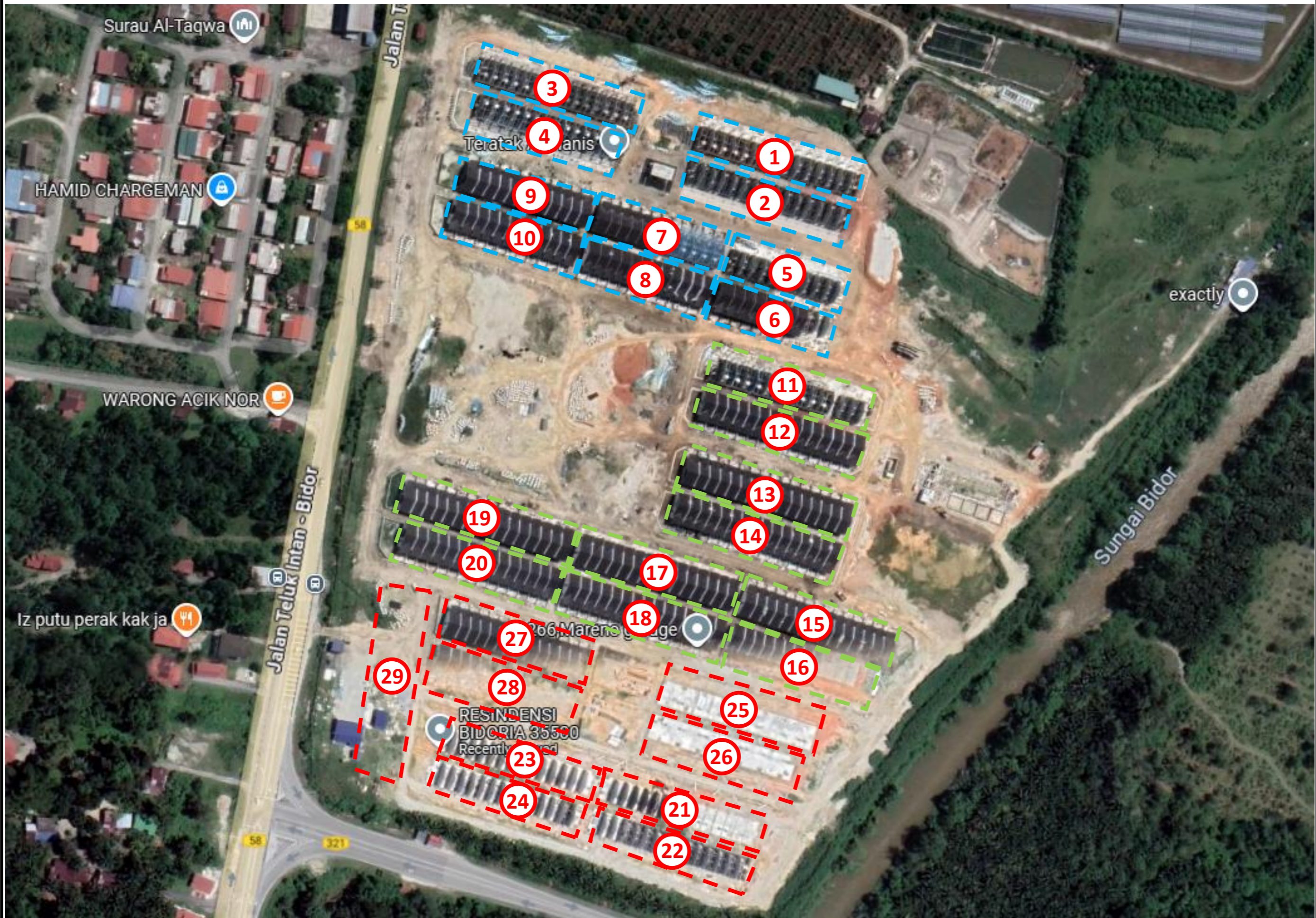

MTK COMMUNICATION SDN BHD



ACCESS NETWORK DEVELOPMENT (AND)
KAWASAN AND
Fibre

IBUSAWAT: BD

TAJUK PROJEK:
SRR FTTH BD CXXX
TAMAN BIDORIA
(KAMPUNG BATU
EMPAT)
TMNA/251751

DISEDIAKAN OLEH

NUR FATIMAH HIDAYAT
SITE OFFICER
018-2492640

T/T

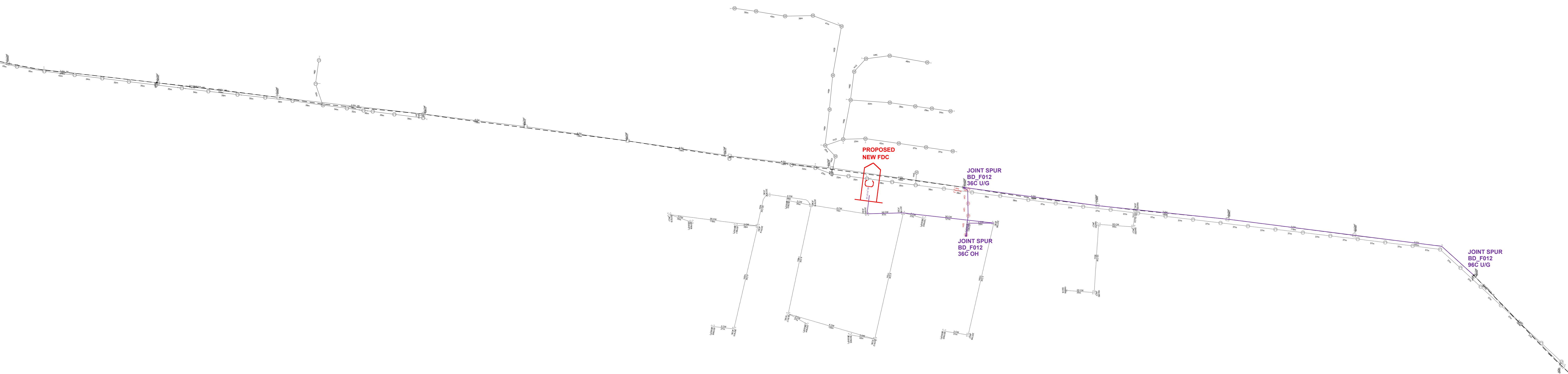

LEGEND

1 Broken line - Proposed Part Item	DSLAM Exchange
2 Solid line - As Built Part Item	DSLAM Frame RT1
Cabinet (Known Type)	RT DSLAM (Support Cabinet)
Phantom Cabinet	Digital Data Network (DDN)
Subscriber Distribution Frame (SDF)	
Manhole/Junction Box	
Distribution Point (Ring Type)	
Duct Path	
Fibre (Steel)	
Fibre (Poly)	
Fibre (Concrete)	
Fibre with stop/turn	
Fibre Drop	
Fibre Distribution Cabinet	
Fibre Remote Terminal	
Transfer Cable	

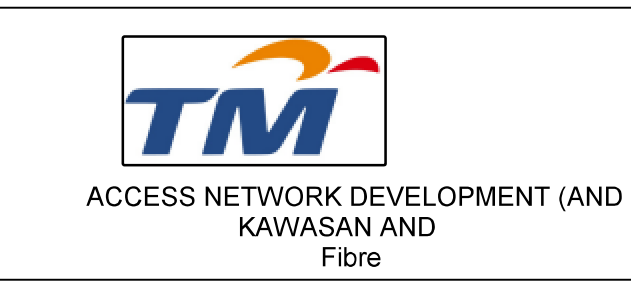

IBUSAWAT: BD

TAJUK PROJEK:
 TMNA/251751JOINT BD_F12
 SRR FTTH BD_CXXX
 TAMAN BIDORIA
 (KAMPUNG BATU EMPAT)

Ukuran: 1:2000

DISEDIAKAN OLEH: _____

DISEMAK OLEH: _____

DILULUSKAN: _____

[swatan_julus] _____

Tarikh: _____

No Lukisan : [no_lukisan] _____

No Syt: 1 of 1

Tarikh Dikeluarkan : 20250603

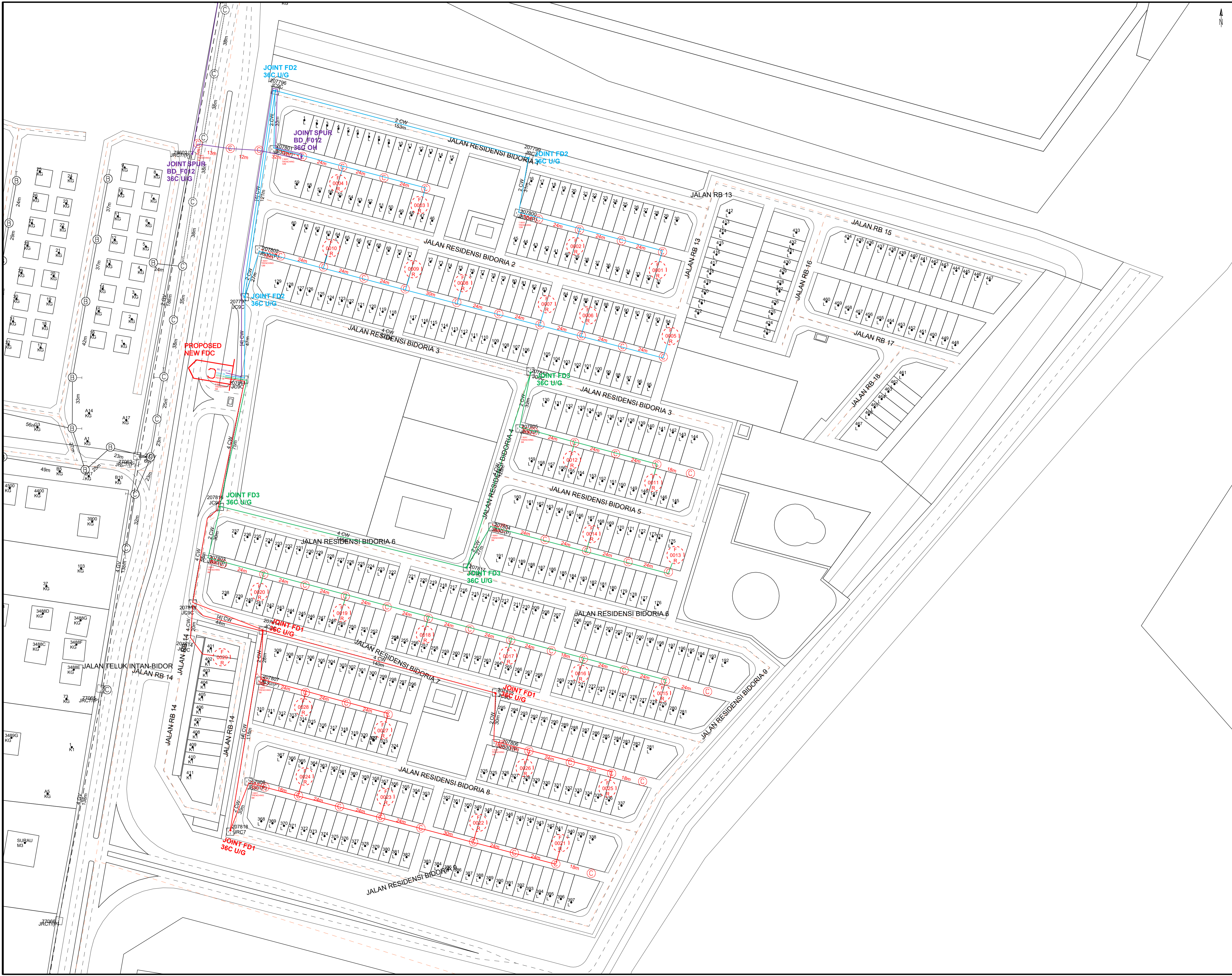

Tarikh	Catitan Pindaan	T/Tangan

LEGEND

1. Broken Line - Proposed Plant Item	Transfer Cable
2. Solid Line - As-Built Plant Item	DSLAM in Exchange
Cabinet (Krone Type)	DSLAM (Inside RT)
Phantom Cabinet	RT DSLAM (Separate Cabinet)
Subscriber Distribution Frame (SDF)	Digital Data Network (DDN)
Manhole/Jointbox	
Distribution Point (Ring Type)	
Dust Path	
Pole (Bas)	
Pole (Kayu)	
Pole (Concrete)	
Pole with strays/strut	
Fiber Stack	
FDC: Fiber Distribution Cabinet	
Fiber Remote Terminal	

**ACCESS NETWORK DEVELOPMENT (AND)
 KAWASAN AND
 Civil**

IBUSAWAT:	BD
TAJUK PROJEK:	TMNA/251751 SRR FTTH BD CXXX TAMAN BIDORIA (KAMPUNG BATU EMPAT)
Ukuran:1:1000	
DISEDIAKAN OLEH	T/T
DISEMAK OLEH	[jawatan_sமாக]
DILULUSKAN	[jawatan_lulus]
Tarikh:	T/T
No Lukisan : [no_lukisan]	
No Syit: 1 of 1	
Tarikh Dikeluarkan :	20250603

E-SIDE
NEW SPUR

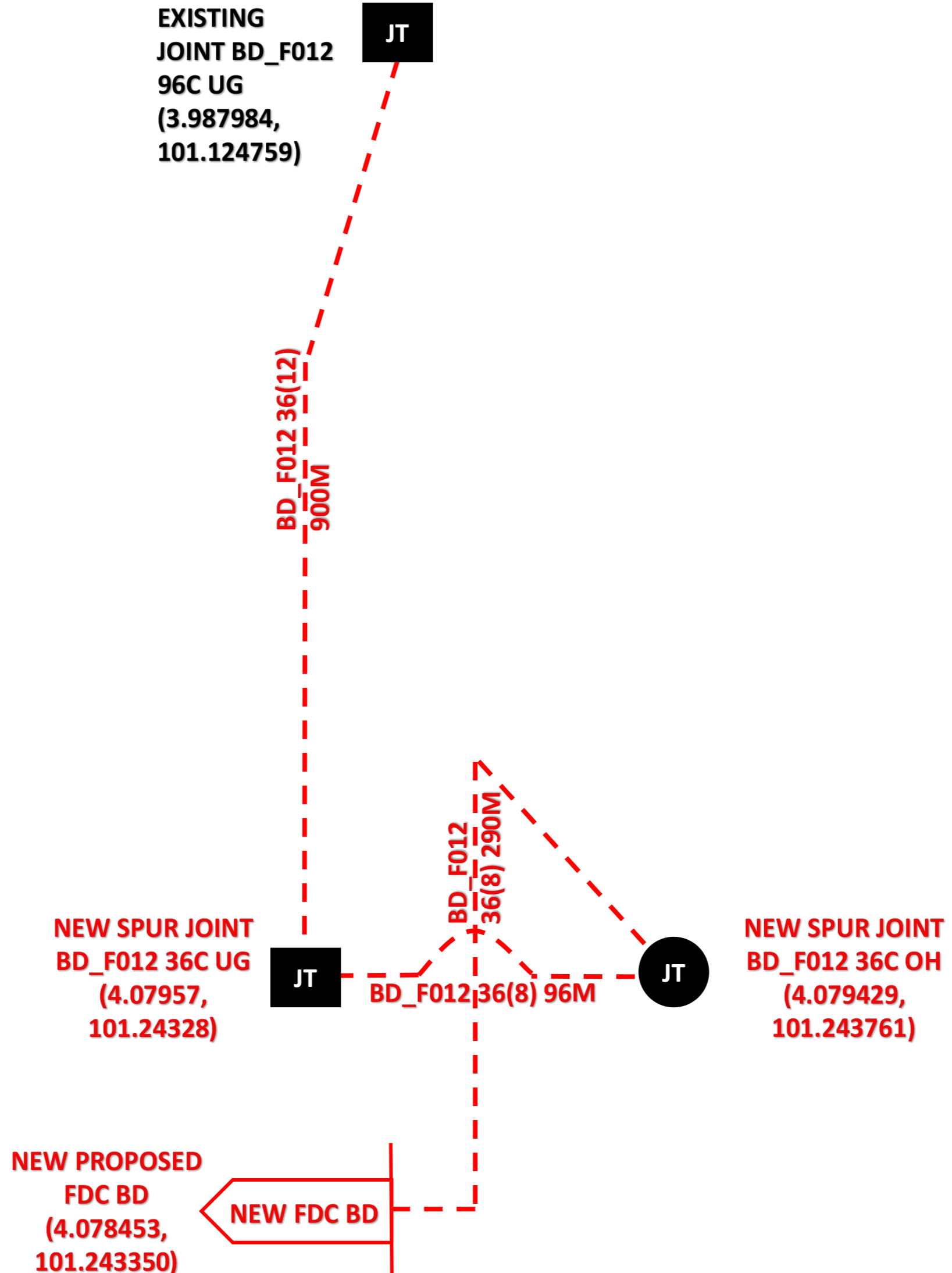

↑
FOC 36C UG
= 1,190M
↓
FOC 36C IB
= 96M

JT JOINT
U/G

JT JOINT
O/H



MTK COMMUNICATION SDN BHD



ACCESS NETWORK DEVELOPMENT (AND)
KAWASAN AND
Fibre

IBUSAWAT: BD

TAJUK PROJEK:
SRR FTTH BD_CXXX
TAMAN BIDORIA
(KAMPUNG BATU
EMPAT)
TMNA/251751

**E-SIDE NEW
SPUR**

DISEDIAKAN OLEH

NUR FATIMAH HIDAYAT
SITE OFFICER
018-2492640
T/T

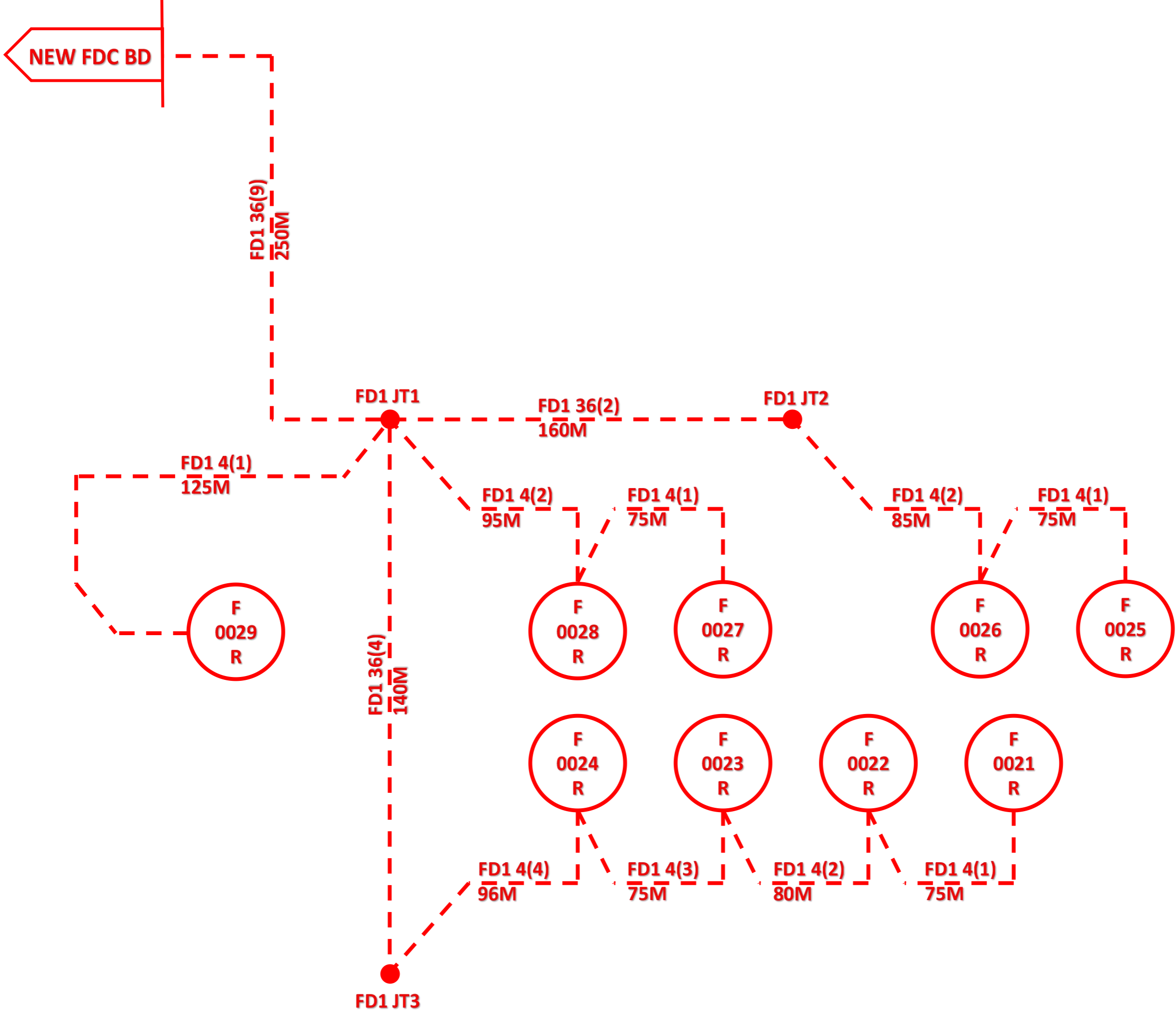

- FOC 4C UG = 125M
- FOC 36C UG = 550M
- FOC 4C IB = 656M
- JOINT FD1 36C UG
- R FDP ON POLE

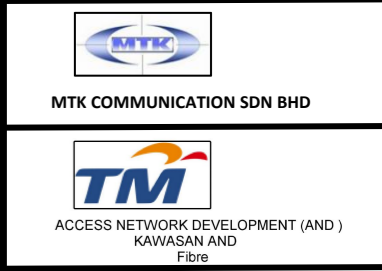

IBUSAWAT: _____ BD

TAJUK PROJEK:
SRR FTTH BD CXXX
TAMAN BIDORIA
(KAMPUNG BATU
EMPAT)
 TMNA/251751

**D-SIDE NEW
FD1**

DISEDIAKAN OLEH

NUR FATIMAH HIDAYAT
 SITE OFFICER
 018-2492640
 T/T

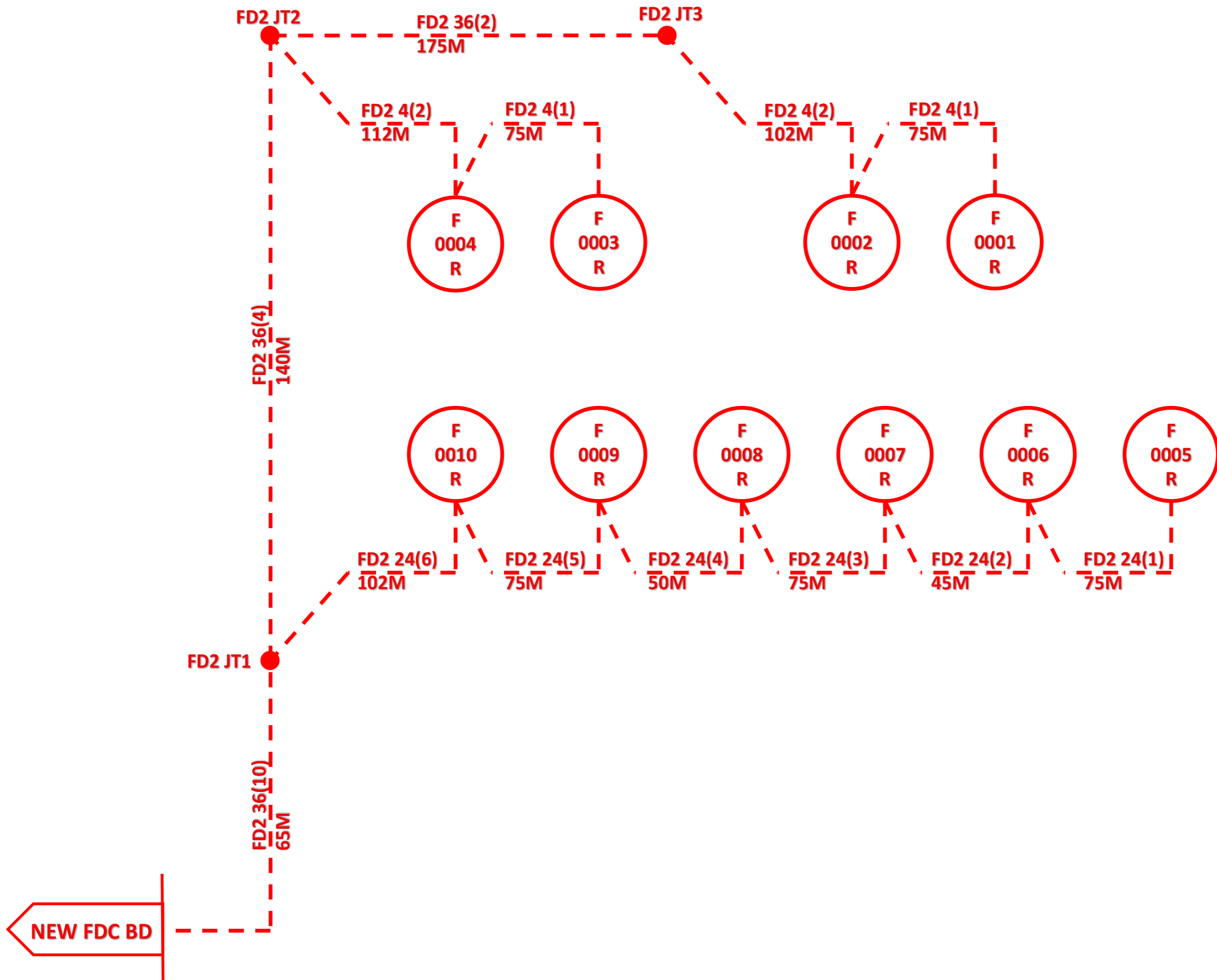

- ↑ FOC 36C UG = 380M
- ↓ FOC 24C IB = 422M
- FOC 4C IB = 364M
- JOINT FD2 36C UG
- R FDP ON POLE



MTK COMMUNICATION SDN BHD



ACCESS NETWORK DEVELOPMENT (AND) KAWASAN AND Fibre

IBUSAWAT: BD

TAJUK PROJEK:
SRR FTTH BD CXXX
TAMAN BIDORIA
(KAMPUNG BATU
EMPAT)
TMNA/251751

**D-SIDE NEW
 FD2**

DISEDIAKAN OLEH

NUR FATIMAH HIDAYAT
 SITE OFFICER
 018-2492640

T/T

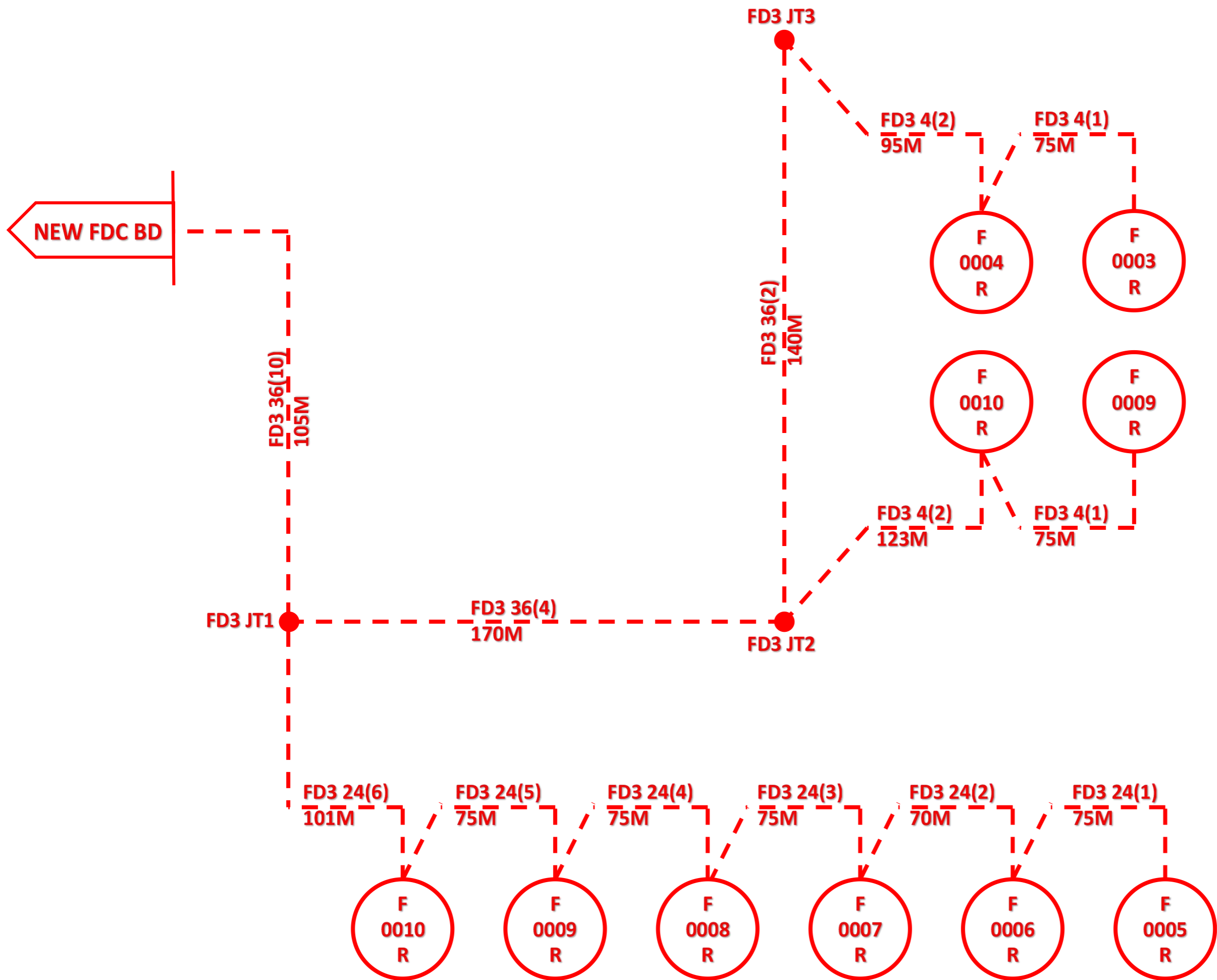

- ↑ FOC 36C UG = 415M
- ↓ FOC 24C IB = 471M
- FOC 4C IB = 368M
- JOINT FD3 36C UG
- R FDP ON POLE



MTK COMMUNICATION SDN BHD



ACCESS NETWORK DEVELOPMENT (AND) KAWASAN AND Fibre

IBUSAWAT: BD

TAJUK PROJEK:
SRR FTTH BD CXXX
TAMAN BIDORIA
(KAMPUNG BATU
EMPAT)
TMNA/251751

**D-SIDE NEW
FD3**

DISEDIAKAN OLEH

NUR FATIMAH HIDAYAT
 SITE OFFICER
 018-2492640

T/T

FDP Details

No	Info	Type	Road/Location	Ports	Properties Covered	Remark
1	DP0001	On Pole	JALAN RESIDENSI BIDORIA 2, RESIDENSI BIDORIA	8	15	FD2
2	DP0002	On Pole	JALAN RESIDENSI BIDORIA 2, RESIDENSI BIDORIA	8	15	FD2
3	DP0003	On Pole	JALAN RESIDENSI BIDORIA 2, RESIDENSI BIDORIA	8	15	FD2
4	DP0004	On Pole	JALAN RESIDENSI BIDORIA 2, RESIDENSI BIDORIA	8	14	FD2
5	DP0005	On Pole	JALAN RESIDENSI BIDORIA 2, RESIDENSI BIDORIA	8	11	FD2
6	DP0006	On Pole	JALAN RESIDENSI BIDORIA 2, RESIDENSI BIDORIA	8	11	FD2
7	DP0007	On Pole	JALAN RESIDENSI BIDORIA 2, RESIDENSI BIDORIA	8	12	FD2
8	DP0008	On Pole	JALAN RESIDENSI BIDORIA 2, RESIDENSI BIDORIA	8	12	FD2
9	DP0009	On Pole	JALAN RESIDENSI BIDORIA 2, RESIDENSI BIDORIA	8	12	FD2
10	DP0010	On Pole	JALAN RESIDENSI BIDORIA 2, RESIDENSI BIDORIA	8	12	FD2
11	DP0011	On Pole	JALAN RESIDENSI BIDORIA 5, RESIDENSI BIDORIA	8	15	FD3
12	DP0012	On Pole	JALAN RESIDENSI BIDORIA 5, RESIDENSI BIDORIA	8	15	FD3
13	DP0013	On Pole	JALAN RESIDENSI BIDORIA 5, RESIDENSI BIDORIA	8	16	FD3
14	DP0014	On Pole	JALAN RESIDENSI BIDORIA 5, RESIDENSI BIDORIA	8	16	FD3
15	DP0015	On Pole	JALAN RESIDENSI BIDORIA 7, RESIDENSI BIDORIA	8	15	FD3
16	DP0016	On Pole	JALAN RESIDENSI BIDORIA 7, RESIDENSI BIDORIA	8	12	FD3
17	DP0017	On Pole	JALAN RESIDENSI BIDORIA 7, RESIDENSI BIDORIA	8	15	FD3
18	DP0018	On Pole	JALAN RESIDENSI BIDORIA 7, RESIDENSI BIDORIA	8	15	FD3
19	DP0019	On Pole	JALAN RESIDENSI BIDORIA 7, RESIDENSI BIDORIA	8	16	FD3
20	DP0020	On Pole	JALAN RESIDENSI BIDORIA 7, RESIDENSI BIDORIA	8	15	FD3
21	DP0021	On Pole	JALAN RESIDENSI BIDORIA 8, RESIDENSI BIDORIA	8	15	FD1
22	DP0022	On Pole	JALAN RESIDENSI BIDORIA 8, RESIDENSI BIDORIA	8	15	FD1
23	DP0023	On Pole	JALAN RESIDENSI BIDORIA 8, RESIDENSI BIDORIA	8	15	FD1
24	DP0024	On Pole	JALAN RESIDENSI BIDORIA 8, RESIDENSI BIDORIA	8	15	FD1

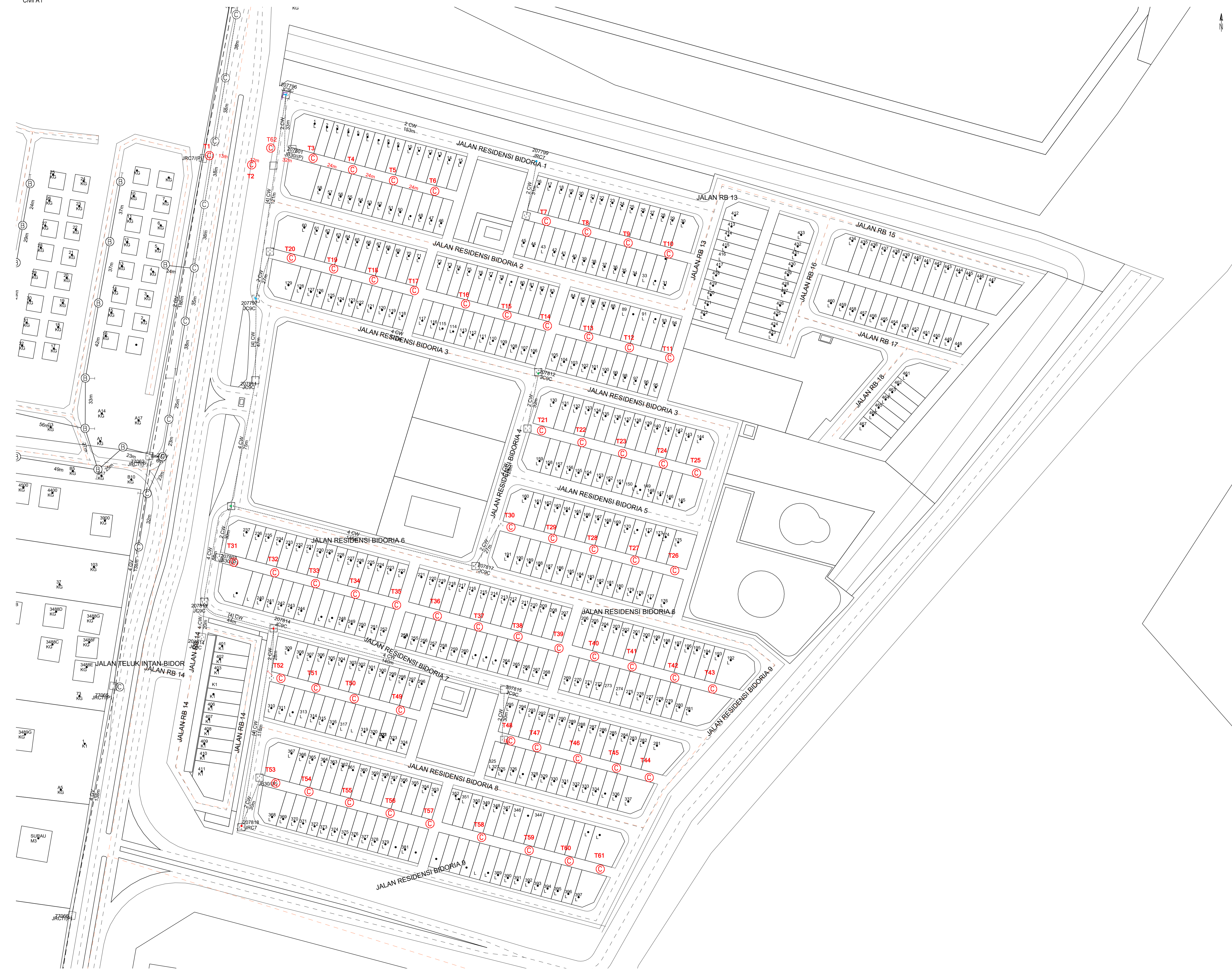

Tarikh	Catatan Pindaan	T/Tangan

LEGEND

1. Broken Line - Proposed Plant Item	Transfer Cable
2. Solid Line - As-Built Plant Item	DSLAM in Exchange
Cabinet (Krone Type)	RDSLAM (Inside RT)
Phantom Cabinet	RT DSLAM (Separate Cabinet)
Subscriber Distribution Frame (SDF)	Digital Data Network (DDN)
Manhole/Jointbox	Distribution Point (Ring Type)
Dust Path	
Pole (Bas)	
Pole (Kayu)	
Pole (Concrete)	
Pole with stay/strut	
Fiber Stack	
Fiber Distribution Cabinet	
Fiber Remote Terminal	



**ACCESS NETWORK DEVELOPMENT (AND)
KAWASAN AND
Civil**

IBUSAWAT:	BD
TAJUK PROJEK:	TMNA/251751
	SRR FTTH BD CXXX
	TAMAN BIDORIA
	(KAMPUNG BATU EMPAT)
Ukuran:	1:1000
DISEDIAKAN OLEH	T/T
DISEMAK OLEH	[jawatan_sesak] T/T
DILULUSKAN	[jawatan_lulus] T/T
Tarikh:	T/T
No Lukisan :	[no_lukisan]
No Syit :	1 of 1
Tarikh Dikeluarkan :	20250603

3.2 New Pole details

No POLE	Pole Type	GPS Coordinate
T1	Concrete Pole 9m	4.079564, 101.243191
T2	Concrete Pole 9m	4.079511, 101.243487
T3	Concrete Pole 7.5m	4.079451, 101.243684
T4	Concrete Pole 7.5m	4.079398, 101.243851
T5	Concrete Pole 7.5m	4.079328, 101.244154
T6	Concrete Pole 7.5m	4.079238, 101.244451
T7	Concrete Pole 7.5m	4.079067, 101.244961
T8	Concrete Pole 7.5m	4.079042, 101.245069
T9	Concrete Pole 7.5m	4.078952, 101.245374
T10	Concrete Pole 7.5m	4.078889, 101.245588
T11	Concrete Pole 7.5m	4.078322, 101.245525
T12	Concrete Pole 7.5m	4.078374, 101.245367
T13	Concrete Pole 7.5m	4.078462, 101.245078
T14	Concrete Pole 7.5m	4.078507, 101.244943
T15	Concrete Pole 7.5m	4.078597, 101.244650
T16	Concrete Pole 7.5m	4.078667, 101.244388
T17	Concrete Pole 7.5m	4.078723, 101.244244
T18	Concrete Pole 7.5m	4.078765, 101.244106

No POLE	Pole Type	GPS Coordinate
T19	Concrete Pole 7.5m	4.078824, 101.243901
T20	Concrete Pole 7.5m	4.078880, 101.243705
T21	Concrete Pole 7.5m	4.077914, 101.244974
T22	Concrete Pole 7.5m	4.077880, 101.245129
T23	Concrete Pole 7.5m	4.077831, 101.245292
T24	Concrete Pole 7.5m	4.077770, 101.245501
T25	Concrete Pole 7.5m	4.077717, 101.245664
T26	Concrete Pole 7.5m	4.077181, 101.245569
T27	Concrete Pole 7.5m	4.077217, 101.245411
T28	Concrete Pole 7.5m	4.077280, 101.245199
T29	Concrete Pole 7.5m	4.077334, 101.245005
T30	Concrete Pole 7.5m	4.077388, 101.244838
T31	Concrete Pole 7.5m	4.077232, 101.243438
T32	Concrete Pole 7.5m	4.077187, 101.243587
T33	Concrete Pole 7.5m	4.077142, 101.243745
T34	Concrete Pole 7.5m	4.077084, 101.243953
T35	Concrete Pole 7.5m	4.077016, 101.244151
T36	Concrete Pole 7.5m	4.076976, 101.244304

No POLE	Pole Type	GPS Coordinate
T37	Concrete Pole 7.5m	4.076935, 101.244431
T38	Concrete Pole 7.5m	4.076859, 101.244679
T39	Concrete Pole 7.5m	4.076764, 101.244959
T40	Concrete Pole 7.5m	4.076706, 101.245166
T41	Concrete Pole 7.5m	4.076647, 101.245337
T42	Concrete Pole 7.5m	4.076589, 101.245518
T43	Concrete Pole 7.5m	4.076517, 101.245734
T44	Concrete Pole 7.5m	4.076503, 101.245847
T45	Concrete Pole 7.5m	4.076125, 101.245216
T46	Concrete Pole 7.5m	4.076184, 101.245040
T47	Concrete Pole 7.5m	4.076233, 101.244864
T48	Concrete Pole 7.5m	4.076283, 101.244692
T49	Concrete Pole 7.5m	4.076395, 101.244264
T50	Concrete Pole 7.5m	4.076445, 101.244101
T51	Concrete Pole 7.5m	4.076512, 101.243926
T52	Concrete Pole 7.5m	4.076607, 101.243619
T53	Concrete Pole 7.5m	4.076021, 101.243593
T54	Concrete Pole 7.5m	4.075995, 101.243700

No POLE	Pole Type	GPS Coordinate
T55	Concrete Pole 7.5m	4.075962, 101.243821
T56	Concrete Pole 7.5m	4.075912, 101.244011
T57	Concrete Pole 7.5m	4.075829, 101.244271
T58	Concrete Pole 7.5m	4.075804, 101.244440
T59	Concrete Pole 7.5m	4.075743, 101.244601
T60	Concrete Pole 7.5m	4.075659, 101.244844
T61	Concrete Pole 7.5m	4.075578, 101.245117
T62	Concrete Pole 7.5m	4.0795129,101.2435433

**SEKIAN
TERIMA KASIH**

