	Contractor	PURNAMA SOLUTION (M) SDN. BHD	
	SOW Ref	OSP Construction & Commissioning	
	LRD	JMBU -SERA	
	Subject	Fiber Technical Proposal	



Region	Eastern		
KV/OKV	OKV		
Point A	JMBU	Point B	T-ST003-0105-000M
Address	LALUAN PERSEKUTUAN 3, 21610, MARANG, TERENGGANU		
Site A Lat Long	4.940593, 103.347477		
Site B Lat Long	4.93983, 103.34880		
Structure Owner	MAXIS		

Table of Contents

- Section 1: Proposal Sign-off sheet
- Section 2: Outside Plant Civil Infra Design Summary
- Section 3: Vicinity Map
- Section 4: Civil Infrastructure Route Plan & Permint Boundary
- Section 5: Proposed Manhole GPS Coordinates
- Section 6: Cable Infrastructure Route Plan & Proposed Cable Plan
- Section 7: Core Assignment Plan
- Section 8: Outside Plant Site Snapshot
- Section 9: Cabin Information & Floor Plan
- Bill of Quantities (BoQ)



Section 1: Proposal Sign-off Sheet

This proposal is contains the civil design proposal for MAXIS SITE "JMBU - T-ST003-0105-000M"
LALUAN PERSEKUTUAN 3, 21610, MARANG, TERENGGANU

All the information presented complied with Maxis Outside Plan technical specification & guidelines:

- Last Mile Telecommunication Systems Design and Survey (GLD/TNE/005)
- GLD/CATE/002 (Outside Plant Design and Build Guideline)
- OSPE GLD/TNE/003(Horizontal Directional Drilling Procedure & Guideline)
- OSPE GLD/TNE/004 (Road Reinstatement Work Guideline)

The proposed construction methodologies, material and Bill of Quantity are verified to be correct.

PURNAMA SOLUTION (M) SDN. BHD

Name: _____

Designation: _____

Signature: _____

Check & Approved by: _____

Signature: _____

Submission Date: _____

Maxis OSP Detail Design

Name: _____

Designation: _____

Signature: _____

Approval Date: _____



Section 2: Outside Plant Civil Infra Design Summary

Overall proposed OSP Civil Infrastructure Design Distance	170	meter
a. Horizontal directional drilling	90	meter
b. Carriage way open cut trenching	0	meter
c. Grass verge open cut trenching	0	meter
d. Micro-trenching (mT)	30	meter
e. Prop Pole	6	ea
f. Aerial	50	meter
g. GI Pipes Crossing/Riser	0	meter
h. Cable Ladder	0	meter
i. Duct GI	0	meter

ITP trunking/riser length	0	meter
ITP cable length from Maxis fiber tapping point to new termination point at building/cabin	0	meter
No. of proposed manhole	2	pc
Area of miling work required	0	meter

Local council & authority approval requirement	170	meter
a. MAJLIS DAERAH MARANG	80	meter
b. JKR	90	meter
c.		meter

Estimated Cost of the Scheme/Project	0.00	RM
--------------------------------------	-------------	----

Type of building:	TOWER
Address:	LALUAN PERSEKUTUAN 3, 21610, MARANG, TERENGGANU
Contact person:	
Contact no.:	



Existing Infrastructure Information

Preceding duct/sub-duct space	N/A
Preceding duct/sub-duct condition	N/A
Existing cable/fiber condition	N/A
Existing sites power & space	N/A

Tenaga Pole Option

TNB pole availability	N/A
Distance of the TNB poles	N/A
Constraint	N/A

Other Highlights/Remarks

--

SLA

Date Survey Triggered

Survey Done (Days)	TP Submission (Days)
1	7

Implementation

Method	Distance (m)	CW (Days)
Underground	47	
Pole	6	
Total	53	0

Date TP Submission
Date CW Completed



PURNAMA SOLUTION (M) SDN. BHD



Section 3

Vicidnity Map





Proposed MH



Existing MH



Proposed duct



Existing duct



PURNAMA SOLUTION (M) SDN. BHD



Section 4

Civil Infrastructure Route Plan & Permit Boundary



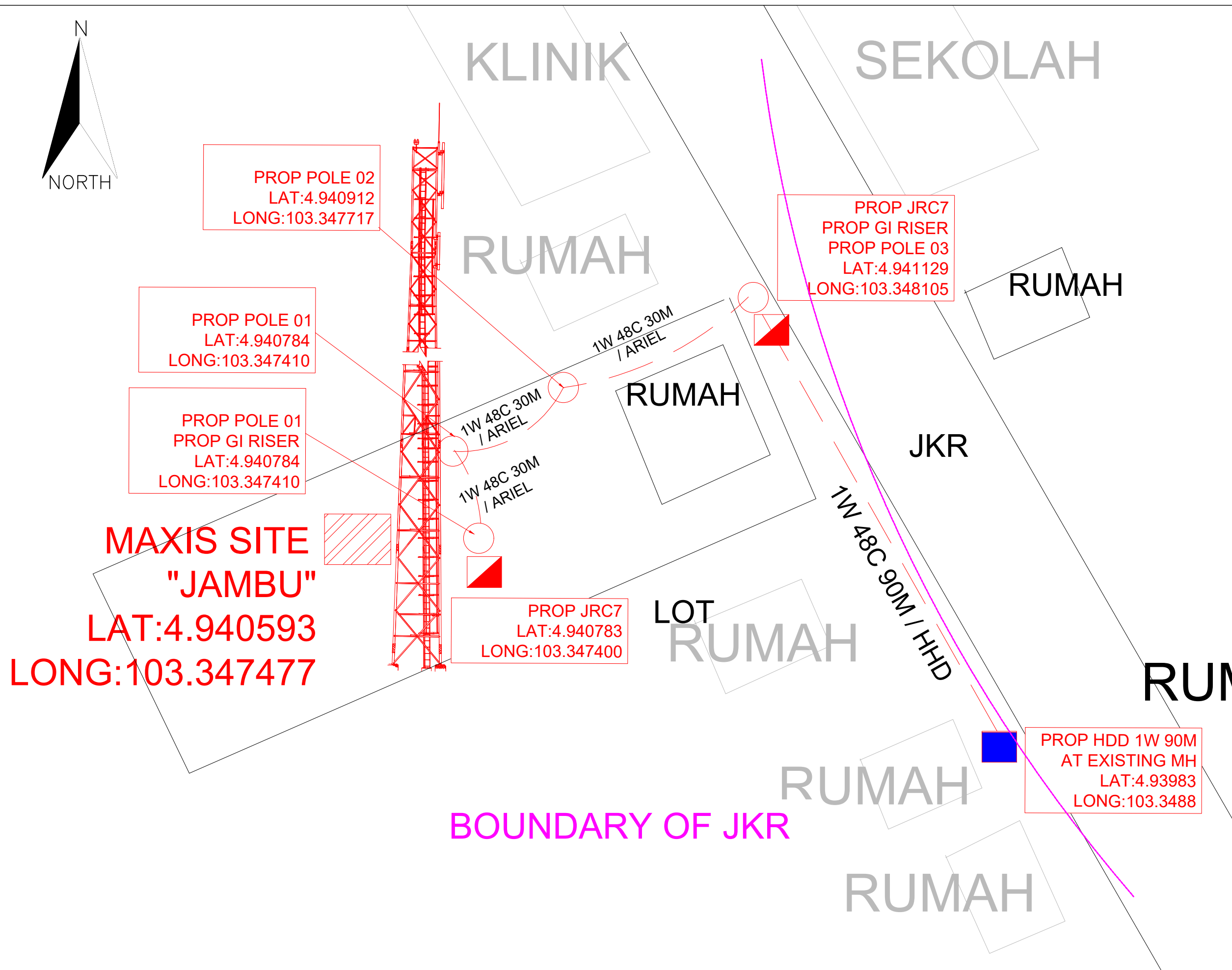
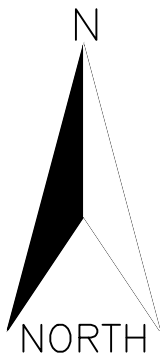

**MAXIS SITE
"JAMBU"**
LAT:4.940593
LONG:103.347477

PROP POLE 02
LAT:4.940912
LONG:103.347717

PROP POLE 01
LAT:4.940784
LONG:103.347410

PROP POLE 01
PROP GI RISER
LAT:4.940784
LONG:103.347410

PROP JRC7
LAT:4.940783
LONG:103.347400

PROP JRC7
PROP GI RISER
PROP POLE 03
LAT:4.941129
LONG:103.348105

PROP HDD 1W 90M
AT EXISTING MH
LAT:4.93983
LONG:103.3488

BOUNDARY OF JKR

OSP Schematic Design	
Site Name	JAMBU
Project Title	PROPOSED FIBRE PLAN FOR MAXIS ONNET BUILDING FIBERIZATION SITE " JAMBU "
DWG ID.	SITE BOUNDARY JAMBU
Revision No.	-
Date	17.11.2023
Sheet	-
Summary Note	
Total HP/PP	-
Total FDC	-
Total FDP	-
Total Propose Joint	01
Total Propose MH	-
Total Propose Pole	06
Total Prop UG Cable (m)	1203
Total Prop OH Cable (m)	161
Legends	
Propose FDC / FDF	
Existing FDC / FDF	
Propose FDP	
Existing FDP	
Propose Manhole	
Existing Manhole	
Propose Pit / Handhole	
Existing Pit / Handhole	
Propose G.i / Duct Riser	
Existing G.i / Duct Riser	
Propose Pole	
Existing Pole	
Propose Closure/Joint	
Existing UG Duct Way	
Propose UG Trenching	
Existing Aerial Cable	
Propose Aerial Cable	
FDC Boundary	
FDP Boundary	
JKR Boundary	
Local Council Boundary	
Design By	PURNAMA SOLUTION (M) SDN BHD (568408 - P)
Maxis Broadband Sdn. Bhd.	
Checked By	
Checked Date	
Approved / Rejected By	
Approved / Rejected Date	



PURNAMA SOLUTION (M) SDN. BHD



Section 5: Proposed Manhole & Pole GPS Coordinate

Structure A	Structure B	Lat. A (Dec)	Long. A (Dec)	Proposed Method	Distance Breakdown (m)
JMBU	PROP MAXIS POLE 01	4.94059	103.34747	MT 3W	20
PROP MAXIS POLE 01	PROP MAXIS POLE 02	4.94078	103.34741	AERIAL	25
PROP MAXIS POLE 02	PROP MAXIS POLE 03	4.94091	103.34771	AERIAL	25
PROP MAXIS POLE 03	PROP JRC07/01	4.94112	103.34810	MT 3W	10
PROP JRC07/01	T-ST003-0105-000M	4.94112	103.34810	HDD 1-W	90



PURNAMA SOLUTION (M) SDN. BHD

Section 6

Cable Infrastructure Route Plan & Proposed Cable Plan

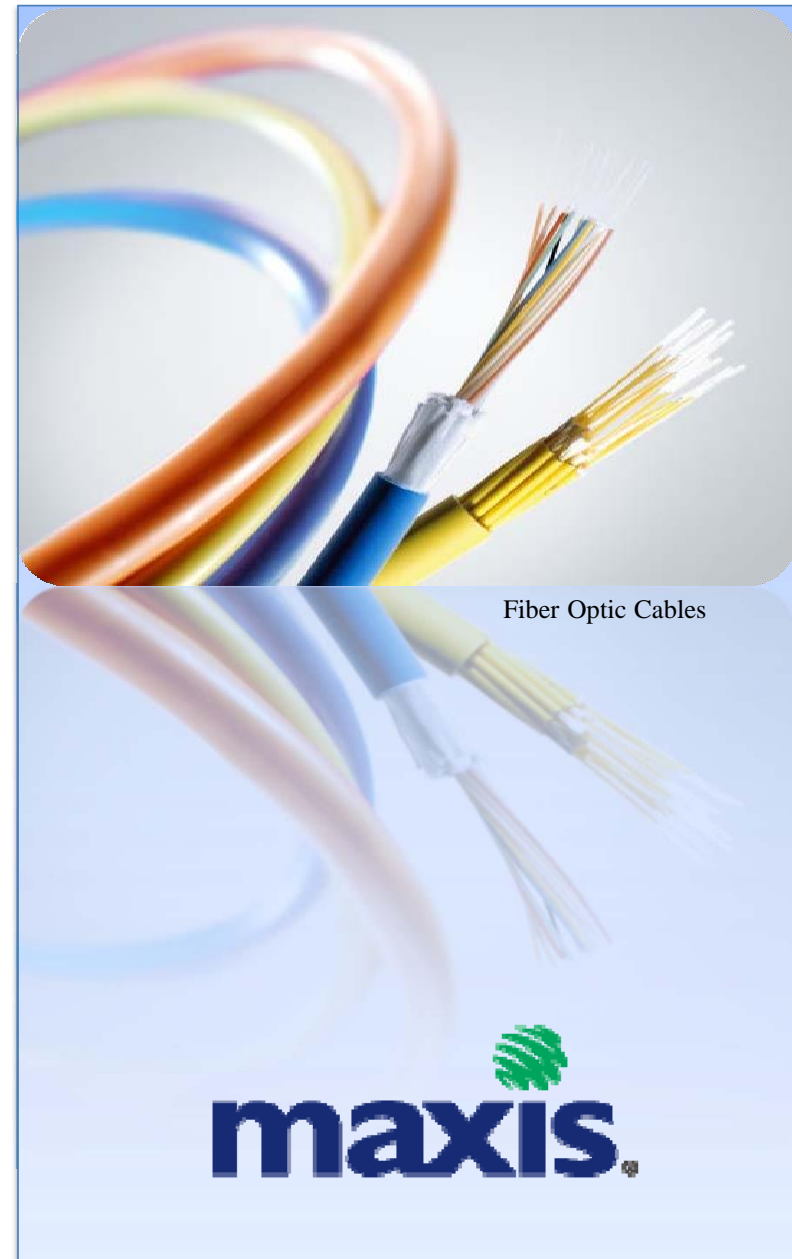

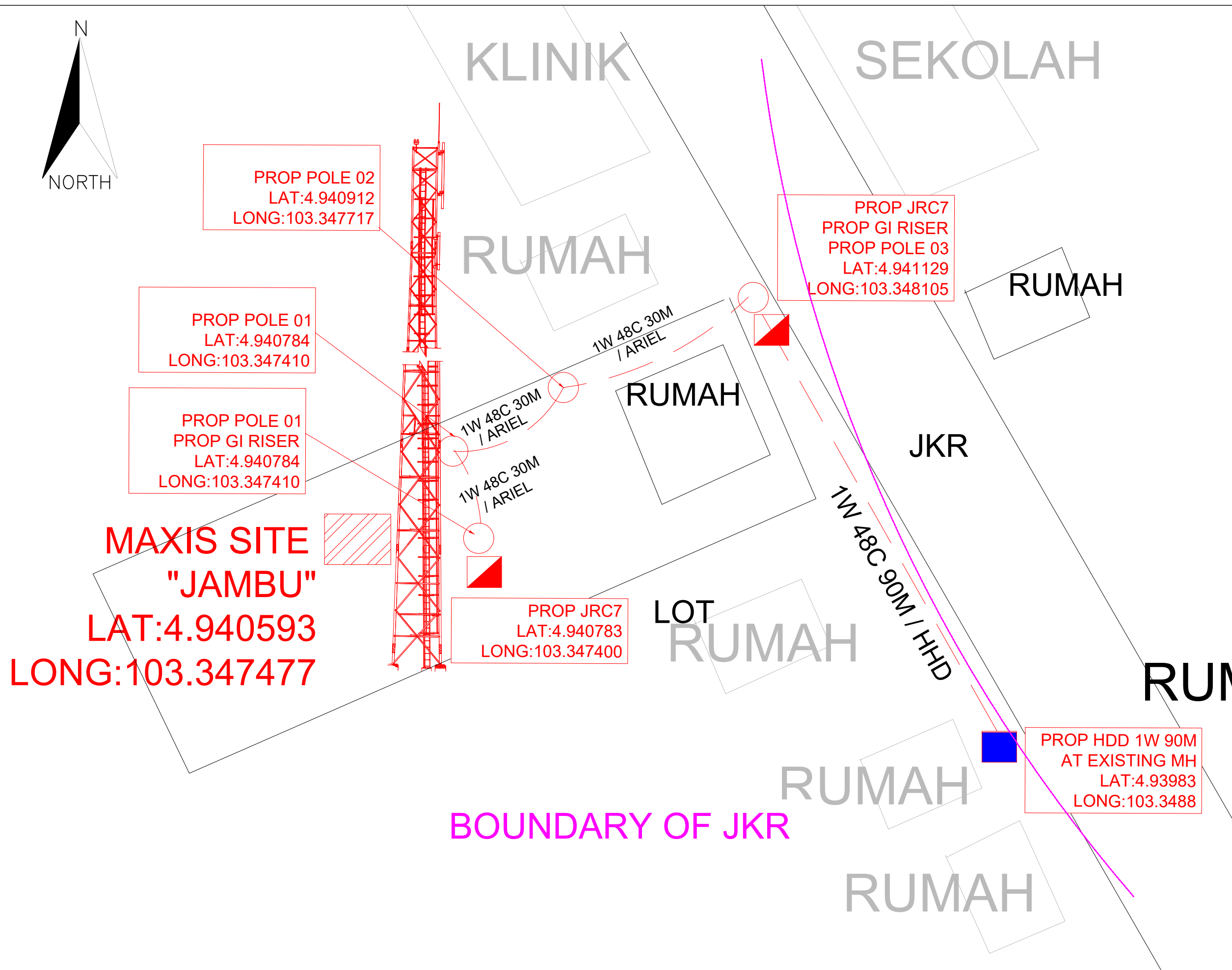
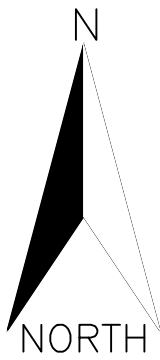

OSP Schematic Design

Site Name	JAMBU
Project Title	PROPOSED FIBRE PLAN FOR MAXIS ONNET BUILDING FIBERIZATION SITE " JAMBU "
DWG ID.	SITE BOUNDARY JAMBU
Revision No.	-
Date	17.11.2023
Sheet	-

Summary Note

Total HP/PP	-
Total FDC	-
Total FDP	-
Total Propose Joint	01
Total Propose MH	-
Total Propose Pole	06
Total Prop UG Cable (m)	1203
Total Prop OH Cable (m)	161

Legends

Propose FDC / FDF	
Existing FDC / FDF	
Propose FDP	
Existing FDP	
Propose Manhole	
Existing Manhole	
Propose Pit / Handhole	
Existing Pit / Handhole	
Propose G.i / Duct Riser	
Existing G.i / Duct Riser	
Propose Pole	
Existing Pole	
Propose Closure/Joint	
Existing UG Duct Way	
Propose UG Trenching	
Existing Aerial Cable	
Propose Aerial Cable	
FDC Boundary	
FDP Boundary	
JKR Boundary	
Local Council Boundary	

Design By PURNAMA SOLUTION (M) SDN BHD (568408 - P)



Maxis Broadband Sdn. Bhd.

Checked By	
Checked Date	
Approved / Rejected By	
Approved / Rejected Date	

MAXIS BROADBAND SDN BHD.

CABLE CUTTING PLAN

PROJECT DETAIL (OSP)	:	
PROJECT NAME	:	PROPOSED NEW CABLE FIBRE 144 CORES TO MAXIS SITE "JMBU - T-ST003-0105-000M"
PROJECT TYPE	:	
TITLE	:	
PROJECT CADE	:	
CONTRACTOR	:	Purnama Solution (M) Sdn.Bhd.
PROJECT MANAGER	:	
LOCATION	:	
QUANTITY REQUESTED	:	
REQUIRED DATE	:	

NO	SECTION		CABLE SIZE	ROUTE DISTANCE (METER)	CABLE ALLOWONES (METER)	ACTUAL CABLE LENGTH	SPLICING/ TERMINATION POINT	REMARKS
1	JMBU	TO	PROP MAXIS POLE 01	144C	20			
2	PROP MAXIS POLE 01	TO	PROP MAXIS POLE 02	144C	25			
3	PROP MAXIS POLE 02	TO	PROP MAXIS POLE 03	144C	25			
4	PROP MAXIS POLE 03	TO	PROP JRC07/01	144C	10			
5	PROP JRC07/01	TO	T-ST003-0105-000M	144C	90		SPLICING POINT	



PURNAMA SOLUTION (M) SDN. BHD



Section 7

Core Assignment Plan

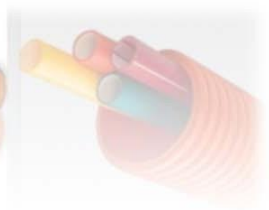
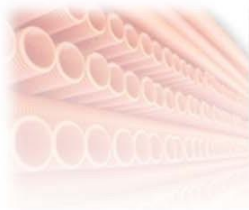

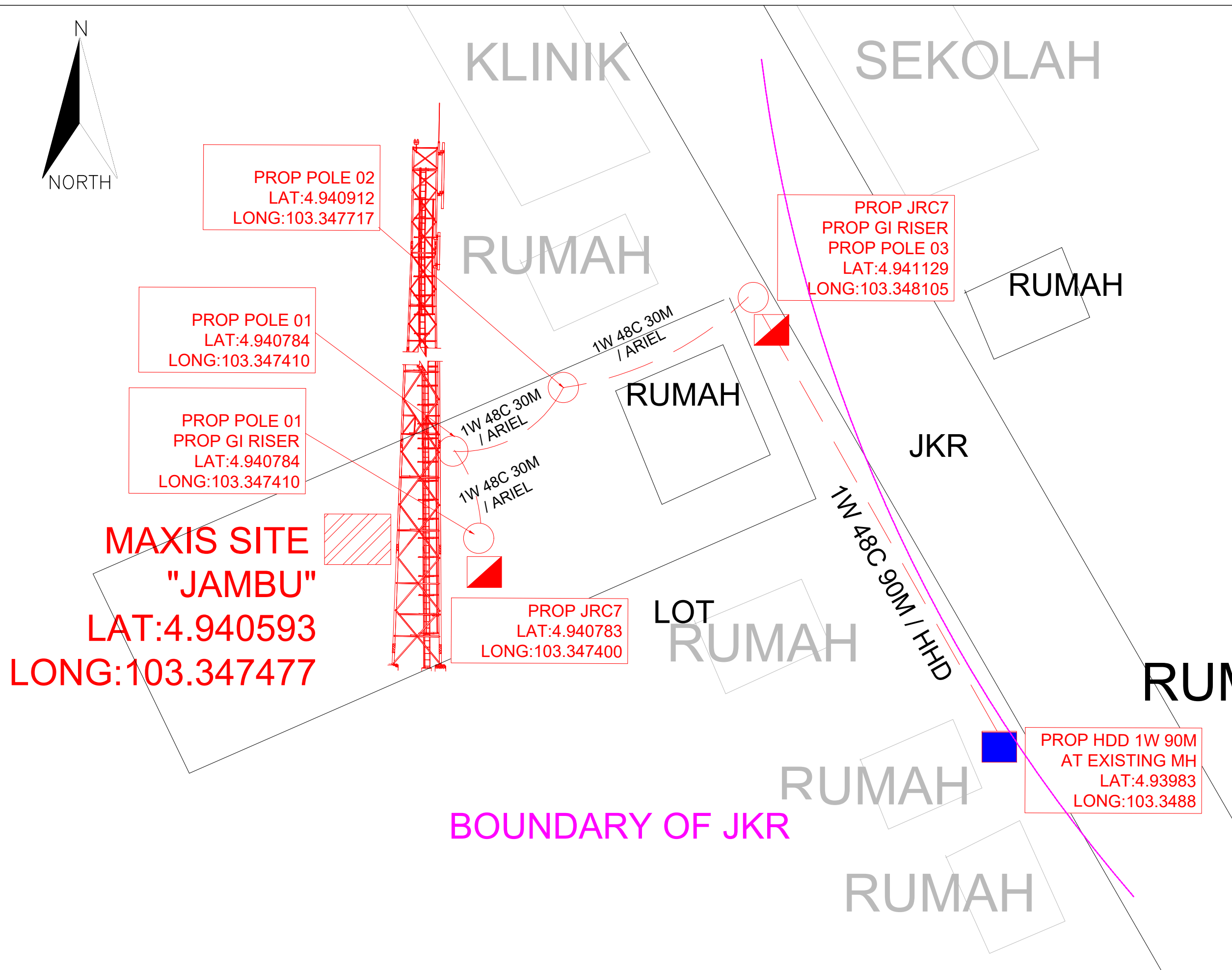
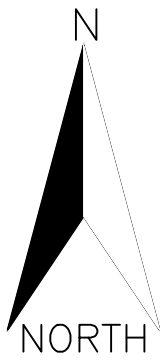

OSP Schematic Design

Site Name	JAMBU
Project Title	PROPOSED FIBRE PLAN FOR MAXIS ONNET BUILDING FIBERIZATION SITE " JAMBU "
DWG ID.	SITE BOUNDARY JAMBU
Revision No.	-
Date	17.11.2023
Sheet	-

Summary Note

Total HP/PP	-
Total FDC	-
Total FDP	-
Total Propose Joint	01
Total Propose MH	-
Total Propose Pole	06
Total Prop UG Cable (m)	1203
Total Prop OH Cable (m)	161

Legends

Propose FDC / FDF	
Existing FDC / FDF	
Propose FDP	
Existing FDP	
Propose Manhole	
Existing Manhole	
Propose Pit / Handhole	
Existing Pit / Handhole	
Propose G.i / Duct Riser	
Existing G.i / Duct Riser	
Propose Pole	
Existing Pole	
Propose Closure/Joint	
Existing UG Duct Way	
Propose UG Trenching	
Existing Aerial Cable	
Propose Aerial Cable	
FDC Boundary	
FDP Boundary	
JKR Boundary	
Local Council Boundary	

Design By PURNAMA SOLUTION (M) SDN BHD (568408 - P)



Maxis Broadband Sdn. Bhd.

Checked By	
Checked Date	
Approved / Rejected By	
Approved / Rejected Date	

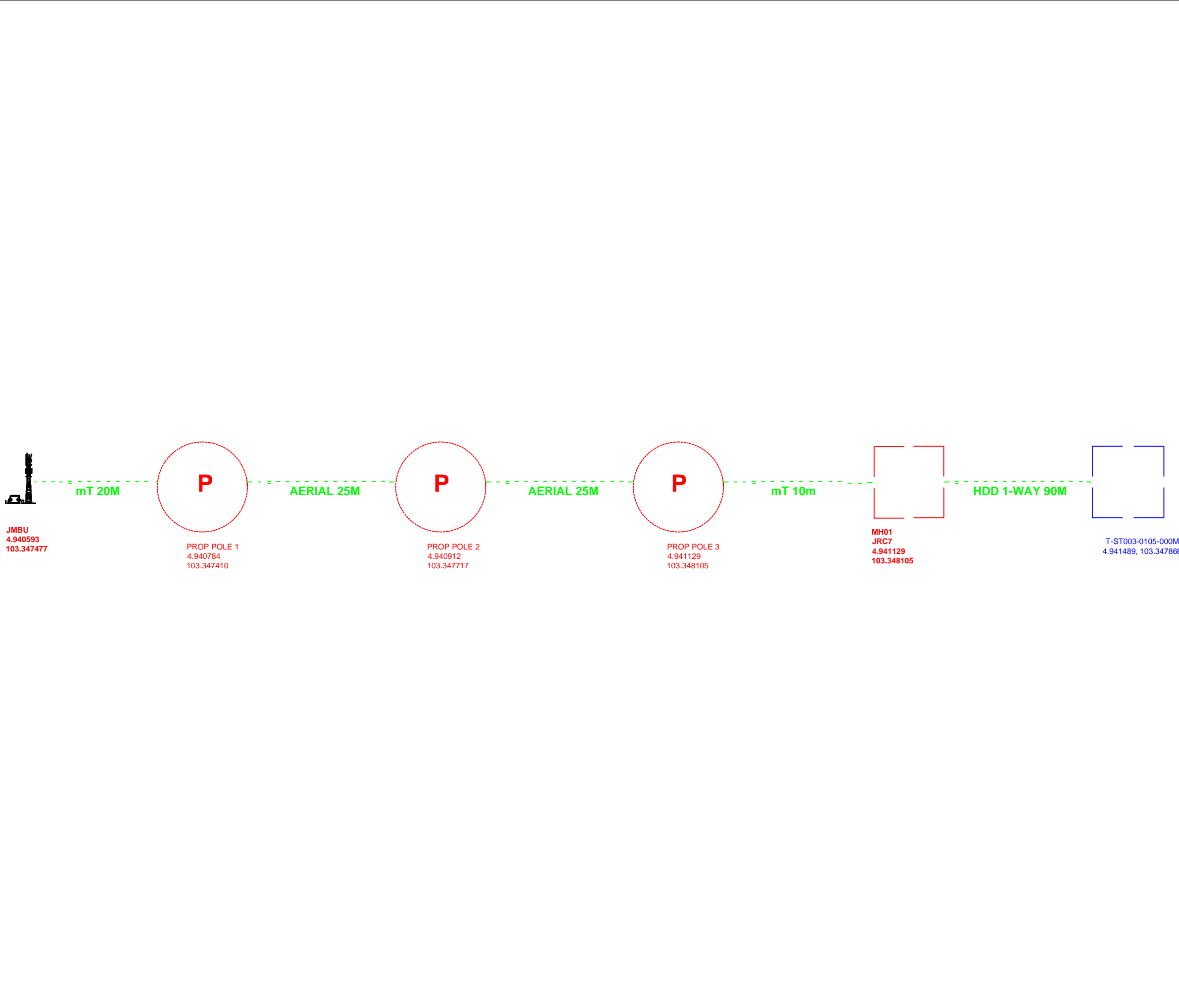

OSP Schematic Design	
Site Name	T-ST003-0105-000M
Project Title	OSP MOBILE
DWG ID.	OCK/SLD/001
Revision No.	
Date	4/4/2024
Sheet	4 / 5
Summary Note	
Total HP/PP	
Total FDC	
Total FDP	
Total Propose Joint	
Total Propose MH	1
Total Propose Pole	2
Total Prop UG Cable (m)	120
Total Prop OH Cable (m)	50
Legends	
Propose FDC / FDF	
Existing FDC / FDF	
Propose FDP	
Existing FDP	
Propose Manhole	
Existing Manhole	
Propose Pit / Handhole	
Existing Pit / Handhole	
Propose G.i / Duct Riser	
Existing G.i / Duct Riser	
Propose Pole	
Existing Pole	
Existing OF Cable	
Propose 144 C OF Cable	
Propose 96 C OF Cable	
Propose 48 C OF Cable	
FDC Boundary	
FDP Boundary	
Propose Joint / Closure	
PURNAMA SOLUTION (M) SDN BHD	
Design By	
 Maxis Broadband Sdn. Bhd.	
Checked By	
Checked Date	
Approved / Rejected By	
Approved / Rejected Date	



*Legend: *Blue* - existing (black line change to blue), *Red* - Proposed

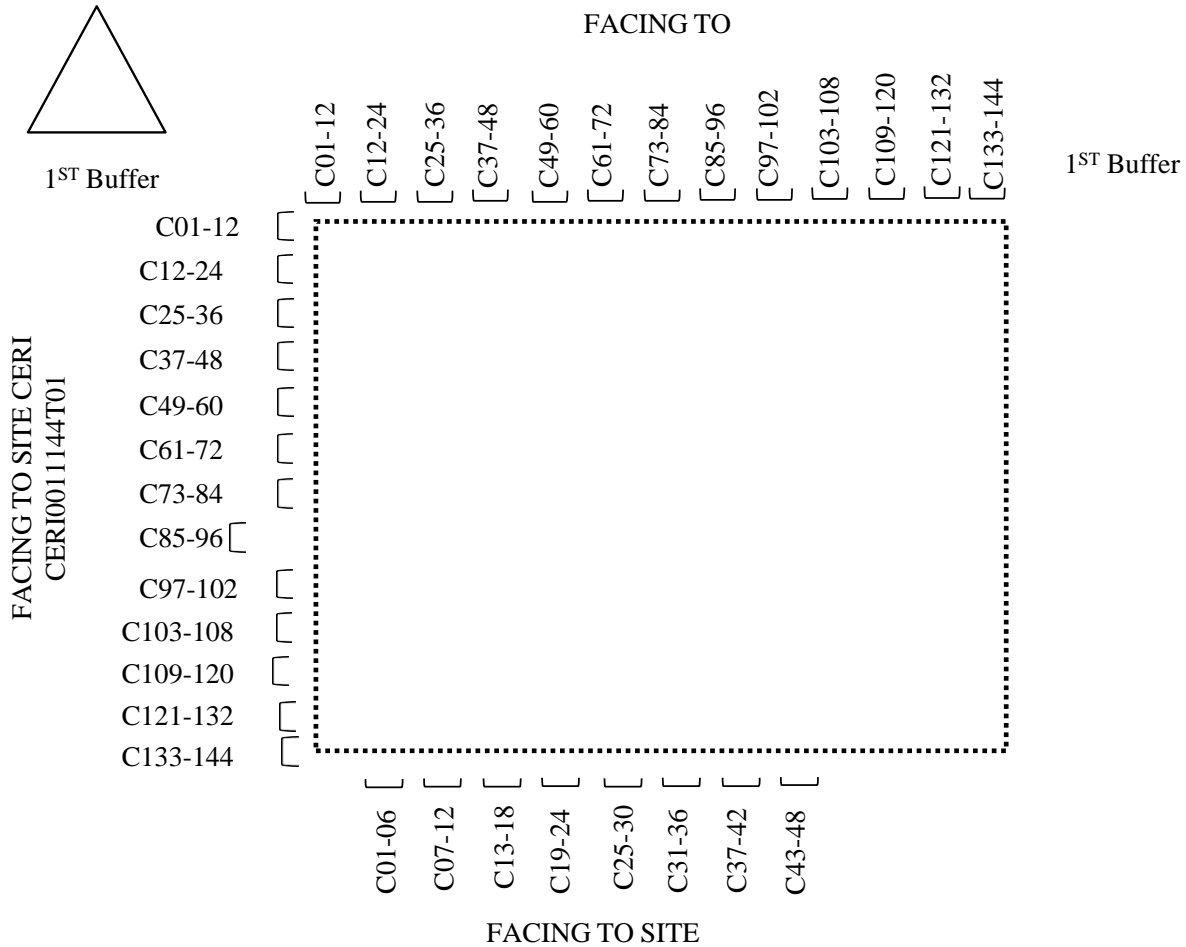

ACTUAL SPLICE CONFIGURATION NEED TO CONFIRM DURING IMPLEMENTATION AND TEAM NEED TO CONFIRM WITH CPC GROUP "INSERT PIC NAME"

LEGEND

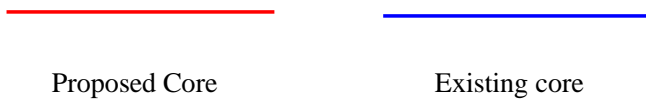

Section 8: Outside Plant Site Snapshot

Photo 1

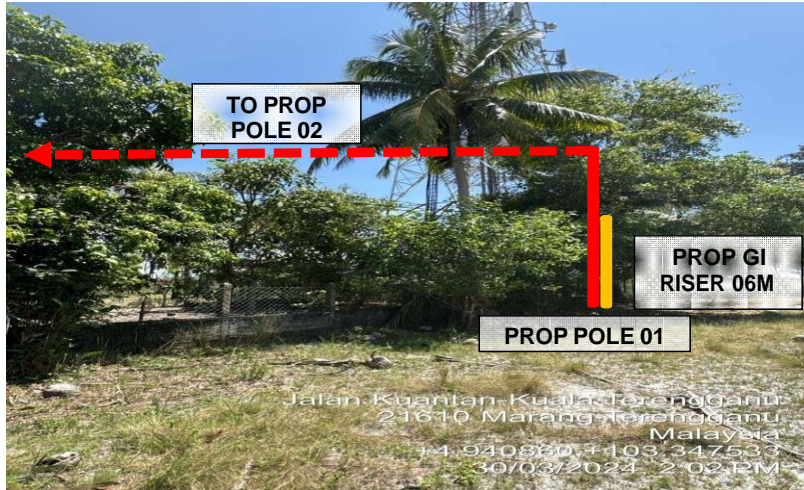

LOCATION AT JALAN MARANG TERENGGANU

Photo 2



LOCATION AT MARANG TERENGGANU

Photo 3

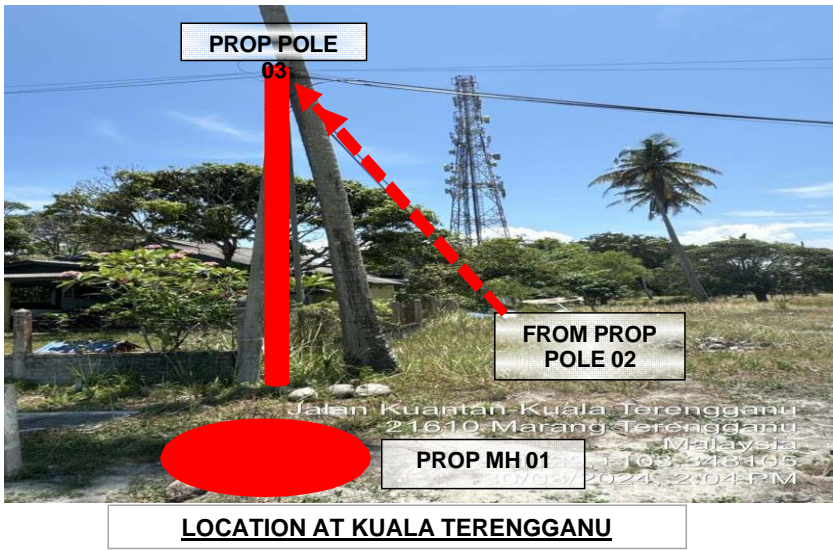

Photo 4



Photo 5



Section 9: Cabin Snapshot & Floor Plan

Schematic Plan

Photo 1



LOCATION AT "JMBU"



LOCATION AT "JMBU"



LOCATION AT "JMBU"