



JABATAN PERKHIDMATAN PEMBETUNGAN
KEMENTERIAN PERALIHAN TENAGA DAN TRANSFORMASI AIR (PETRA)

PROJEK MENAIK TARAF LOJI RAWATAN KUMBAHAN SEDIA ADA IPH072 DAN KERJA RASIONALISASI BAGI SEBAHAGIAN KAWASAN TADAHAN PEMBETUNGAN TANAH HITAM, IPOH, PERAK (REKA DAN BINA)

NO. KONTRAK : PETRA/JPP/TANAH HITAM/SCC/25/K3

Permohonan Permit Izin Lalu-Gambar Lokasi

30hb September 2025

KONTRAKTOR REKA & BINA :
I GREEN ENGINEERING SDN BHD
LEVEL B-19-05, MENARA G-VESTOR,
PAVILION EMBASSY. KOMPLEKS PAVILION
AMPANG, 200 JALAN AMPANG, 50450
KUALA LUMPUR.

**PERUNDING KEJURUTERAAN SIVIL &
STRUKTUR:**
LT CONSULTANCY
NO.29, RESERVOIR CRESENT, AYER ITAM
11500, PULAU PINANG

**PERUNDING KEJURUTERAAN
MEKANIKAL & ELEKTRIK:**
MEP ALPHA SOLUTIONS (M) SDN BHD
NO. 141 (2ND FLOOR), LORONG DESA OREN
1, TAMAN DESA OREN, SUNGAI PUYU, 13020
BUTTERWORTH, PENANG

JURUUKUR BAHAN:
JUB CENTRAL SDN BHD
BOX 513, LOT 6.13, 6TH FLOOR
WISMA CENTRAL, JALAN
AMPANG,
50450 KUALA LUMPUR

I GREEN
Engineering Sdn Bhd



Maklumat Projek

MAKLUMAT KONTRAK

1.	NAMA PROJEK	:	PROJEK MENAIK TARAF LOJI RAWATAN KUMBAHAN SEDIA ADA IPH072 DAN KERJA RASIONALISASI BAGI SEBAHAGIAN KAWASAN TADAHAN PEMBETUNGAN TANAH HITAM, IPOH, PERAK (REKA DAN BINA)
2.	NO. KONTRAK	:	PETRA/JPP/TANAH HITAM/SCC/25/K3
3.	KOS KONTRAK	:	RM 32,569,105.00
4.	PEMILIK PROJEK	:	KEMENTERIAN PERALIHAN TENAGA DAN TRANSFORMASI AIR
5.	AGENSI PELAKSANA	:	JABATAN PERKHIDMATAN PEMBETUNGAN (JPP)
6.	KONTRAKTOR (REKA & BINA)	:	I GREEN ENGINEERING SDN BHD
7.	PERUNDING SIVIL & STRUKTUR	:	LT CONSULTANCY
8.	PERUNDING MEKANIKAL & ELEKTRIK	:	MEP ALPHA SOLUTIONS (M) SDN BHD
9.	PERUNDING UKUR BAHAN	:	JUB CENTRAL SDN BHD
10.	TARIKH MILIK TAPAK	:	17 JUN 2025
11.	TARIKH SIAP PROJEK	:	16 JUN 2028
12.	TEMPOH KONTRAK	:	36 BULAN
13.	TEMPOH TANGGUNGAN KECACATAN	:	24 BULAN
14.	<i>LIQUIDATED ASCERTAINED DAMAGES (LAD)</i>	:	RM 5,927.58 SEHARI

LOKASI PROJEK



LOKASI PROJEK



Cadangan Laluan Pipe Network

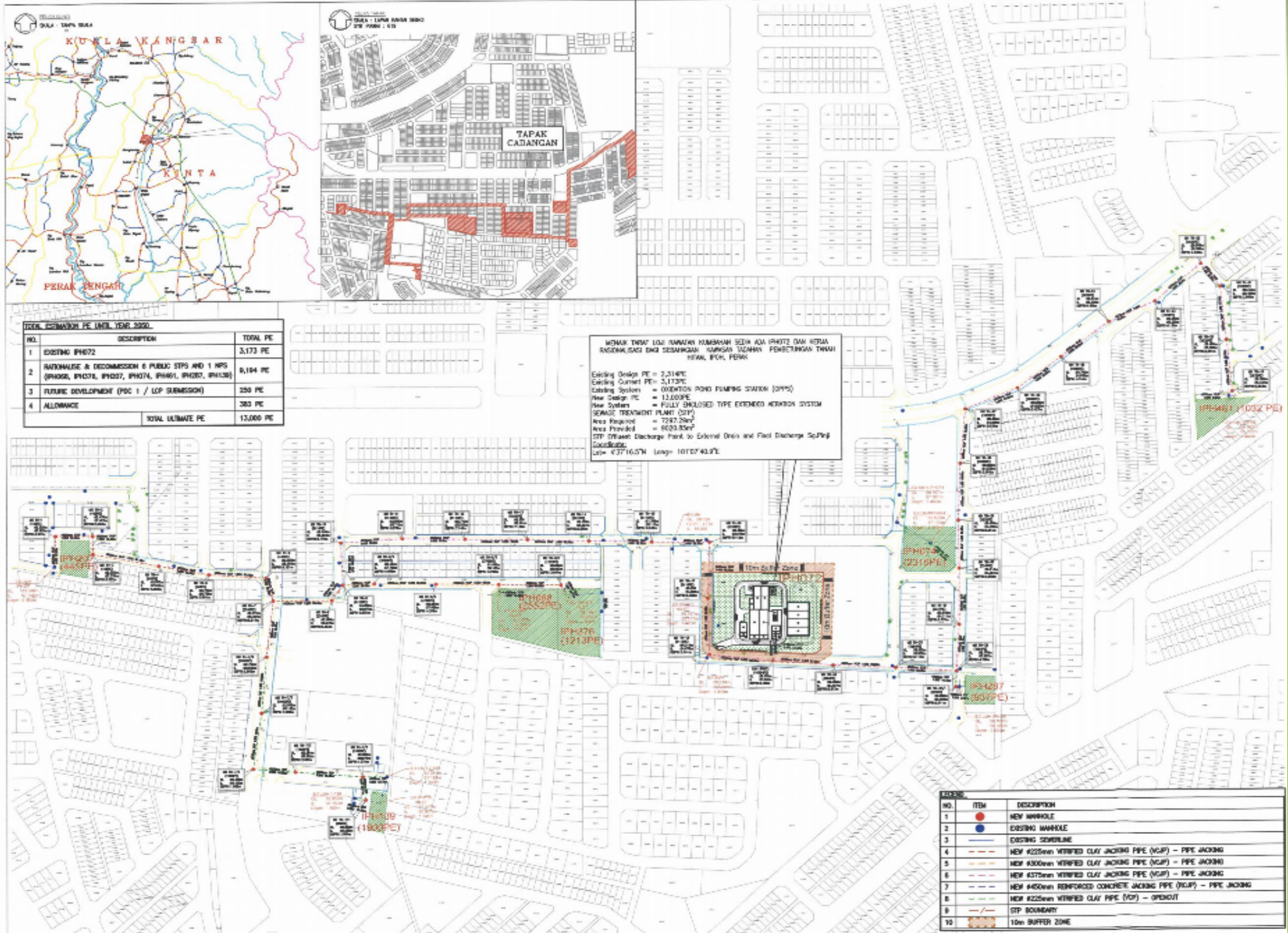

LOKASI PROJEK (IPH072, IPH287, IPH074, IPH1032)

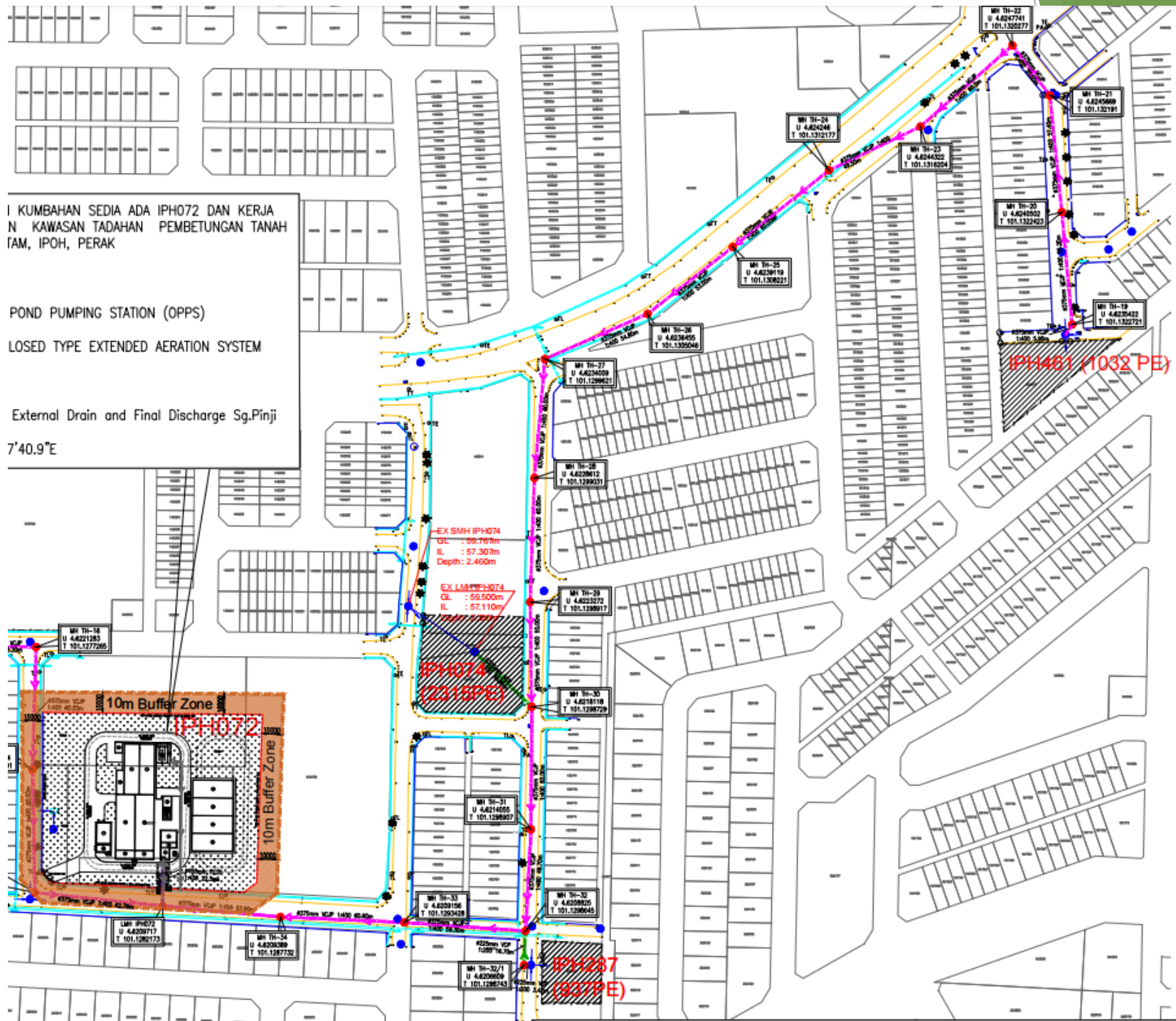

LOKASI PROJEK IPH072 to IPH287



375 dia.vcjp Jacking work

LOKASI PROJEK IPH 287 to IPH 074



375 dia.vcjp Jacking work and 225 dia. vcp open cut work

LOKASI PROJEK IPH 074 to MH TH 27



375 dia.vcjp Jacking work

LOKASI PROJEK MH TH 27 to MH TH 22



375 dia.vcjp Jacking work

LOKASI PROJEK MH TH 22 to IPH 461

Jalan Ipoh Timur Baru 5
Ipoh, Perak
Google Street View
Nov 2024 See more dates

Share X



375 dia.vcjp Jacking work

LOKASI PROJEK (IPH376, IPH068, IPH139 & IPH 207)

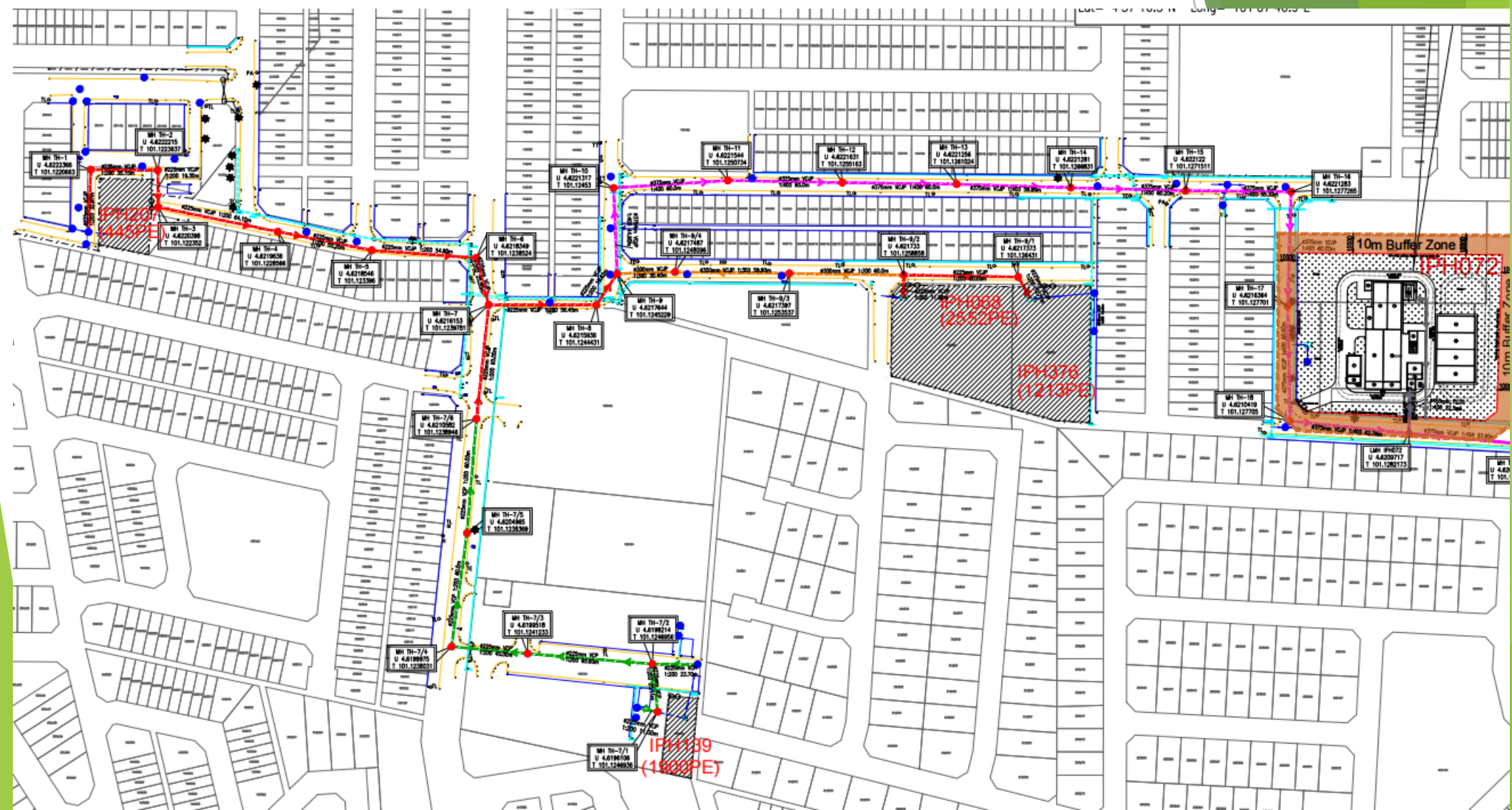

LOKASI PROJEK MH TH 18 to MH TH 16

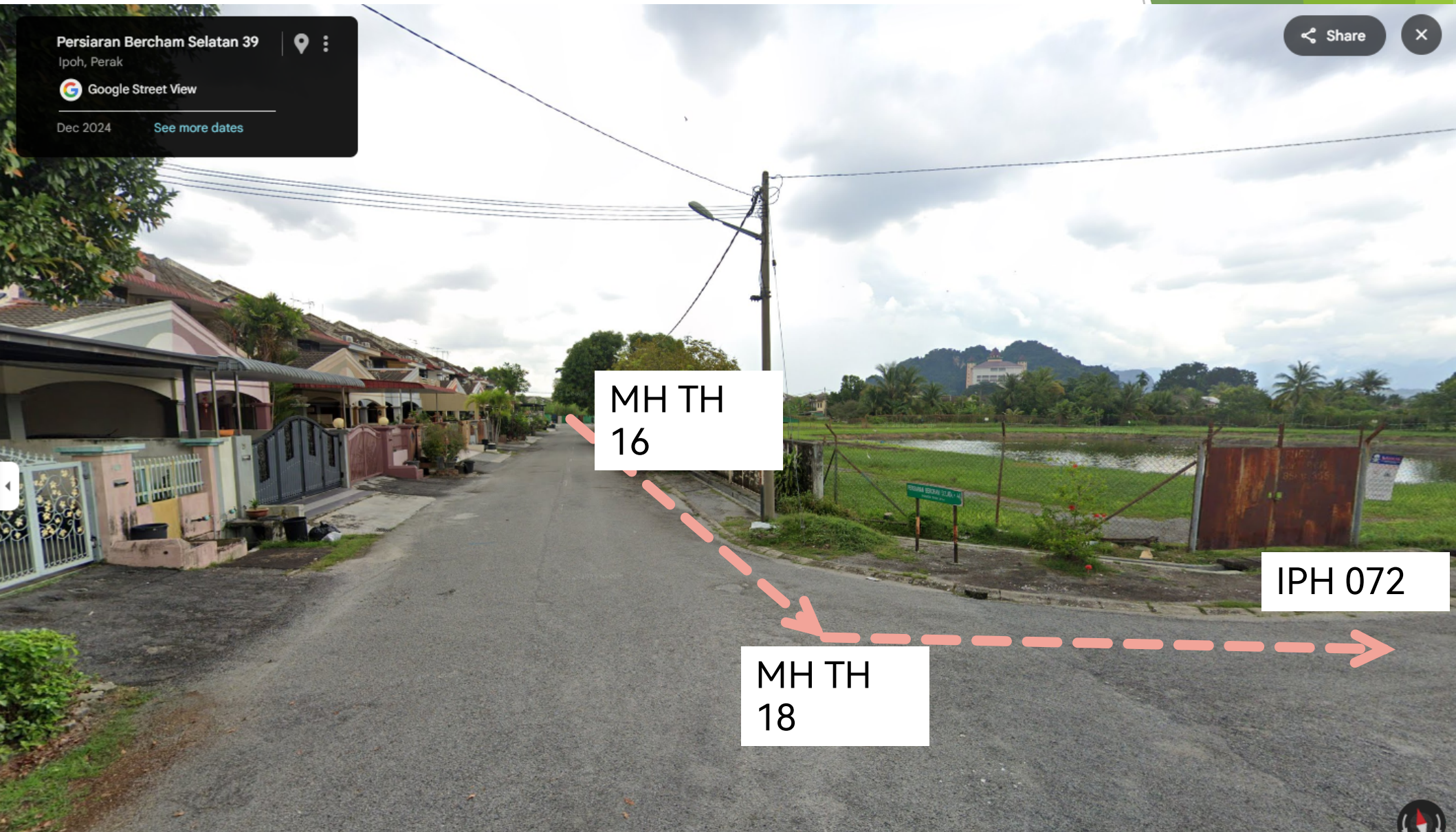

375 dia.vcjp Jacking work

LOKASI PROJEK MH TH 16 to MH TH 10

56 Persiaran Bercham Selatan 42

Ipoh, Perak

Google Street View

Dec 2024

[See more dates](#)

Share

X

MH TH
10

MH TH
16

375 dia.vcjp Jacking work



LOKASI PROJEK MH TH 9 to IPH 376 & IPH 068



225, 300 & 375 dia.vcjp Jacking work

LOKASI PROJEK MH TH 7 to MH TH 7/4



225 dia.vcjp Jacking work and 225 dia. vcp open cut work

LOKASI PROJEK MH TH 7/4 to IPH 139



225 dia.vcp open cut

LOKASI PROJEK MH TH 6 to IPH 207

17 Laluan Perajurit 1

Ipoh, Perak

Google Street View

Dec 2024 [See more dates](#)

Share

X

Collapse side panel

IPH 207

MH TH 6

225 dia.vcjp Jacking work



Terima Kasih

The background features abstract, overlapping geometric shapes in various shades of green, ranging from light lime to dark forest green. These shapes are primarily located on the right side of the frame, creating a modern, layered effect. The rest of the background is plain white.