

SUBMISSION DRAWING

GENERAL NOTE:
 ALL DIMENSION HAS TO BE VERIFIED AND CONFIRMED ON SITE.
 ANY DISCREPANCY HAS TO BE REPORTED TO THE PERSON
 IN-CHARGE BEFORE PROCEEDING WITH ANY CONSTRUCTION

| ITEM | DATE | AMENDMENT |
|------|------|-----------|
| | | |
| | | |
| | | |

OWNER'S SIGNATURE :
 BKS HOME SDN. BHD. (NO. SYARIKAT: 948921-T)

ENGINEER'S SIGNATURE :

COPYRIGHT (C) OF MOKHTAR CONSULT & ASSOCIATES
 ALL RIGHTS RESERVED.
 THIS DRAWING IS COPYRIGHT EXCEPT FOR THE CONSTRUCTIONS OF THE PROJECT NAMED HEREIN.
 NO PART OF THIS DRAWING SHOULD BE REPRODUCED BY ANY MEANS NOR TRANSMITTED IN TO
 MACHINE LANGUAGE OR USE FOR THE CONSTRUCTIONS OF OTHER PROJECTS DIFFERENT FROM
 THAT NAMED HEREIN WITHOUT THE WRITTEN PERMISSIONS OF MOKHTAR CONSULT & ASSOCIATES

PROJECT :
 PERMOHONAN PERMIT KOREK JALAN BAGI CADANGAN MEMBINA 25 UNIT
 RUMAH TERES 2 TINGKAT YANG MENDUNGI PLOT 1 HINGGA PLOT 25
 DI ATAS LOT 1531 (GM 2884) SELUAS 2.057 EKAR,
 MUKIM KOTA LAMA KIRI, DAERAH KUALA KANGSAR,
 PERAK DARUL RIDZUAN

UNTUK TETUAN
 BKS HOME SDN. BHD.

TITLE :
 SITE, LOCATION & KEY PLAN
 TELEPHONE INFRASTRUCTURE PLAN







MOKHTAR CONSULT & ASSOCIATES
 CIVIL, STRUCTURAL, MECHANICAL & ELECTRICAL
 CONSULTING ENGINEERS

 9A-11A, JALAN CHUNG THYE PHIN,
 30250 IPOH, PERAK DARUL RIDZUAN.
 TEL : 05-2544198, 2535175
 FAX : 05-2544270

| | |
|---|---|
| SCALE : AS SHOWN | CHECKED BY : Ir JOE CHENG |
| DATE : 18-03-2025 | APPROVED BY : Ir. JOE CHENG |
| DRAWN BY : HONG | |
| ACAD FILE : BKS LOT 1531(TM).dwg | |
| <input type="radio"/> PRELIMINARY DRAWING | <input type="radio"/> CONSTRUCTION DRAWING |
| <input type="radio"/> TENDER DRAWING | <input type="radio"/> AS-BUILT DRAWING |
| <input checked="" type="radio"/> SUBMISSION DRAWING | <input type="radio"/> APPROVED FOR ISSUANCE |

DRAWING NO. CKJ/MCA/6369/18/KUDR-01 A3

LEGEND :

| | |
|---|--|
|  | EXISTING TM MANHOLE |
|  | EXISTING TM PIT |
|  | EXISTING TM POLE |
|  | PROPOSED TM POLE |
|  | PROPOSED TEL. PIT / JB30 (PRE-FAB) |
|  | PROPOSED 1 LAYER 2 NOS. 100Ø UPVC PIPE LAID IN GROUND TO BE BURIED WITH SAND C/W DRAW WIRE |

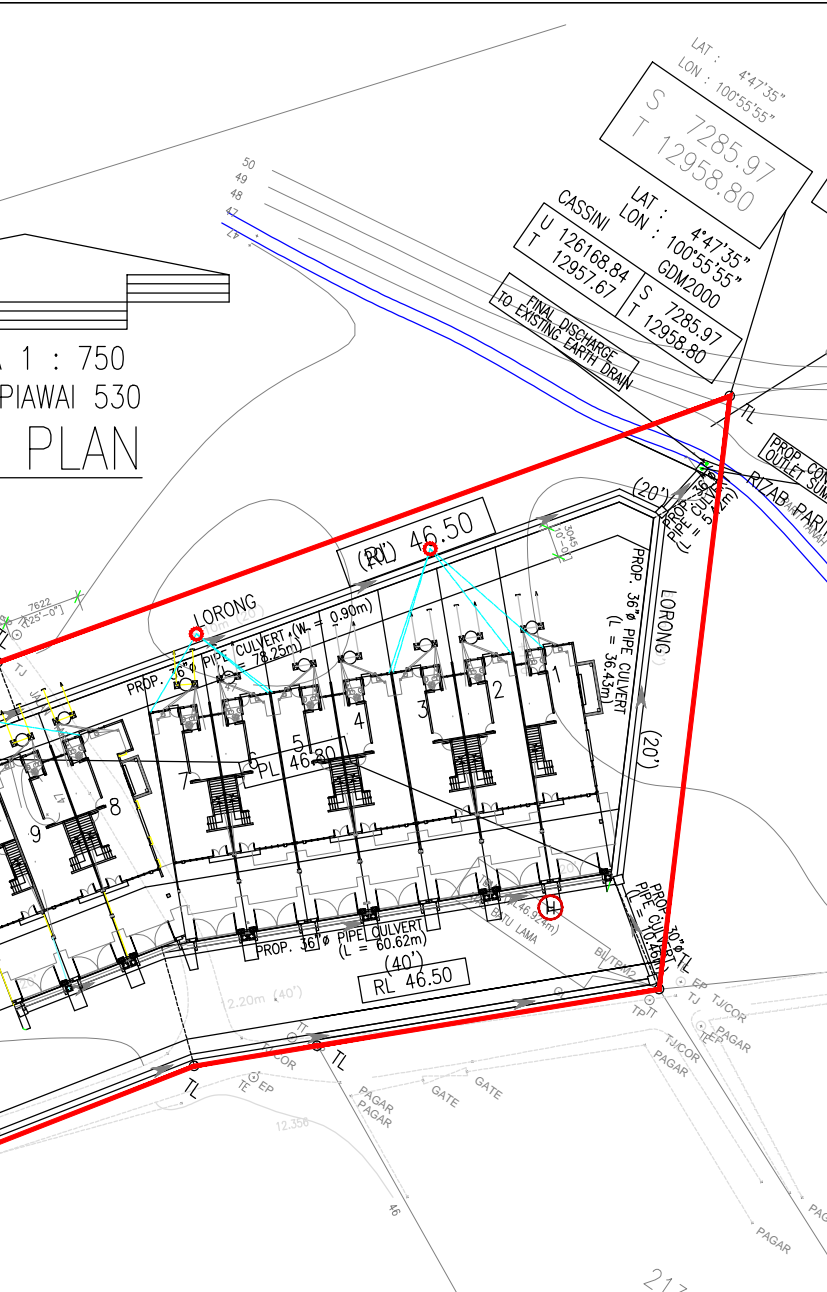
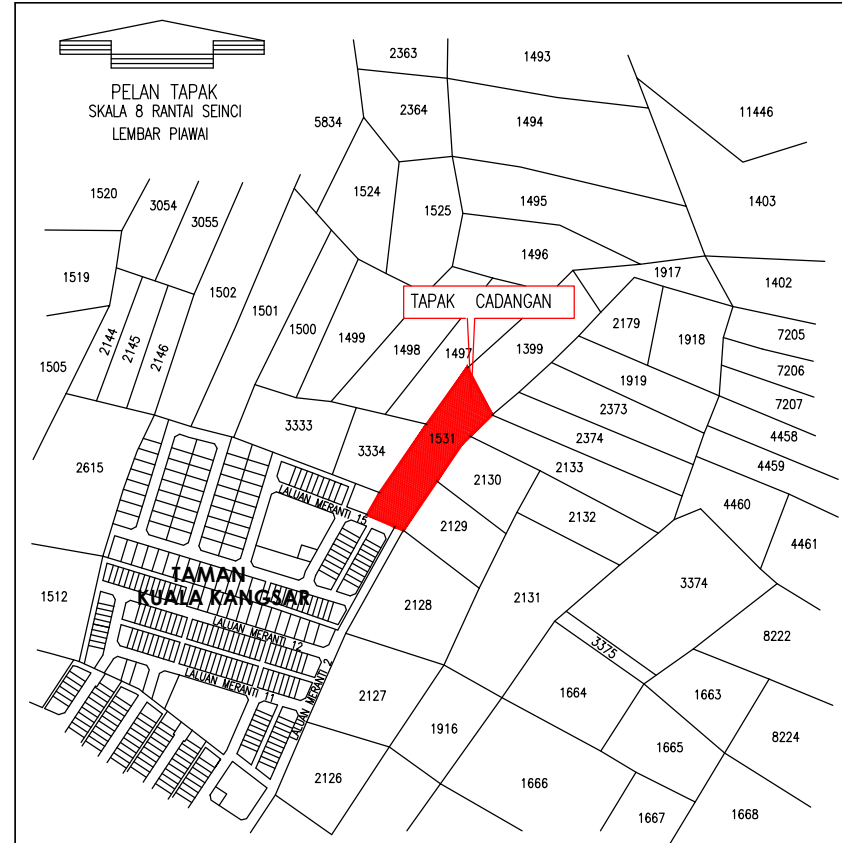

K SEDIA ADA
 PERSEKUTUAN 1
 (L/K : 4 KM)