

Technical Proposal for TM Project

SYARIKAT OSMANIA LOGISTICS SDN BHD
(7338-T)



| | |
|-----------------------------|---|
| Project Description: | SRR FTTH KTS_CXXX Taman Klebang Perdana |
| Project Number: | TMNA/251360 |
| TM Node | KTS (Kampung Tawas) |
| Region | Northern |
| NE ID | KTS_C032 |
| Total FTTH Ports | 64 |
| Total Property | 189 |
| PF (%) | 34% |
| RFSI Date | 30 APRIL 2025 |
| GPS Coordinate | 4.679636° 101.127874° |

| | |
|----------------------|--------------------------------------|
| Prepared by: | BASRI |
| Company Name: | SYARIKAT OSMANIA LOGISTICS SDN. BHD. |
| Date: | 23/4/2025 |
| TP Revision: | 1 |

3.1 New Pole Plan

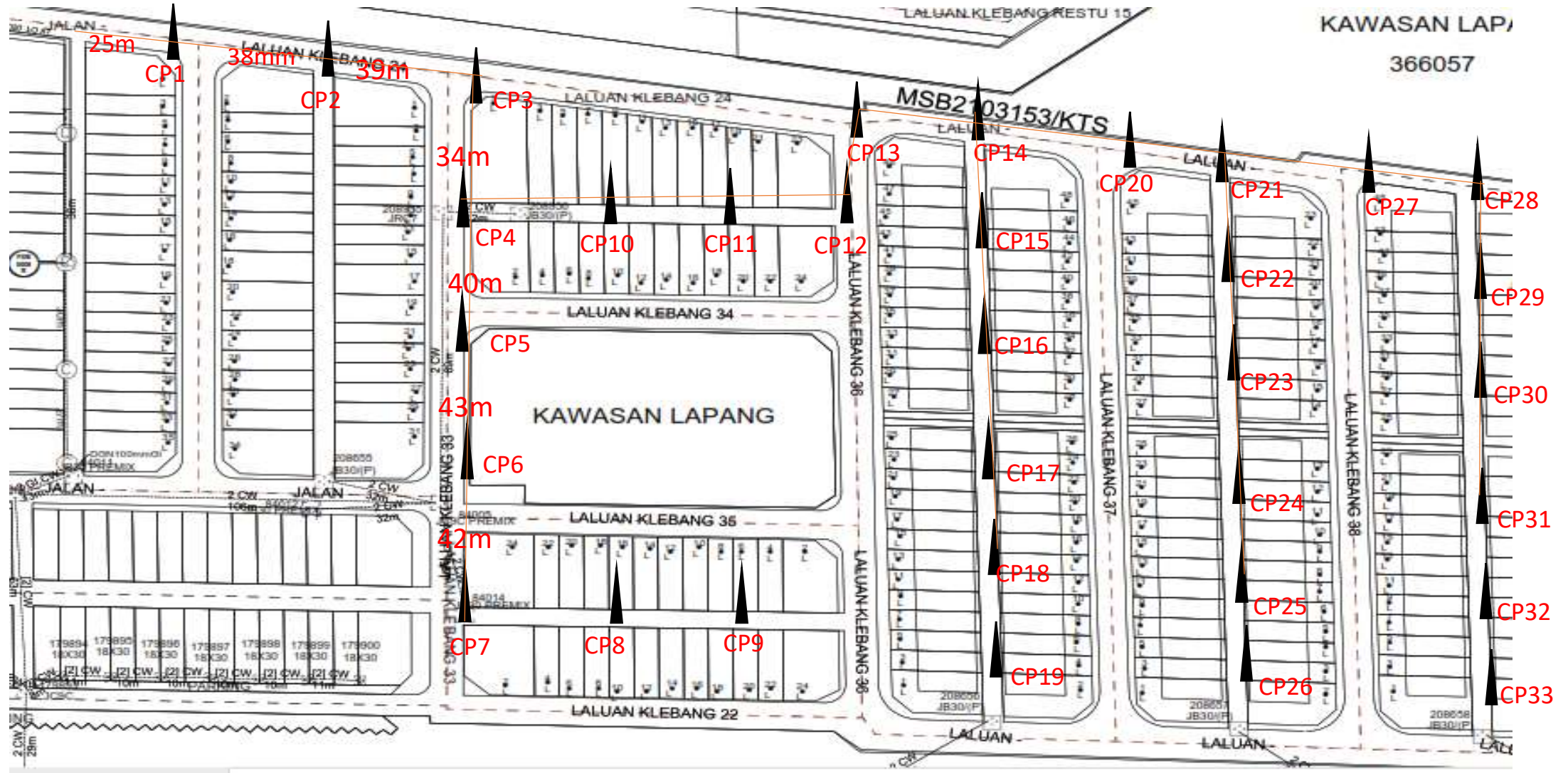

Legend:

-  FDC
-  FDP
-  JT FOSC
-  POLE

3.1 New Pole Plan

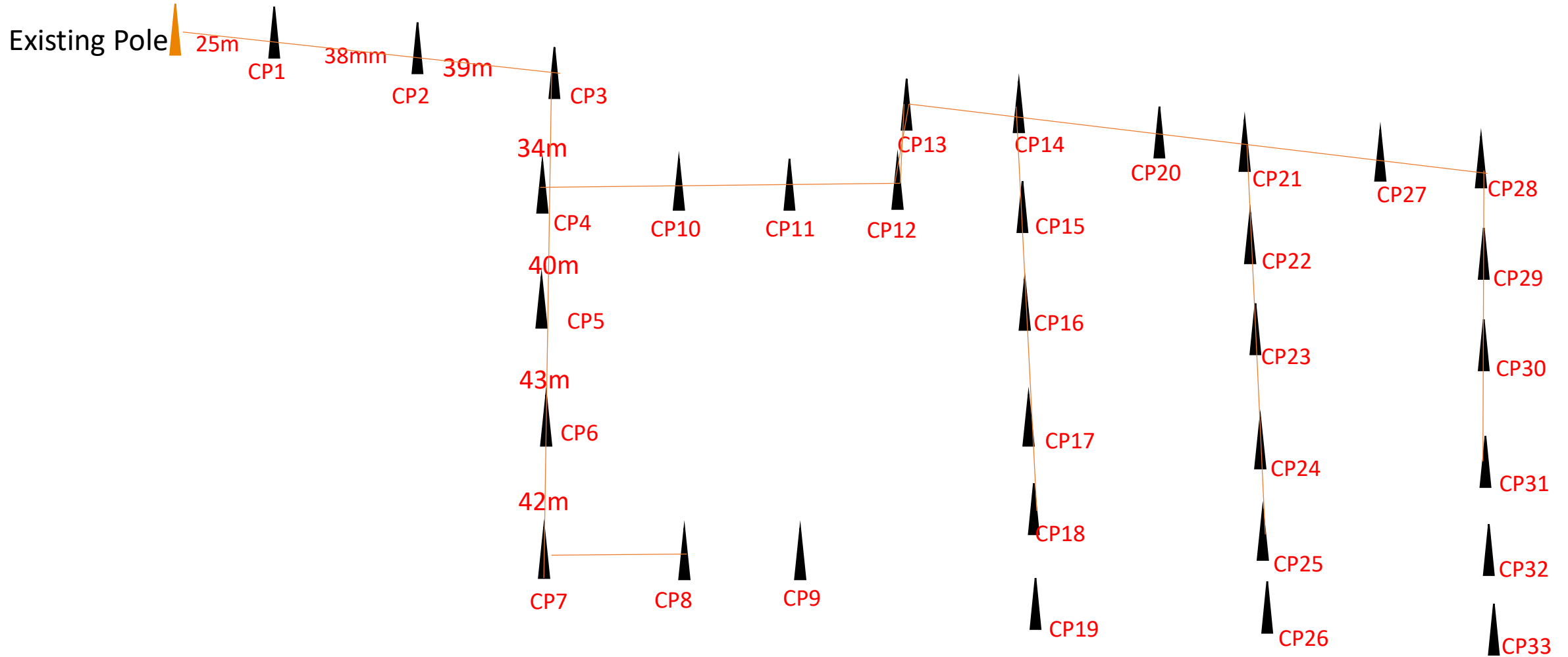

Legend:

| | | | | | | | |
|---|-----|---|-----|--|------|---|------|
|  | FDC |  | FDP |  | FOSC |  | POLE |
|---|-----|---|-----|--|------|---|------|

3.2 New Pole details

| No | POLE ID | Pole Type | GPS Coordinate |
|----|---------|--------------------|-----------------------|
| 1 | 1 | Concrete Pole 7.5m | 4.680609°101.125843° |
| 2 | 2 | Concrete Pole 7.5m | 4.680513° 101.126189° |
| 3 | 3 | Concrete Pole 7.5m | 4.680486° 101.126538° |
| 4 | 4 | Concrete Pole 7.5m | 4.680248 101.126501°° |
| 5 | 5 | Concrete Pole 7.5m | 4.679880° 101.126525° |
| 6 | 6 | Concrete Pole 7.5m | 4.679470° 101.126493° |
| 7 | 7 | Concrete Pole 7.5m | 4.679067° 101.126490° |
| 8 | 8 | Concrete Pole 7.5m | 4.67906° 101.126816 |
| 9 | 9 | Concrete Pole 7.5m | 4.679075° 101.127072° |
| 10 | 10 | Concrete Pole 7.5m | 4.680233°101.126840° |
| 11 | 11 | Concrete Pole 7.5m | 4.680165° 101.127082° |
| 12 | 12 | Concrete Pole 7.5m | 4.680173° 101.127268° |
| 13 | 13 | Concrete Pole 7.5m | 4.680378° 101.127274° |
| 14 | 14 | Concrete Pole 7.5m | 4.680378° 101.127605° |
| 15 | 15 | Concrete Pole 7.5m | 4.679796° 101.127630° |
| 16 | 16 | Concrete Pole 7.5m | 4.679471° 101.127621° |
| 17 | 17 | Concrete Pole 7.5m | 4.679266°101.127620 |

3.2 New Pole details

| No | POLE ID | Pole Type | GPS Coordinate |
|----|---------|--------------------|-----------------------|
| 18 | 18 | Concrete Pole 7.5m | 4.679194°101.127620° |
| 19 | 19 | Concrete Pole 7.5m | 4.678981° 101.127618° |
| 20 | 20 | Concrete Pole 7.5m | 4.680332° 101.127968° |
| 21 | 21 | Concrete Pole 7.5m | 4.680299° 101.128167° |
| 22 | 22 | Concrete Pole 7.5m | 4.679952 °101.128178 |
| 23 | 23 | Concrete Pole 7.5m | 4.679678° 101.128178° |
| 24 | 24 | Concrete Pole 7.5m | 4.679357°101.128168° |
| 25 | 25 | Concrete Pole 7.5m | 4.679136° 101.128165° |
| 26 | 26 | Concrete Pole 7.5m | 4.678968° 101.128159° |
| 27 | 27 | Concrete Pole 7.5m | 4.680265° 101.128512° |
| 28 | 28 | Concrete Pole 7.5m | 4.680245° 101.128736° |
| 29 | 29 | Concrete Pole 7.5m | 4.679967°101.128729° |
| 30 | 30 | Concrete Pole 7.5m | 4.679696° 101.128730° |
| 31 | 31 | Concrete Pole 7.5m | 4.679416° 101.128722° |
| 32 | 32 | Concrete Pole 7.5m | 4.679149° 101.128712° |
| 33 | 33 | Concrete Pole 7.5m | 4.678934° 101.128710° |
| | | | |

3.3 New Pole Illustration

