

DATE	07/07/2025
SCALE	NIS
NO. OF NETWORK DEVELOPMENT SECTION	01
TYPE	GENERAL
CHECKED BY	MR. M. M. M.
DESIGNED BY	MR. M. M. M.
APPROVED BY	MR. M. M. M.
PROJECT NO.	010/2025/001/01
PROJECT TITLE	PROPOSED GAS FEEDING ROUTE

PROJECT TITLE: EFFECT OF NATURAL GAS DISTRIBUTION SYSTEM TO TAPAH STAGE 1/25

DATE: 22/12/25

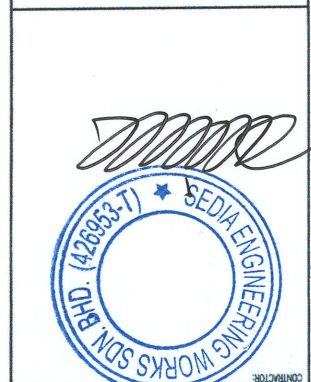

OWNER: GAS MALAYSIA DISTRIBUTION SDN BHD. NO. 20, GROUND FLOOR, JALAN MEDAN DAMANSARA, 50480 KUALA LUMPUR.

NO.	DATE	DESCRIPTION	BY

NO.	DATE	DESCRIPTION	BY

NO.	DESIGN DETAILS	VALUE
1	PRELIME SYSTEM	N/A
2	DESIGN CODE	MSCE 431.8
3	DESIGN PRESSURE / MOP	2463 Hg _g
4	DESIGNING PRESSURE	10.4-2463 Hg _g
5	MIN. SPECIFIED TEST PRESSURE	2774 Hg _g
6	MATERIAL	STEEL
7	CLASS LOCATION	4
8	DESIGN TEMPERATURE	15-55°C
9	FLAMMABLE	N/A

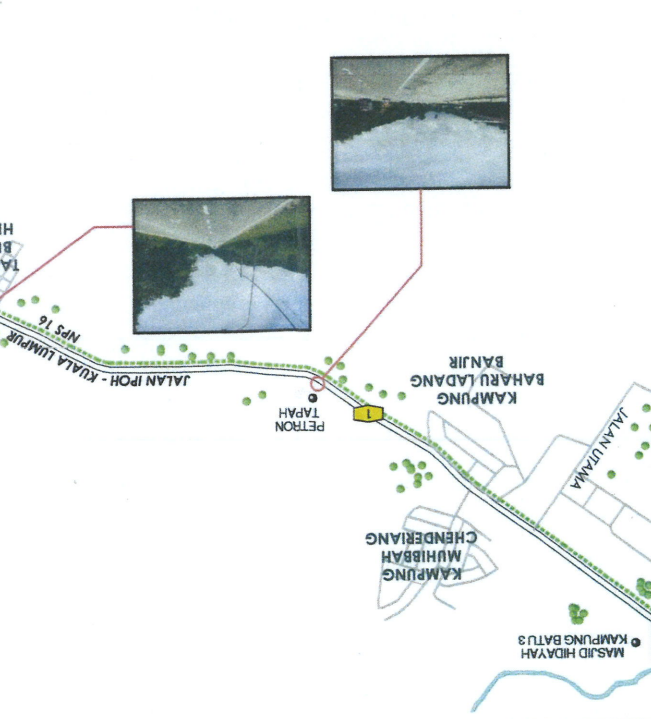
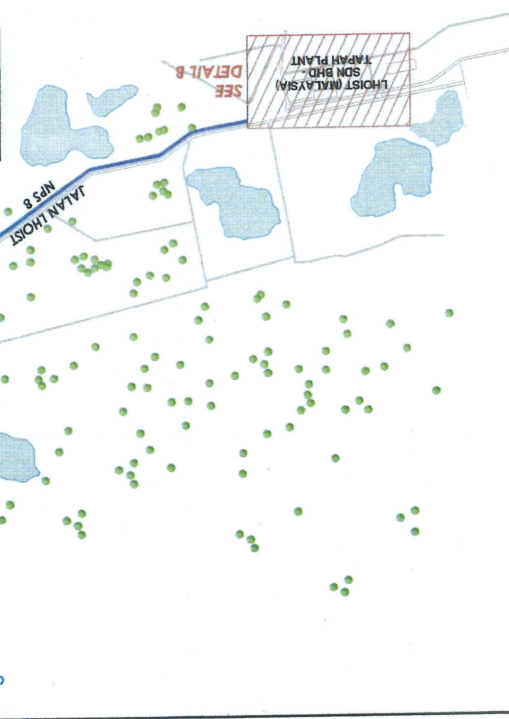
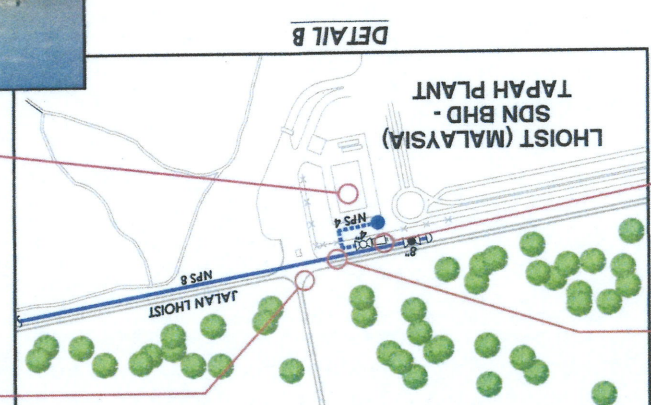
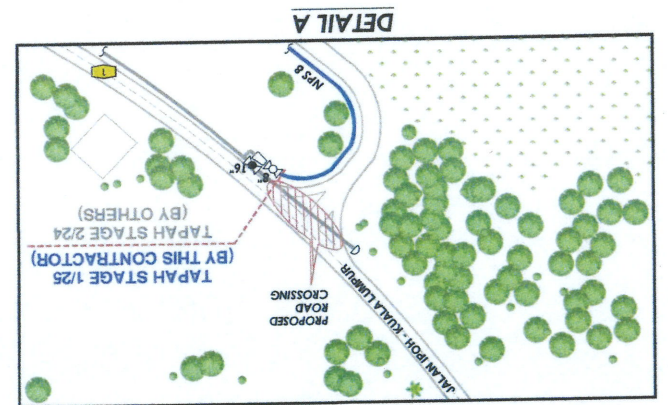
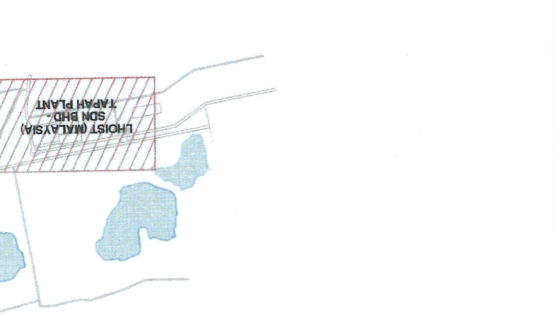
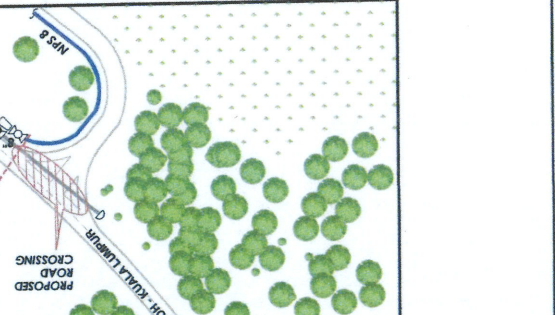
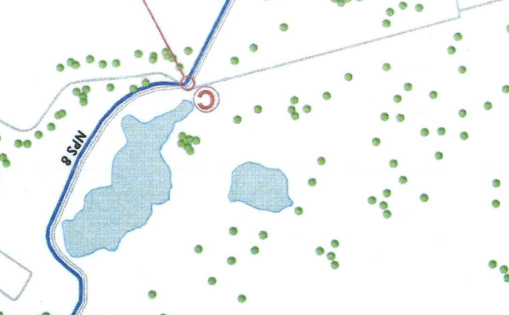
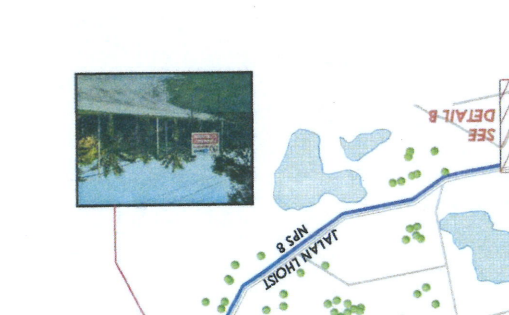
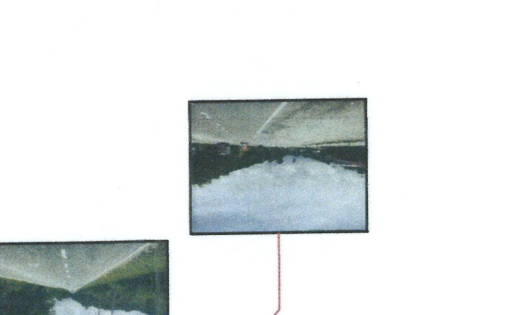
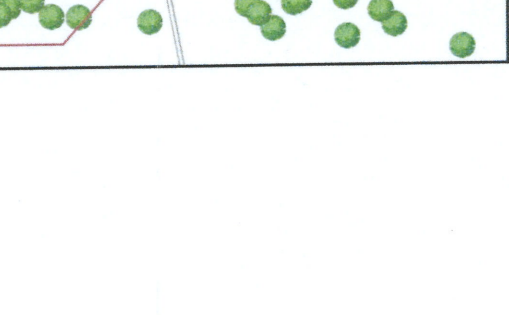
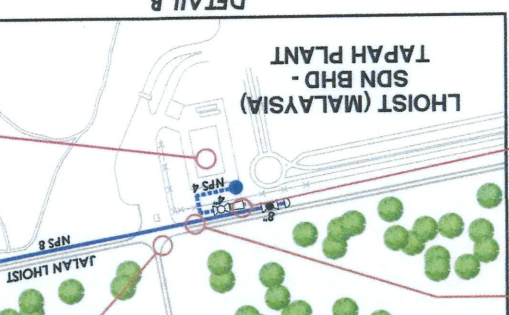
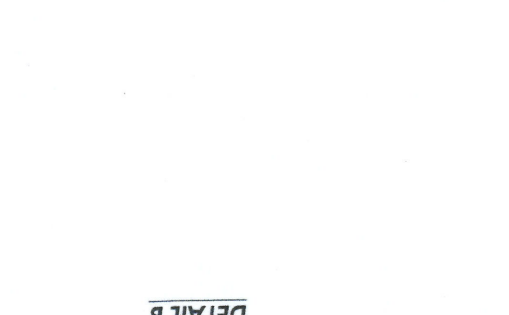
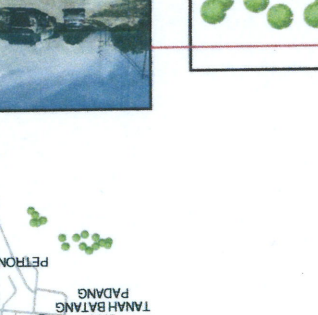
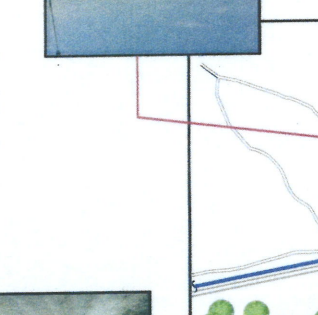
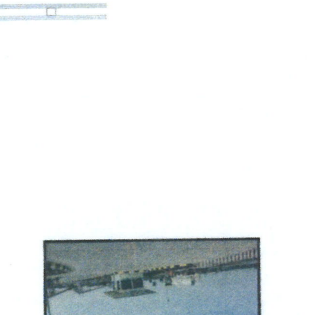
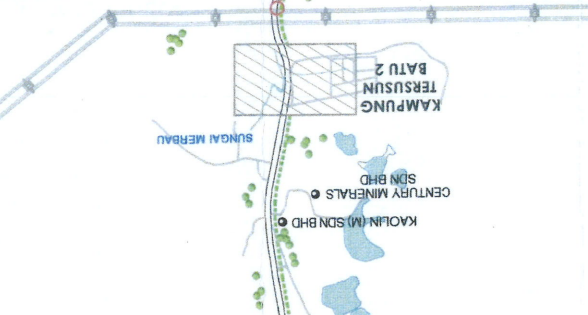
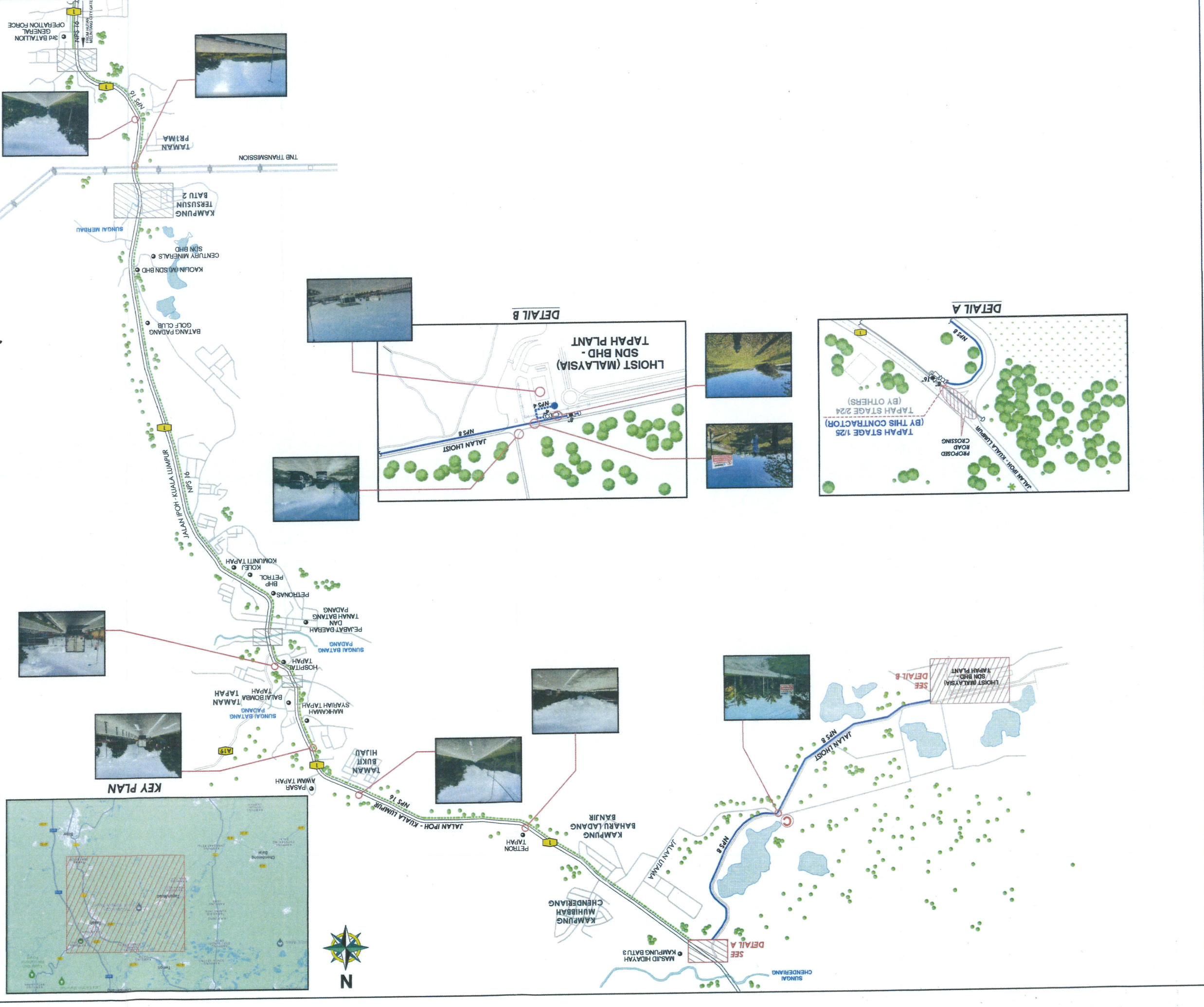

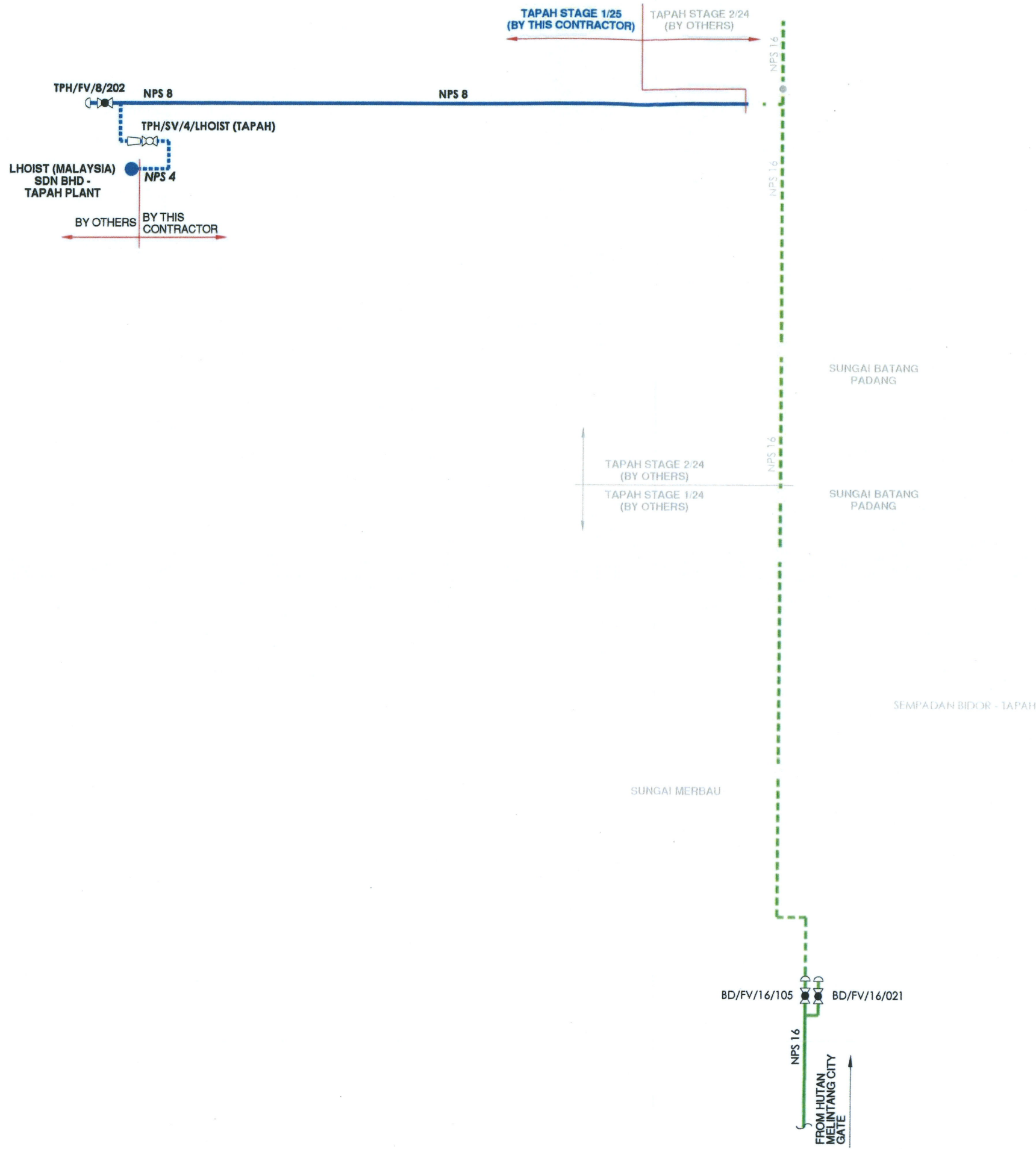

DESIGN DETAILS			
1	PIPELINE SYSTEM	MPA	MPB
2	DESIGN CODE	ASME B31.8	N/A
3	DESIGN PRESSURE/MADP	2483 kPag	N/A
4	OPERATING PRESSURE RANGE	1034~2483 kPag	N/A
5	MIN. SPECIFIED TEST PRESSURE	3724 kPag	N/A
6	MATERIAL	STEEL	PE
7	CLASS LOCATION	4	N/A
8	DESIGN TEMPERATURE	15~55°C	N/A
9	FLOWRATE		

LEGENDS:

- EXISTING FEEDER LINE (MPA)
- UNDER CONSTRUCTION FEEDER LINE (MPA)
- PROPOSED FEEDER LINE (MPA)
- PROPOSED SERVICE LINE (MPA)
- PROPOSED SERVICE STATION (MPA)
- OPEN VALVE
- CLOSE VALVE
- END CAP
- REDUCER

NOTES:

- PROPOSED SERVICE AND BRANCHING OFF VALVES TO BE LOCATED AT THE OUTSIDE OF CUSTOMER BOUNDARY AND TO BE PLACED CLOSEST POSSIBLE TO THE BRANCHING POINT.
- MADP : MAXIMUM ALLOWABLE OPERATING PRESSURE.
- THE INFORMATION IN THE DRAWING IS FOR REFERENCE ONLY. THE CONTRACTOR SHALL VERIFY THE ACCURACY OF THE DRAWING AT SITE.

DISCLAIMER:

GMD DOES NOT GUARANTEE AND MAKES NO REPRESENTATION OR WARRANTY AS TO THE ACCURACY OR SCALE OF THIS PLAN. THIS COMPANY ACCEPT NO LIABILITY FOR ANY LOSS, DAMAGE, OR INJURY SUFFERED BY ANY PERSON AS A RESULT OF ANY INACCURACY IN THIS PLAN.

REFERENCE DRAWING		
NO.	DRAWING TITLE	DRAWING NO.

REVISION						
NO.	DATE	DESCRIPTION	DSGND	DRAWN	CHKD	APPR

OWNER:

GAS MALAYSIA DISTRIBUTION SDN BHD
 NO.5, GROUND FLOOR,
 MALAY SERENDAH 26/17,
 SEREMBAN 2, NEGERI SEMBANG, SELANGOR, MALAYSIA.

A Member of Gas Malaysia Berhad

CONTRACTOR:

ST(JG)
 Ir. Zulkamain Bin Kamaruddin

CERTIFIED BY COMPETENT PERSON:

NAME: *Zulkamain Bin Kamaruddin*
 REG NO: *30*
 DATE: *23/12/25*

PROJECT TITLE:

NATURAL GAS DISTRIBUTION SYSTEM TO
 TAPAH FL STAGE 1/25
 TAPAH
 PERAK DARUL RIDZUAN

DRAWING TITLE:

SCHEMATIC DIAGRAM AND VALVE DESIGNATION

DRAWING NO: GMD/NDS/TAPAH/ST1_25/002D_MSA

APPROVED: <i>[Signature]</i>	DATE: 07/02/2025	HEAD OF NETWORK DEVELOPMENT SECTION
DRAWING NO: GMD/NDS/TAPAH/ST1_25/002D_MSA		CAD: NDS\2025\NRO\LHOIST